

# Socket Screw Catalog

Effective January, 2011







Made in  
the U.S.A.



|  |                                     |
|--|-------------------------------------|
| General Information .....                              | 5                                   |
| Ordering Information .....                             | 6                                   |
| Drive System Selection .....                           | 7                                   |
| <b>Products</b>  | <b>Price List    Technical Data</b> |
| <b>Inch Sizes</b>                                      |                                     |
| Socket Head Cap Screws, 1960 Series .....              | 8.....26                            |
| Socket Head Shoulder Screws .....                      | 11.....29                           |
| 18-8 Stainless Steel Socket Head Shoulder Screws ..... | 12.....29                           |
| Socket Button Head Cap Screws .....                    | 14.....30                           |
| Flanged Button Head Cap Screws.....                    | 15                                  |
| Socket Low Head Cap Screws .....                       | 16.....31                           |
| Socket Flat Countersunk Head Cap Screws .....          | 17.....32                           |
| Socket Set Screws – Cup Point .....                    | 18.....33                           |
| Socket Set Screws – Knurled Cup Point .....            | 19.....33                           |
| Precision Hardened Ground Machine Dowel Pins .....     | 20.....34                           |
| <b>Metric Sizes</b>                                    |                                     |
| Socket Head Cap Screws.....                            | 21.....35                           |
| Socket Button Head Cap Screws .....                    | 22.....36                           |
| Socket Flat Countersunk Head Cap Screws .....          | 23.....37                           |
| <b>Drive Tools</b>                                     |                                     |
| TORX PLUS® Drive System .....                          | 24                                  |
| TORX® Drive System .....                               | 25                                  |
| Warranty.....  | 38                                  |
| Note: Specials Manufactured Upon Request               |                                     |



This Socket Screw Catalog is designed to offer you a guide for utilizing Camcar® brand Socket Screws. We have attempted to provide complete information regarding the Camcar socket screw product line.

## **Camcar Socket Screws**

Infastech takes pride in designing, producing and delivering superior products – an attitude you would expect from the industry’s leading innovator. That pride, combined with the latest fastener technology and engineering expertise, makes Infastech one of the most reliable sources of Socket Screw products in the industry today.

Infastech is committed to offering a broad range of socket screw standard products, including inch and metric sizes in TORX PLUS® Drive and hex drive systems.

Also, we can supply you with innovative socket screw specials or socket screw products for high-temperature or corrosive environments. Any products not shown in this handbook may be considered specials. Please contact the application engineers at Decorah Operations for design assistance or further information.

## **Commitment to Quality**

All Camcar socket screws are made from carefully selected and analyzed raw material, and critically inspected during the manufacturing processes. We utilize both Statistical Process Control and Quality at the Source methods to ensure our socket screws



meet your quality requirements. Each manufacturing lot is assigned an identification number to give you complete traceability of quality in the finished product. Also, many Camcar socket screw products are marked with the “Camcar” name for further assurances of the manufacturing source.

## **Distributors Located Around the World**

The Camcar socket screw product line is readily available through our network of distributors. To find a distributor near you, please contact us at 800-648-0642.



## Ordering Information

For the purposes of electronic data processing, stock numbers are assigned to all items in the Camcar® socket screw product line. These numbers are shown in each price list in this catalog. Infastech maintains a minimum order of \$150.

For price quotations on either stocked items or specials, contact the Decorah Operations Customer Service Department. Lead times from these quotations can be verified at the time of the order. All quotes are subject to review of the complete and clear print.

## Packaged Camcar Socket Screws

As part of our ongoing efforts to improve our socket screw product line, we offer bar coded, safety-sealed packages. This not only ensures the package has not been tampered with, but also provides needed product information in an easy to read format. The information on the label includes lot number for traceability, part description, item number and a bar code for easier receiving.

## Stock numbers

For the purposes of electronic data-processing (EDP), Infastech has assigned stock numbers to all the items in this price list. For inch sizes, hex recess EDP numbers begin with a "1"; TORX PLUS® recess EDP stock numbers begin with a "3".

The NIDA-SIDA manufacturer's code number assigned to Infastech is 697264.

Socket screw products described in this catalog are manufactured from the highest quality alloy and stainless steels in strict conformance with standards and dimensions as set forth in ANSI B 18.3 - 1986; ANSI B 18.8.2 - 1978; MS16555 - 1985; and ANSI B 2.2 - 1968. Camcar socket products meet the respective ASTM Standard Specifications required in ANSI B18.3.

All products in this catalog are DFAR compliant.

## Special products

Products not listed in this schedule are special and will be priced upon request. Blueprints must accompany your request for quotation.

## Special materials

Products manufactured from metals other than indicated in this price schedule are specials and priced on request.

## Product weights

Weight of products listed in this schedule are approximate pounds per box.

## Returned goods

No products accepted for return without written authorization.

## Price quotations

Quotations valid for 30 days from date of issue.

## Plating

Products which are not plated by Infastech are not guaranteed and are not subject to return. Infastech will only plate those thread designations (i.e. 2A) which provide for plating allowance.

## Minimum order charge

Orders will not be accepted for less than \$150.00.

Infastech shall not be responsible or liable for misapplication or misuse of this product. All warranties are void if the product is plated or modified in any manner not under the control of Infastech.



## Decorah Operations

1304 Kerr Drive • Decorah, IA 52101-2494

**voice: 563.382.4216**

**fax: 563.387.3326**

[www.infastech.com](http://www.infastech.com)

**Drive System Availability**

Infastech is committed to offering the marketplace the latest in fastening solutions. As such, many of our most popular socket screw products are available with both the TORX PLUS® Drive System and hex drive system. We also offer the tooling to support whichever drive system you choose.

**Drive System Selection**

There are several issues impacting proper socket screw drive system selection which must be reviewed prior to specification. Among the questions requiring review are:

- Does the drive system’s torque capabilities meet the requirements of my application?
- Will the drive system withstand the high torque levels used in fastening socket screws?
- Is the required tooling readily available?
- Will I need separate tooling for inch and metric screws?
- Will the drive system enhance my overall operations?

In order to answer these questions, it is important to compare the available drive systems.

**Introduction to the TORX PLUS Drive System**

Developed as an improvement of the original TORX® Drive System, the TORX PLUS Drive consistently outperforms hex and other commonly-used drive systems. Used in virtually every industrialized nation in a multitude of industries, the TORX PLUS Drive System can enhance product reliability, increase productivity, and reduce total assembly costs.

The TORX PLUS Drive System offers a 100% improvement in driver bit fatigue life and a 25% average improvement in driver bit torsional strength. In addition, its unique design provides optimum torque transfer and eliminates the need for excessive end load pressure while driving the fastener. The TORX PLUS configuration also virtually eliminates tool camout and slippage that can damage the head of the fastener and cause reduced tool life.



**TORX PLUS Drive System vs. Hex Drive**

The hex drive has weaknesses inherent in its design which can cause problems during assembly. The engagement of the hex drive tool to the recess produces highly concentrated stress at the six corners of the drive tool (see below).

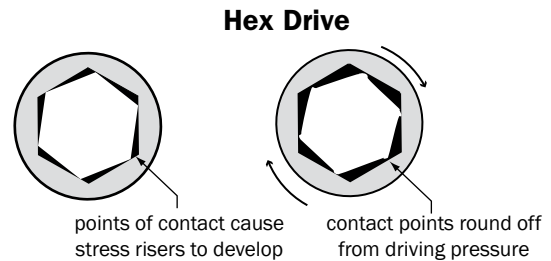

This stress at the thin cross-sectional areas of the fastener crushes the corners of the hex tool. This reduces the amount of wrenching engagement, causing reamed socket recesses and/or damaged socket tooling. This type of failure with the hex drive system is so common, it is often accepted as normal practice.

The TORX PLUS Drive System features deep engaging lobes with broad contact surfaces that spread out driving forces, preventing stress risers from forming. This minimizes damage to the drive tool and fastener, resulting in longer tool life. Customers have reported driving 2 to 10 times more fasteners per drive tool after switching to the TORX PLUS Drive.

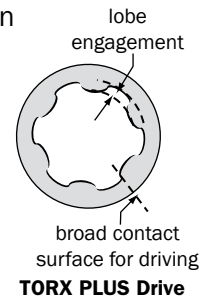

**TORX PLUS Drive Tooling Availability**

TORX PLUS Drive tools are readily available throughout the world from licensed manufacturers and authorized distributors. Your existing tooling suppliers often also carry TORX PLUS Drive tools, in many standard styles and sizes to meet your installation requirements. Infastech also stocks many standard TORX PLUS Drive tools; see page 24 of this catalog for more information.

For service in the field, TORX PLUS Drive fasteners can be removed and reinstalled using commonly available TORX PLUS Drive or TORX Drive tooling. However, in order to fully realize the benefits of the TORX PLUS Drive, including extended bit life, TORX PLUS Drive tools should be used.

# Pricing and Product Information – Inch Sizes



Made in the U.S.A.

## Socket Head Cap Screws – 1960 Series



### Product Description:

- Heat-treated alloy steel
- Class 3A thread fit standard except as noted
- TORX PLUS® Drive recess available
- DFAR Compliant

### Pricing Notes:

- Net price per 100 available in listed thread series only
- Bulk pricing upon request

| Dia.<br>Recess<br>TPI                                 | Len.<br>Und.<br>Head | UNRC              |                            |                     | UNRF              |                            |                     | Ct./<br>Box | Wt./<br>Box |
|---|----------------------|-------------------|----------------------------|---------------------|-------------------|----------------------------|---------------------|-------------|-------------|
|   |                      | Hex<br>EDP<br>No. | TORX<br>PLUS<br>EDP<br>No. | Price<br>Per<br>100 | Hex<br>EDP<br>No. | TORX<br>PLUS<br>EDP<br>No. | Price<br>Per<br>100 |             |             |
| #0<br>.050 Hex<br>UNRF<br>80 TPI                      | 1/8                  |                   |                            |                     | 11035             |                            | 30.67               | 100         | 0.1         |
|   | 3/16                 |                   |                            |                     | 11038             |                            | 30.78               | 100         | 0.1         |
|   | 1/4                  |                   |                            |                     | 11041             |                            | 31.00               | 100         | 0.1         |
|   | 3/8                  |                   |                            |                     | 11044             |                            | 31.21               | 100         | 0.1         |
| #1<br>1/16 Hex<br>UNRF<br>72 TPI                      | 1/8                  |                   |                            |                     | 11047             |                            | 30.78               | 100         | 0.1         |
|   | 3/16                 |                   |                            |                     | 11050             |                            | 31.00               | 100         | 0.1         |
|   | 1/4                  |                   |                            |                     | 11053             |                            | 31.10               | 100         | 0.1         |
|   | 3/8                  |                   |                            |                     | 11056             |                            | 31.54               | 100         | 0.1         |
| #2<br>5/64 Hex<br>UNRC<br>56 TPI                      | 3/16                 | 10003             |                            | 29.70               |                   |                            |                     | 100         | 0.1         |
|   | 1/4                  | 10006             |                            | 29.92               |                   |                            |                     | 100         | 0.1         |
|   | 3/8                  | 10012             |                            | 30.24               |                   |                            |                     | 100         | 0.1         |
|   | 1/2                  | 10015             |                            | 30.46               |                   |                            |                     | 100         | 0.2         |
| #3<br>5/64 Hex<br>UNRC<br>48 TPI                      | 3/16                 | 10024             |                            | 29.59               |                   |                            |                     | 100         | 0.1         |
|   | 1/4                  | 10027             |                            | 30.24               |                   |                            |                     | 100         | 0.1         |
|   | 3/8                  | 10030             |                            | 31.00               |                   |                            |                     | 100         | 0.1         |
|   | 1/2                  | 10033             |                            | 31.32               |                   |                            |                     | 100         | 0.2         |
| #4<br>3/32 Hex<br>10IP<br>TORX PLUS<br>UNRC<br>40 TPI | 3/16                 | 10040             |                            | 16.01               |                   |                            |                     | 100         | 0.2         |
|   | 1/4                  | 10042             | 30042                      | 15.26               |                   |                            |                     | 100         | 0.2         |
|   | 5/16                 | 10043             |                            | 15.48               |                   |                            |                     | 100         | 0.2         |
|   | 3/8                  | 10048             | 30048                      | 15.58               |                   |                            |                     | 100         | 0.2         |
|   | 1/2                  | 10054             | 30054                      | 15.90               |                   |                            |                     | 100         | 0.3         |
|   | 5/8                  | 10057             | 30057                      | 16.01               |                   |                            |                     | 100         | 0.3         |
|   | 3/4                  | 10060             | 30060                      | 16.43               |                   |                            |                     | 100         | 0.3         |
|   | 7/8                  | 10061             |                            | 19.08               |                   |                            |                     | 100         | 0.3         |
|   | 1                    | 10062             |                            | 19.82               |                   |                            |                     | 100         | 0.3         |
|   | 1-1/4                | 10065             |                            | 36.15               |                   |                            |                     | 100         | 0.4         |
| #5<br>3/32 Hex<br>10IP<br>TORX PLUS<br>UNRC<br>40 TPI | 1-1/2                | 10068             |                            | 40.07               |                   |                            |                     | 100         | 0.5         |
|   | 1/4                  | 10078             | 30078                      | 15.37               |                   |                            |                     | 100         | 0.2         |
|   | 3/8                  | 10084             | 30084                      | 15.48               |                   |                            |                     | 100         | 0.3         |
|   | 1/2                  | 10090             | 30090                      | 16.11               |                   |                            |                     | 100         | 0.3         |
|   | 5/8                  | 10093             |                            | 16.22               |                   |                            |                     | 100         | 0.3         |
|   | 3/4                  | 10096             |                            | 16.54               |                   |                            |                     | 100         | 0.4         |
| 1   | 10099                |                   | 25.86                      |                     |                   |                            | 100                 | 0.5         |             |

| Dia.<br>Recess<br>TPI  | Len.<br>Und.<br>Head | UNRC              |                            |                     | UNRF              |                            |                     | Ct./<br>Box | Wt./<br>Box |
|--|----------------------|-------------------|----------------------------|---------------------|-------------------|----------------------------|---------------------|-------------|-------------|
|  |                      | Hex<br>EDP<br>No. | TORX<br>PLUS<br>EDP<br>No. | Price<br>Per<br>100 | Hex<br>EDP<br>No. | TORX<br>PLUS<br>EDP<br>No. | Price<br>Per<br>100 |             |             |
| #6<br>7/64 Hex<br>15IP<br>TORX PLUS<br>UNRC<br>32 TPI<br>UNRF<br>40 TPI  | 1/4                  | 10108             | 30108                      | 15.48               | 11062             |                            | 17.92               | 100         | 0.3         |
|  | 3/8                  | 10114             | 30114                      | 15.69               | 11068             |                            | 18.13               | 100         | 0.3         |
|  | 1/2                  | 10120             | 30120                      | 15.90               | 11074             |                            | 18.44               | 100         | 0.4         |
|  | 5/8                  | 10123             | 30123                      | 15.90               | 11077             |                            | 18.44               | 100         | 0.4         |
|  | 3/4                  | 10126             | 30126                      | 16.96               | 11080             |                            | 18.44               | 100         | 0.4         |
|  | 7/8                  | 10129             | 30129                      | 18.66               |                   |                            |                     | 100         | 0.4         |
|  | 1                    | 10132             | 30132                      | 20.56               |                   |                            |                     | 100         | 0.5         |
|  | 1-1/4                | 10133             |                            | 23.74               |                   |                            |                     | 100         | 0.6         |
|  | 1-1/2                | 10136             |                            | 25.97               |                   |                            |                     | 100         | 0.6         |
|  | 1-3/4                | 10139             |                            | 27.56               |                   |                            |                     | 100         | 0.8         |
| 2  | 10141                |                   | 29.47                      |                     |                   |                            | 100                 | 1.2         |             |
| #8<br>9/64 Hex<br>25IP<br>TORX PLUS<br>UNRC<br>32 TPI<br>UNRF<br>36 TPI  | 1/4                  | 10156             | 30156                      | 15.16               |                   |                            |                     | 100         | 0.4         |
|  | 5/16                 | 10165             |                            | 15.37               |                   |                            |                     | 100         | 0.5         |
|  | 3/8                  | 10162             | 30162                      | 15.58               | 11089             |                            | 23.32               | 100         | 0.5         |
|  | 1/2                  | 10168             | 30168                      | 16.01               | 11092             |                            | 23.74               | 100         | 0.5         |
|  | 5/8                  | 10174             | 30174                      | 16.11               |                   |                            |                     | 100         | 0.6         |
|  | 3/4                  | 10177             | 30177                      | 17.81               | 11095             |                            | 26.82               | 100         | 0.7         |
|  | 7/8                  | 10180             | 30180                      | 18.66               |                   |                            |                     | 100         | 0.7         |
|  | 1                    | 10186             | 30186                      | 20.88               |                   |                            |                     | 100         | 0.8         |
|  | 1-1/4                | 10192             | 30192                      | 22.90               |                   |                            |                     | 100         | 0.9         |
|  | 1-1/2                | 10198             | 30198                      | 24.80               |                   |                            |                     | 100         | 1.1         |
| 2  | 10201                |                   | 30.74                      |                     |                   |                            | 100                 | 1.5         |             |
| 2-1/2  | 10208                |                   | 34.24                      |                     |                   |                            | 100                 | 1.5         |             |
| #10<br>5/32 Hex<br>27IP<br>TORX PLUS<br>UNRC<br>24 TPI<br>UNRF<br>28 TPI | 1/4                  | 10210             |                            | 21.09               | 11105             |                            | 20.99               | 100         | 0.6         |
|  | 3/8                  | 10216             |                            | 15.69               | 11107             | 31107                      | 16.01               | 100         | 0.6         |
|  | 1/2                  | 10219             | 30219                      | 16.01               | 11113             | 31113                      | 16.22               | 100         | 0.7         |
|  | 5/8                  | 10225             | 30225                      | 16.54               | 11119             | 31119                      | 17.38               | 100         | 0.8         |
|  | 3/4                  | 10228             | 30228                      | 17.70               | 11122             | 31122                      | 18.13               | 100         | 0.9         |
|  | 7/8                  | 10231             | 30231                      | 19.19               | 11125             | 31125                      | 20.78               | 100         | 0.9         |
|  | 1                    | 10234             | 30234                      | 20.88               | 11128             | 31128                      | 21.31               | 100         | 1.0         |
|  | 1-1/4                | 10240             | 30240                      | 22.68               | 11134             | 31134                      | 23.75               | 100         | 1.3         |
|  | 1-1/2                | 10246             | 30246                      | 25.33               | 11137             | 31137                      | 26.61               | 100         | 1.4         |
|  | 1-3/4                | 10249             |                            | 27.88               | 11140             | 31140                      | 29.04               | 100         | 1.6         |
| 2  | 10255                |                   | 30.21                      | 11143               | 31143             | 32.33                      | 100                 | 1.9         |             |
| 2-1/4  | 10258                |                   | 32.86                      | 11145               |                   | 35.62                      | 100                 | 2.0         |             |
| 2-1/2  | 10260                |                   | 32.65                      | 11147               |                   | 38.16                      | 100                 | 2.0         |             |
| 3  | 10262                |                   | 45.47                      | 11150               |                   | 50.37                      | 100                 | 3.0         |             |

# Pricing and Product Information – Inch Sizes



Made in the U.S.A.

## Socket Head Cap Screws – 1960 Series (continued)

| Dia.<br>Recess<br>TPI   | Len.<br>Und.<br>Head | UNRC              |                            |                     | UNRF              |                            |                     | Ct./<br>Box | Wt./<br>Box |
|---|----------------------|-------------------|----------------------------|---------------------|-------------------|----------------------------|---------------------|-------------|-------------|
|   |                      | Hex<br>EDP<br>No. | TORX<br>PLUS<br>EDP<br>No. | Price<br>Per<br>100 | Hex<br>EDP<br>No. | TORX<br>PLUS<br>EDP<br>No. | Price<br>Per<br>100 |             |             |
| 1/4"<br>3/16 Hex<br>30IP<br>TORX PLUS<br>UNRC<br>20 TPI<br>UNRF<br>28 TPI | 1/4                  | 10265             |                            | 20.14               |                   |                            |                     | 100         | 1.0         |
|   | 3/8                  | 10267             | 30267                      | 16.54               | 11161             | 31161                      | 18.55               | 100         | 1.0         |
|   | 1/2                  | 10270             | 30270                      | 16.96               | 11164             | 31164                      | 18.97               | 100         | 1.2         |
|   | 5/8                  | 10273             | 30273                      | 17.60               | 11170             | 31170                      | 19.29               | 100         | 1.4         |
|   | 3/4                  | 10276             | 30276                      | 19.08               | 11176             | 31176                      | 20.88               | 100         | 1.5         |
|   | 7/8                  | 10279             | 30279                      | 20.56               | 11179             |                            | 23.11               | 100         | 1.6         |
|   | 1                    | 10282             | 30282                      | 21.84               | 11182             | 31182                      | 24.49               | 100         | 1.8         |
|   | 1-1/4                | 10291             | 30291                      | 23.43               | 11188             | 31188                      | 26.92               | 100         | 2.1         |
|   | 1-1/2                | 10294             | 30294                      | 26.50               | 11191             | 31191                      | 29.79               | 100         | 2.5         |
|   | 1-3/4                | 10300             | 30300                      | 28.99               | 11194             | 31194                      | 32.86               | 100         | 2.8         |
|   | 2                    | 10306             | 30306                      | 31.38               | 11200             | 31200                      | 35.93               | 100         | 3.0         |
|   | 2-1/4                | 10309             | 30309                      | 39.22               | 11203             |                            | 44.10               | 100         | 3.4         |
|   | 2-1/2                | 10312             | 30312                      | 43.57               |                   |                            |                     | 100         | 3.8         |
|   | 2-3/4                | 10315             | 30315                      | 52.68               |                   |                            |                     | 100         | 3.9         |
|   | 3                    | 10318             | 30318                      | 58.30               |                   |                            |                     | 100         | 4.3         |
|   | 3-1/4                | 10319             |                            | 62.12               |                   |                            |                     | 100         | 5.0         |
|   | 3-1/2                | 10320             |                            | 73.25               |                   |                            |                     | 100         | 5.0         |
|   | 4                    | 10322             |                            | 97.10               |                   |                            |                     | 100         | 5.0         |
| 5/16"<br>1/4 Hex<br>45IP<br>TORX PLUS<br>UNRC<br>18 TPI<br>UNRF<br>24 TPI | 3/8                  | 10348             | 30348                      | 27.98               |                   |                            |                     | 100         | 1.8         |
|   | 1/2                  | 10351             | 30351                      | 21.62               | 11221             |                            | 23.11               | 100         | 2.0         |
|   | 5/8                  | 10354             | 30354                      | 22.58               | 11224             |                            | 24.17               | 100         | 2.3         |
|   | 3/4                  | 10357             | 30357                      | 23.32               | 11227             | 31227                      | 25.76               | 100         | 2.5         |
|   | 7/8                  | 10360             | 30360                      | 25.55               | 11230             | 31230                      | 28.41               | 100         | 2.7         |
|   | 1                    | 10363             | 30363                      | 26.18               | 11233             | 31233                      | 28.94               | 100         | 2.9         |
|   | 1-1/4                | 10369             | 30369                      | 29.36               | 11239             | 31239                      | 30.63               | 100         | 3.4         |
|   | 1-1/2                | 10372             | 30372                      | 31.16               | 11242             | 31242                      | 34.24               | 100         | 3.9         |
|   | 1-3/4                | 10375             | 30375                      | 34.98               | 11248             |                            | 37.74               | 100         | 4.4         |
|   | 2                    | 10381             | 30381                      | 37.74               | 11254             |                            | 41.55               | 100         | 4.9         |
|   | 2-1/4                | 10387             | 30387                      | 46.64               | 11257             |                            | 49.18               | 100         | 5.4         |
|   | 2-1/2                | 10393             | 30393                      | 50.99               | 11260             |                            | 57.03               | 100         | 5.9         |
|   | 2-3/4                | 10396             | 30396                      | 69.43               |                   |                            |                     | 100         | 6.4         |
|   | 3                    | 10399             | 30399                      | 79.92               |                   |                            |                     | 100         | 6.9         |
|   | 3-1/4                | 10402             | 30402                      | 99.64               |                   |                            |                     | 100         | 7.3         |
|   | 3-1/2                | 10405             | 30405                      | 109.82              |                   |                            |                     | 100         | 7.8         |
|   | 4                    | 10410             | 30410                      | 115.33              |                   |                            |                     | 100         | 9.0         |
|   | 4-1/2                | 10413             | 30413                      | 129.53              |                   |                            |                     | 100         | 10.5        |
| 5   | 10416                | 30416             | 182.43                     |                     |                   |                            | 100                 | 11.6        |             |

| Dia.<br>Recess<br>TPI   | Len.<br>Und.<br>Head | UNRC              |                            |                     | UNRF              |                            |                     | Ct./<br>Box | Wt./<br>Box |
|---|----------------------|-------------------|----------------------------|---------------------|-------------------|----------------------------|---------------------|-------------|-------------|
|   |                      | Hex<br>EDP<br>No. | TORX<br>PLUS<br>EDP<br>No. | Price<br>Per<br>100 | Hex<br>EDP<br>No. | TORX<br>PLUS<br>EDP<br>No. | Price<br>Per<br>100 |             |             |
| 3/8"<br>5/16 Hex<br>50IP<br>TORX PLUS<br>UNRC<br>16 TPI<br>UNRF<br>24 TPI | 1/2                  | 10435             | 30435                      | 26.61               | 11275             |                            | 37.95               | 100         | 3.4         |
|   | 5/8                  | 10438             | 30438                      | 27.45               | 11278             |                            | 38.58               | 100         | 3.4         |
|   | 3/4                  | 10441             | 30441                      | 28.09               | 11281             | 31281                      | 33.07               | 100         | 4.0         |
|   | 7/8                  | 10444             | 30444                      | 30.74               | 11284             |                            | 36.04               | 100         | 4.3         |
|   | 1                    | 10447             | 30447                      | 31.80               | 11287             | 31287                      | 36.68               | 100         | 4.6         |
|   | 1-1/4                | 10450             | 30450                      | 34.24               | 11290             | 31290                      | 39.64               | 100         | 5.2         |
|   | 1-1/2                | 10456             | 30456                      | 37.74               | 11293             | 31293                      | 43.35               | 100         | 6.0         |
|   | 1-3/4                | 10459             | 30459                      | 43.04               | 11296             | 31296                      | 49.71               | 50          | 3.3         |
|   | 2                    | 10462             | 30462                      | 46.43               | 11299             | 31299                      | 54.59               | 50          | 3.9         |
|   | 2-1/4                | 10465             | 30465                      | 58.09               | 11302             |                            | 69.75               | 50          | 4.3         |
|   | 2-1/2                | 10468             | 30468                      | 63.18               | 11305             |                            | 76.32               | 50          | 4.5         |
|   | 2-3/4                | 10471             | 30471                      | 86.18               |                   |                            |                     | 50          | 4.9         |
|   | 3                    | 10474             | 30474                      | 94.13               | 11308             |                            | 103.46              | 50          | 5.1         |
|   | 3-1/4                | 10477             | 30477                      | 112.78              |                   |                            |                     | 50          | 5.4         |
|   | 3-1/2                | 10483             | 30483                      | 128.37              |                   |                            |                     | 50          | 5.8         |
|   | 4                    | 10489             | 30489                      | 151.58              |                   |                            |                     | 50          | 6.6         |
|   | 4-1/2                | 10495             |                            | 181.58              |                   |                            |                     | 50          | 7.4         |
|   | 5                    | 10501             |                            | 217.09              |                   |                            |                     | 50          | 8.0         |
| 6   | 10510                |                   | 303.58                     |                     |                   |                            | 10                  | 13.0        |             |
| 7/16"<br>3/8 Hex<br>55IP<br>TORX PLUS<br>UNRC<br>14 TPI<br>UNRF<br>20 TPI | 1/2                  | 10517             |                            | 57.56               |                   |                            |                     | 100         | 5.0         |
|   | 5/8                  | 10518             |                            | 58.41               |                   |                            |                     | 100         | 6.0         |
|   | 3/4                  | 10519             |                            | 59.78               |                   |                            |                     | 100         | 6.5         |
|   | 7/8                  | 10521             |                            | 64.02               |                   |                            |                     | 100         | 6.8         |
|   | 1                    | 10525             | 30525                      | 65.72               | 11326             |                            | 72.40               | 100         | 7.0         |
|   | 1-1/4                | 10528             | 30528                      | 71.13               | 11329             |                            | 77.49               | 100         | 7.3         |
|   | 1-1/2                | 10531             | 30531                      | 78.02               | 11332             |                            | 87.24               | 100         | 8.1         |
|   | 1-3/4                | 10537             |                            | 86.18               |                   |                            |                     | 100         | 9.3         |
|   | 2                    | 10540             | 30540                      | 93.07               | 11338             | 31338                      | 101.87              | 50          | 5.0         |
|   | 2-1/4                | 10543             | 30543                      | 103.14              |                   |                            |                     | 50          | 5.5         |
|   | 2-1/2                | 10546             |                            | 109.18              |                   |                            |                     | 50          | 6.0         |
|   | 2-3/4                | 10549             |                            | 125.82              |                   |                            |                     | 25          | 3.3         |
| 3   | 10552                |                   | 135.68                     |                     |                   |                            | 25                  | 3.5         |             |
| 3-1/2   | 10558                |                   | 156.99                     |                     |                   |                            | 25                  | 4.0         |             |
| 4   | 10564                |                   | 174.16                     |                     |                   |                            | 25                  | 4.5         |             |

# Pricing and Product Information – Inch Sizes



Made in  
the U.S.A.

| Dia.<br>Recess<br>TPI  | Len.<br>Und.<br>Head | UNRC              |                            |                     | UNRF              |                            |                     | Ct./<br>Box | Wt./<br>Box |
|--|----------------------|-------------------|----------------------------|---------------------|-------------------|----------------------------|---------------------|-------------|-------------|
|  |                      | Hex<br>EDP<br>No. | TORX<br>PLUS<br>EDP<br>No. | Price<br>Per<br>100 | Hex<br>EDP<br>No. | TORX<br>PLUS<br>EDP<br>No. | Price<br>Per<br>100 |             |             |
| 1/2"<br>3/8 Hex<br>55IP<br>TORX PLUS<br>UNRC<br>13 TPI<br>UNRF<br>20 TPI | 1/2                  | 10573             | 30573                      | 79.29               |                   |                            |                     | 50          | 3.7         |
|  | 5/8                  | 10576             | 30576                      | 83.00               |                   |                            |                     | 50          | 4.0         |
|  | 3/4                  | 10579             | 30579                      | 66.14               |                   |                            |                     | 50          | 4.2         |
|  | 7/8                  | 10582             |                            | 73.46               |                   |                            |                     | 50          | 4.5         |
|  | 1                    | 10585             | 30585                      | 73.99               | 11356             |                            | 75.58               | 50          | 4.8         |
|  | 1-1/4                | 10588             | 30588                      | 76.74               | 11359             |                            | 85.97               | 50          | 5.3         |
|  | 1-1/2                | 10591             | 30591                      | 86.92               | 11362             |                            | 92.54               | 25          | 6.3         |
|  | 1-3/4                | 10594             | 30594                      | 96.25               | 11365             |                            | 101.87              | 25          | 3.4         |
|  | 2                    | 10597             | 30597                      | 102.18              | 11368             |                            | 109.29              | 25          | 3.8         |
|  | 2-1/4                | 10600             | 30600                      | 116.07              | 11371             |                            | 122.22              | 25          | 4.0         |
|  | 2-1/2                | 10606             | 30606                      | 124.13              | 11374             |                            | 128.58              | 25          | 4.4         |
|  | 2-3/4                | 10609             | 30609                      | 142.89              |                   |                            |                     | 25          | 4.6         |
|  | 3                    | 10612             | 30612                      | 151.69              | 11377             |                            | 164.62              | 25          | 4.9         |
|  | 3-1/4                | 10618             | 30618                      | 165.78              |                   |                            |                     | 25          | 5.1         |
|  | 3-1/2                | 10621             | 30621                      | 175.75              |                   |                            |                     | 25          | 6.0         |
|  | 4                    | 10627             | 30627                      | 211.36              |                   |                            |                     | 25          | 6.3         |
|  | 4-1/2                | 10633             |                            | 247.83              |                   |                            |                     | 25          | 7.0         |
|  | 5                    | 10639             |                            | 274.96              |                   |                            |                     | 25          | 7.9         |
|  | 5-1/2                | 10645             |                            | 305.39              |                   |                            |                     | 25          | 8.6         |
|  | 6                    | 10654             |                            | 325.95              |                   |                            |                     | 25          | 9.3         |
| 6-1/2  | 10657                |                   | 508.06                     |                     |                   |                            | 10                  | 3.8         |             |
| 7  | 10660                |                   | 579.29                     |                     |                   |                            | 10                  | 4.2         |             |
| 8  | 10663                |                   | 722.71                     |                     |                   |                            | 10                  | 5.0         |             |
| 5/8"<br>1/2 Hex<br>70IP<br>TORX PLUS<br>UNRC<br>11 TPI<br>UNRF<br>18 TPI | 1-1/4                | 10672             |                            | 157.03              | 11404             |                            | 159.73              | 50          | 8.6         |
|  | 1-1/2                | 10678             |                            | 168.59              | 11407             |                            | 171.29              | 50          | 9.4         |
|  | 1-3/4                | 10681             |                            | 179.71              | 11410             |                            | 185.44              | 50          | 10.5        |
|  | 2                    | 10684             |                            | 190.99              | 11413             |                            | 196.88              | 50          | 11.2        |
|  | 2-1/4                | 10687             |                            | 204.98              |                   |                            |                     | 25          | 6.8         |
|  | 2-1/2                | 10690             |                            | 213.08              | 11419             |                            | 190.84              | 25          | 7.3         |
|  | 3                    | 10696             |                            | 250.56              |                   |                            |                     | 25          | 8.4         |
|  | 3-1/2                | 10702             |                            | 275.29              |                   |                            |                     | 25          | 9.5         |
|  | 4                    | 10705             |                            | 304.88              |                   |                            |                     | 25          | 10.5        |
|  | 4-1/2                | 10711             |                            | 408.00              |                   |                            |                     | 25          | 11.4        |
| 5  | 10714                |                   | 455.20                     |                     |                   |                            | 25                  | 12.4        |             |
| 5-1/2  | 10717                |                   | 584.20                     |                     |                   |                            | 10                  | 5.3         |             |

| Dia.<br>Recess<br>TPI             | Len.<br>Und.<br>Head           | UNRC              |                            |                     | UNRF              |                            |                     | Ct./<br>Box | Wt./<br>Box |
|-----------------------------------|--------------------------------|-------------------|----------------------------|---------------------|-------------------|----------------------------|---------------------|-------------|-------------|
|                                   |                                | Hex<br>EDP<br>No. | TORX<br>PLUS<br>EDP<br>No. | Price<br>Per<br>100 | Hex<br>EDP<br>No. | TORX<br>PLUS<br>EDP<br>No. | Price<br>Per<br>100 |             |             |
| 3/4"<br>5/8 Hex<br>UNRC<br>10 TPI | 1-1/2                          | 10747             |                            | 298.43              |                   |                            |                     | 25          | 7.6         |
|                                   | 1-3/4                          | 10750             |                            | 318.56              |                   |                            |                     | 25          | 8.4         |
|                                   | 2                              | 10753             |                            | 334.95              |                   |                            |                     | 25          | 9.1         |
|                                   | 2-1/4                          | 10756             |                            | 350.68              |                   |                            |                     | 25          | 9.9         |
|                                   | 2-1/2                          | 10759             |                            | 366.63              |                   |                            |                     | 25          | 10.6        |
|                                   | 3                              | 10765             |                            | 460.79              |                   |                            |                     | 25          | 12.3        |
|                                   | 3-1/4                          | 10768             |                            | 483.10              |                   |                            |                     | 25          | 13.0        |
|                                   | 3-1/2                          | 10771             |                            | 488.90              |                   |                            |                     | 25          | 13.8        |
|                                   | 4                              | 10774             |                            | 521.60              |                   |                            |                     | 25          | 15.4        |
|                                   | 4-1/2                          | 10777             |                            | 608.80              |                   |                            |                     | 25          | 17.0        |
|                                   | 5                              | 10783             |                            | 678.90              |                   |                            |                     | 25          | 25.0        |
|                                   | 5-1/2                          | 10789             |                            | 788.40              |                   |                            |                     | 10          | 7.8         |
|                                   | 6                              | 10804             |                            | 867.10              |                   |                            |                     | 10          | 8.5         |
|                                   | 1"<br>1/2 Hex<br>UNRC<br>8 TPI | 2                 | 10873                      |                     | 813.90            |                            |                     |             | 10          |
| 2-1/4                             |                                | 10876             |                            | 876.60              |                   |                            |                     | 10          | 8.3         |
| 2-1/2                             |                                | 10879             |                            | 920.40              |                   |                            |                     | 10          | 8.8         |
| 2-3/4                             |                                | 10882             |                            | 964.20              |                   |                            |                     | 10          | 9.3         |
| 3                                 |                                | 10885             |                            | 1014.30             |                   |                            |                     | 10          | 9.8         |
| 3-1/4                             |                                | 10888             |                            | 1070.70             |                   |                            |                     | 10          | 10.3        |
| 3-1/2                             |                                | 10891             |                            | 1127.50             |                   |                            |                     | 10          | 10.8        |
| 4                                 |                                | 10897             |                            | 1252.20             |                   |                            |                     | 10          | 12.1        |
| 4-1/2                             |                                | 10903             |                            | 1502.70             |                   |                            |                     | 10          | 13.3        |
| 5                                 |                                | 10906             |                            | 1646.70             |                   |                            |                     | 10          | 14.5        |
| 5-1/2                             |                                | 10909             |                            | 1853.30             |                   |                            |                     | 10          | 15.6        |
| 6                                 |                                | 10930             |                            | 1953.40             |                   |                            |                     | 10          | 16.7        |
| 6-1/2                             |                                | 10933             |                            | 2404.30             |                   |                            |                     | 10          | 17.6        |
| 7                                 |                                | 10936             |                            | 2567.00             |                   |                            |                     | 10          | 19.6        |
| 8                                 | 10939                          |                   | 3080.40                    |                     |                   |                            | 10                  | 21.4        |             |

# Pricing and Product Information – Inch Sizes



Made in the U.S.A.

## Camcar® Socket Head Shoulder Screws



### Product Description:

- Heat-treated alloy steel
- Class 3A thread fit standard
- DFAR compliant

### Pricing Notes:

- Net price per 100
- Bulk pricing upon request

| Shldr . Dia.<br>Recess Size | Shldr.<br>Length | EDP<br>No. | Thrd.<br>Dia. | TPI    | Price Per<br>100 | Ct. /<br>Box | Wt. Lb./<br>Box |
|-----------------------------|------------------|------------|---------------|--------|------------------|--------------|-----------------|
| 1/4"<br>1/8 Hex             | 1/4              | 13755      | #10           | 24     | 120.10           | 25           | .4              |
|                             | 3/8              | 13759      | #10           | 24     | 105.05           | 25           | .4              |
|                             | 1/2              | 13762      | #10           | 24     | 106.11           | 25           | .4              |
|                             | 5/8              | 13765      | #10           | 24     | 110.24           | 25           | .4              |
|                             | 3/4              | 13768      | #10           | 24     | 113.53           | 25           | .5              |
|                             | 1                | 13771      | #10           | 24     | 118.40           | 25           | .6              |
|                             | 1-1/4            | 13774      | #10           | 24     | 128.37           | 25           | .6              |
|                             | 1-1/2            | 13777      | #10           | 24     | 133.35           | 25           | .8              |
|                             | 2                | 13780      | #10           | 24     | 158.89           | 25           | 1.2             |
| 5/16"<br>5/32 Hex           | 1/4              | 13793      | 1/4           | 20     | 147.76           | 25           | .4              |
|                             | 3/8              | 13795      | 1/4           | 20     | 124.44           | 25           | .4              |
|                             | 1/2              | 13798      | 1/4           | 20     | 125.72           | 25           | .4              |
|                             | 5/8              | 13801      | 1/4           | 20     | 128.05           | 25           | .7              |
|                             | 3/4              | 13804      | 1/4           | 20     | 130.59           | 25           | .8              |
|                             | 1                | 13810      | 1/4           | 20     | 133.77           | 25           | .9              |
|                             | 1-1/4            | 13813      | 1/4           | 20     | 147.13           | 25           | 1.0             |
|                             | 1-1/2            | 13816      | 1/4           | 20     | 152.32           | 25           | 1.1             |
|                             | 1-3/4            | 13819      | 1/4           | 20     | 160.70           | 25           | 1.3             |
|                             | 2                | 13822      | 1/4           | 20     | 162.07           | 25           | 1.4             |
| 3/8"<br>3/16 Hex            | 1/4              | 13834      | 5/16          | 18     | 186.14           | 25           | .8              |
|                             | 3/8              | 13837      | 5/16          | 18     | 141.72           | 25           | .9              |
|                             | 1/2              | 13840      | 5/16          | 18     | 143.63           | 25           | 1.0             |
|                             | 5/8              | 13843      | 5/16          | 18     | 144.90           | 25           | 1.1             |
|                             | 3/4              | 13846      | 5/16          | 18     | 147.55           | 25           | 1.3             |
|                             | 1                | 13849      | 5/16          | 18     | 148.61           | 25           | 1.4             |
|                             | 1-1/4            | 13852      | 5/16          | 18     | 157.73           | 25           | 1.6             |
|                             | 1-1/2            | 13855      | 5/16          | 18     | 162.18           | 25           | 1.9             |
|                             | 1-3/4            | 13858      | 5/16          | 18     | 166.84           | 25           | 2.1             |
|                             | 2                | 13861      | 5/16          | 18     | 179.35           | 25           | 2.3             |
|                             | 2-1/4            | 13864      | 5/16          | 18     | 188.79           | 25           | 2.4             |
|                             | 2-1/2            | 13867      | 5/16          | 18     | 208.08           | 25           | 2.6             |
|                             | 2-3/4            | 13870      | 5/16          | 18     | 219.95           | 25           | 2.9             |
|                             | 3                | 13873      | 5/16          | 18     | 231.61           | 25           | 3.1             |
|                             | 3-1/4            | 13876      | 5/16          | 18     | 263.52           | 25           | 3.3             |
|                             | 3-1/2            | 13879      | 5/16          | 18     | 286.31           | 25           | 3.5             |
| 3-3/4                       | 13882            | 5/16       | 18            | 326.90 | 25               | 3.6          |                 |
| 4                           | 13885            | 5/16       | 18            | 332.63 | 25               | 3.9          |                 |
| 1/2"<br>1/4 Hex             | 3/8              | 13889      | 3/8           | 16     | 269.45           | 25           | 1.8             |
|                             | 1/2              | 13891      | 3/8           | 16     | 229.07           | 25           | 2.0             |
|                             | 5/8              | 13894      | 3/8           | 16     | 239.35           | 25           | 2.3             |
|                             | 3/4              | 13897      | 3/8           | 16     | 240.62           | 25           | 2.4             |
|                             | 1                | 13900      | 3/8           | 16     | 241.89           | 25           | 2.8             |
|                             | 1-1/4            | 13903      | 3/8           | 16     | 248.15           | 25           | 3.1             |
|                             | 1-1/2            | 13906      | 3/8           | 16     | 253.66           | 25           | 3.4             |
|                             | 1-3/4            | 13909      | 3/8           | 16     | 268.18           | 25           | 3.8             |
|                             | 2                | 13912      | 3/8           | 16     | 281.32           | 25           | 4.1             |
|                             | 2-1/4            | 13915      | 3/8           | 16     | 295.00           | 25           | 4.5             |
|                             | 2-1/2            | 13918      | 3/8           | 16     | 304.64           | 25           | 4.9             |

| Shldr . Dia.<br>Recess Size | Shldr.<br>Length | EDP<br>No. | Thrd.<br>Dia. | TPI     | Price Per<br>100 | Ct. /<br>Box | Wt. Lb./<br>Box |
|-----------------------------|------------------|------------|---------------|---------|------------------|--------------|-----------------|
| 1/2"<br>cont.               | 2-3/4            | 13921      | 3/8           | 16      | 322.77           | 25           | 5.2             |
|                             | 3                | 13924      | 3/8           | 16      | 342.06           | 25           | 5.5             |
|                             | 3-1/4            | 13927      | 3/8           | 16      | 380.12           | 25           | 5.9             |
|                             | 3-1/2            | 13930      | 3/8           | 16      | 407.57           | 25           | 6.2             |
|                             | 3-3/4            | 13933      | 3/8           | 16      | 456.65           | 25           | 6.5             |
|                             | 4                | 13936      | 3/8           | 16      | 467.99           | 25           | 6.9             |
|                             | 4-1/4            | 13939      | 3/8           | 16      | 553.53           | 25           | 7.2             |
|                             | 4-1/2            | 13942      | 3/8           | 16      | 563.07           | 10           | 3.0             |
|                             | 4-3/4            | 13945      | 3/8           | 16      | 618.09           | 10           | 3.2             |
|                             | 5                | 13948      | 3/8           | 16      | 635.05           | 10           | 3.4             |
| 5/8"<br>5/16 Hex            | 3/4              | 13956      | 1/2           | 13      | 459.57           | 25           | 4.5             |
|                             | 1                | 13958      | 1/2           | 13      | 540.99           | 25           | 4.8             |
|                             | 1-1/4            | 13960      | 1/2           | 13      | 390.76           | 25           | 5.1             |
|                             | 1-1/2            | 13963      | 1/2           | 13      | 413.56           | 25           | 5.6             |
|                             | 1-3/4            | 13966      | 1/2           | 13      | 423.83           | 25           | 6.2             |
|                             | 2                | 13969      | 1/2           | 13      | 439.24           | 25           | 6.6             |
|                             | 2-1/4            | 13972      | 1/2           | 13      | 486.32           | 25           | 7.2             |
|                             | 2-1/2            | 13975      | 1/2           | 13      | 520.13           | 25           | 7.8             |
|                             | 2-3/4            | 13978      | 1/2           | 13      | 541.31           | 25           | 8.4             |
|                             | 3                | 13981      | 1/2           | 13      | 543.99           | 25           | 8.9             |
|                             | 3-1/4            | 13984      | 1/2           | 13      | 696.68           | 25           | 9.4             |
|                             | 3-1/2            | 13987      | 1/2           | 13      | 779.17           | 25           | 9.9             |
|                             | 3-3/4            | 13990      | 1/2           | 13      | 882.22           | 10           | 4.2             |
|                             | 4                | 13993      | 1/2           | 13      | 922.55           | 10           | 4.4             |
|                             | 4-1/4            | 13996      | 1/2           | 13      | 1036.72          | 10           | 4.6             |
|                             | 4-1/2            | 13999      | 1/2           | 13      | 1062.83          | 10           | 4.9             |
| 4-3/4                       | 14002            | 1/2        | 13            | 1139.76 | 10               | 5.1          |                 |
| 5                           | 14005            | 1/2        | 13            | 1155.71 | 10               | 5.3          |                 |
| 5-1/2                       | 14008            | 1/2        | 13            | 1816.97 | 10               | 6.2          |                 |
| 6                           | 14011            | 1/2        | 13            | 2164.50 | 10               | 6.6          |                 |
| 3/4"<br>3/8 Hex             | 1-1/2            | 14020      | 5/8           | 11      | 722.81           | 10           | 3.4             |
|                             | 1-3/4            | 14023      | 5/8           | 11      | 728.20           | 10           | 3.7             |
|                             | 2                | 14026      | 5/8           | 11      | 692.67           | 10           | 4.0             |
|                             | 2-1/4            | 14029      | 5/8           | 11      | 770.22           | 10           | 4.4             |
|                             | 2-1/2            | 14032      | 5/8           | 11      | 836.11           | 10           | 4.7             |
|                             | 2-3/4            | 14035      | 5/8           | 11      | 878.68           | 10           | 5.0             |
|                             | 3                | 14038      | 5/8           | 11      | 918.17           | 10           | 5.4             |
|                             | 3-1/4            | 14041      | 5/8           | 11      | 1076.46          | 10           | 5.6             |
|                             | 3-1/2            | 14044      | 5/8           | 11      | 1103.19          | 10           | 6.0             |
|                             | 3-3/4            | 14047      | 5/8           | 11      | 1166.33          | 10           | 6.3             |
|                             | 4                | 14050      | 5/8           | 11      | 1201.97          | 10           | 6.6             |
|                             | 4-1/4            | 14053      | 5/8           | 11      | 1341.89          | 10           | 7.0             |
|                             | 4-1/2            | 14056      | 5/8           | 11      | 1357.95          | 10           | 7.2             |
|                             | 4-3/4            | 14059      | 5/8           | 11      | 1486.65          | 10           | 7.6             |
| 5                           | 14062            | 5/8        | 11            | 1491.05 | 10               | 8.0          |                 |
| 5-1/2                       | 14065            | 5/8        | 11            | 2326.28 | 10               | 8.5          |                 |
| 6                           | 14068            | 5/8        | 11            | 2647.59 | 10               | 9.1          |                 |

# Pricing and Product Information – Inch Sizes



Made in the U.S.A.

## Camcar® Stainless Steel Socket Head Shoulder Screws

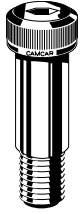

### Product Description:

- 300 Series(18-8) Stainless Steel
- Made in USA
- DFAR compliant

### Pricing Notes:

- Net Price per/ea. available in listed thread series only
- Bulk pricing available upon request

| Shldr. Dia. Recess | Shoulder Length | EDP No. | Thread Dia. | TPI  | Price Each | Count /Box | Wt. / Box |
|--------------------|-----------------|---------|-------------|------|------------|------------|-----------|
| 1/4"<br>1/8 Hex    | 1/8             | 73000   | #10         | 24   | 1.21       | 25         | 0.3       |
|                    | 3/16            | 73003   | #10         | 24   | 1.23       | 25         | 0.3       |
|                    | 1/4             | 73006   | #10         | 24   | 1.25       | 25         | 0.3       |
|                    | 5/16            | 73009   | #10         | 24   | 1.26       | 25         | 0.3       |
|                    | 3/8             | 73012   | #10         | 24   | 1.27       | 25         | 0.3       |
|                    | 1/2             | 73015   | #10         | 24   | 1.30       | 25         | 0.4       |
|                    | 5/8             | 73018   | #10         | 24   | 1.35       | 25         | 0.4       |
|                    | 3/4             | 73021   | #10         | 24   | 1.38       | 25         | 0.5       |
|                    | 1               | 73024   | #10         | 24   | 1.45       | 25         | 0.5       |
|                    | 1-1/4           | 73027   | #10         | 24   | 1.54       | 25         | 0.6       |
|                    | 1-1/2           | 73030   | #10         | 24   | 1.63       | 25         | 0.7       |
|                    | 1-3/4           | 73033   | #10         | 24   | 1.73       | 25         | 0.8       |
|                    | 2               | 73036   | #10         | 24   | 1.81       | 25         | 0.9       |
|                    | 2-1/4           | 73039   | #10         | 24   | 2.49       | 25         | 1.0       |
|                    | 2-1/2           | 73042   | #10         | 24   | 2.59       | 25         | 1.1       |
|                    | 2-3/4           | 73045   | #10         | 24   | 2.66       | 25         | 1.2       |
| 3                  | 73048           | #10     | 24          | 2.73 | 25         | 1.3        |           |
| 5/16"<br>5/32 Hex  | 1/4             | 73051   | 1/4         | 20   | 1.40       | 25         | 0.5       |
|                    | 5/16            | 73054   | 1/4         | 20   | 1.43       | 25         | 0.5       |
|                    | 3/8             | 73057   | 1/4         | 20   | 1.45       | 25         | 0.5       |
|                    | 1/2             | 73060   | 1/4         | 20   | 1.50       | 25         | 0.6       |
|                    | 5/8             | 73063   | 1/4         | 20   | 1.55       | 25         | 0.7       |
|                    | 3/4             | 73066   | 1/4         | 20   | 1.62       | 25         | 0.7       |
|                    | 1               | 73069   | 1/4         | 20   | 1.72       | 25         | 0.9       |
|                    | 1-1/4           | 73072   | 1/4         | 20   | 1.86       | 25         | 1.0       |
|                    | 1-1/2           | 73075   | 1/4         | 20   | 1.97       | 25         | 1.1       |
|                    | 1-3/4           | 73078   | 1/4         | 20   | 2.09       | 25         | 1.3       |
|                    | 2               | 73081   | 1/4         | 20   | 2.19       | 25         | 1.4       |
|                    | 2 1/4           | 73084   | 1/4         | 20   | 2.91       | 25         | 1.6       |
|                    | 2 1/2           | 73087   | 1/4         | 20   | 3.01       | 25         | 1.7       |
|                    | 2 3/4           | 73090   | 1/4         | 20   | 3.11       | 25         | 1.8       |
|                    | 3               | 73093   | 1/4         | 20   | 3.26       | 25         | 2.0       |
|                    | 3 1/2           | 73096   | 1/4         | 20   | 3.47       | 25         | 2.2       |
| 4                  | 73099           | 1/4     | 20          | 3.97 | 25         | 2.5        |           |

| Shldr. Dia. Recess | Shoulder Length | EDP No. | Thread Dia. | TPI   | Price Each | Count /Box | Wt. / Box |
|--------------------|-----------------|---------|-------------|-------|------------|------------|-----------|
| 3/8"<br>3/16 Hex   | 1/4             | 73102   | 5/16        | 18    | 2.01       | 25         | 0.8       |
|                    | 3/8             | 73105   | 5/16        | 18    | 2.08       | 25         | 0.9       |
|                    | 1/2             | 73108   | 5/16        | 18    | 2.15       | 25         | 1.0       |
|                    | 5/8             | 73112   | 5/16        | 18    | 2.23       | 25         | 1.1       |
|                    | 3/4             | 73115   | 5/16        | 18    | 2.30       | 25         | 1.2       |
|                    | 1               | 73118   | 5/16        | 18    | 2.47       | 25         | 1.4       |
|                    | 1-1/4           | 73121   | 5/16        | 18    | 2.61       | 25         | 1.6       |
|                    | 1-1/2           | 73124   | 5/16        | 18    | 2.76       | 25         | 1.8       |
|                    | 1-3/4           | 73127   | 5/16        | 18    | 2.91       | 25         | 2.0       |
|                    | 2               | 73130   | 5/16        | 18    | 3.09       | 25         | 2.2       |
|                    | 2-1/4           | 73133   | 5/16        | 18    | 3.80       | 25         | 2.4       |
|                    | 2-1/2           | 73136   | 5/16        | 18    | 3.95       | 25         | 2.6       |
|                    | 2-3/4           | 73139   | 5/16        | 18    | 4.14       | 25         | 2.8       |
|                    | 3               | 73142   | 5/16        | 18    | 4.28       | 25         | 3.0       |
|                    | 3-1/4           | 73145   | 5/16        | 18    | 4.78       | 25         | 3.2       |
|                    | 3-1/2           | 73148   | 5/16        | 18    | 4.97       | 25         | 3.4       |
| 3-3/4              | 73151           | 5/16    | 18          | 5.69  | 25         | 3.6        |           |
| 4                  | 73154           | 5/16    | 18          | 5.85  | 25         | 3.8        |           |
| 4-1/2              | 73157           | 5/16    | 18          | 7.00  | 25         | 4.2        |           |
| 5                  | 73160           | 5/16    | 18          | 7.36  | 25         | 4.6        |           |
| 1/2"<br>1/4 Hex    | 3/8             | 73163   | 3/8         | 16    | 2.77       | 25         | 1.8       |
|                    | 1/2             | 73166   | 3/8         | 16    | 2.91       | 25         | 2.0       |
|                    | 5/8             | 73169   | 3/8         | 16    | 3.03       | 25         | 2.1       |
|                    | 3/4             | 73172   | 3/8         | 16    | 3.18       | 25         | 2.3       |
|                    | 1               | 73175   | 3/8         | 16    | 3.44       | 25         | 2.7       |
|                    | 1-1/4           | 73178   | 3/8         | 16    | 3.71       | 25         | 3.0       |
|                    | 1-1/2           | 73181   | 3/8         | 16    | 3.99       | 25         | 3.4       |
|                    | 1-3/4           | 73184   | 3/8         | 16    | 4.25       | 25         | 3.7       |
|                    | 2               | 73187   | 3/8         | 16    | 4.52       | 25         | 4.1       |
|                    | 2-1/4           | 73190   | 3/8         | 16    | 5.34       | 25         | 4.4       |
|                    | 2-1/2           | 73193   | 3/8         | 16    | 5.62       | 25         | 4.8       |
|                    | 2-3/4           | 73196   | 3/8         | 16    | 5.88       | 25         | 5.1       |
|                    | 3               | 73199   | 3/8         | 16    | 6.14       | 25         | 5.5       |
|                    | 3-1/4           | 73202   | 3/8         | 16    | 6.45       | 25         | 5.8       |
|                    | 3-1/2           | 73205   | 3/8         | 16    | 6.71       | 25         | 6.2       |
|                    | 3-3/4           | 73208   | 3/8         | 16    | 8.07       | 25         | 6.5       |
| 4                  | 73211           | 3/8     | 16          | 8.39  | 25         | 6.9        |           |
| 4-1/4              | 73214           | 3/8     | 16          | 9.10  | 25         | 7.3        |           |
| 4-1/2              | 73217           | 3/8     | 16          | 9.41  | 10         | 3.1        |           |
| 4-3/4              | 73220           | 3/8     | 16          | 9.84  | 10         | 3.2        |           |
| 5                  | 73223           | 3/8     | 16          | 10.13 | 10         | 3.3        |           |

# Pricing and Product Information – Inch Sizes



Made in the U.S.A.

## Camcar® Stainless Steel Socket Head Shoulder Screws – *continued*

| Shldr. Dia. Recess      | Shoulder Length        | EDP No. | Thread Dia. | TPI   | Price Each | Count /Box | Wt. / Box |
|-------------------------|------------------------|---------|-------------|-------|------------|------------|-----------|
| <b>5/8"</b><br>5/16 Hex | 1/2                    | 73226   | 1/2         | 13    | 5.89       | 25         | 3.4       |
|                         | 5/8                    | 73229   | 1/2         | 13    | 6.02       | 25         | 3.6       |
|                         | 3/4                    | 73232   | 1/2         | 13    | 6.25       | 25         | 3.9       |
|                         | 1                      | 73235   | 1/2         | 13    | 6.74       | 25         | 4.5       |
|                         | 1-1/4                  | 73238   | 1/2         | 13    | 7.24       | 25         | 5.0       |
|                         | 1-1/2                  | 73241   | 1/2         | 13    | 7.72       | 25         | 5.6       |
|                         | 1-3/4                  | 73244   | 1/2         | 13    | 8.26       | 25         | 6.1       |
|                         | 2                      | 73247   | 1/2         | 13    | 8.75       | 25         | 6.7       |
|                         | 2 1/4                  | 73250   | 1/2         | 13    | 11.35      | 25         | 7.2       |
|                         | 2-1/2                  | 73253   | 1/2         | 13    | 12.92      | 25         | 7.8       |
|                         | 2-3/4                  | 73256   | 1/2         | 13    | 13.56      | 25         | 8.3       |
|                         | 3                      | 73259   | 1/2         | 13    | 14.05      | 25         | 8.9       |
|                         | 3-1/4                  | 73262   | 1/2         | 13    | 14.55      | 25         | 9.4       |
|                         | 3-1/2                  | 73265   | 1/2         | 13    | 15.04      | 25         | 10.0      |
|                         | 3-3/4                  | 73268   | 1/2         | 13    | 15.63      | 10         | 4.2       |
|                         | 4                      | 73271   | 1/2         | 13    | 16.12      | 10         | 4.4       |
|                         | 4-1/2                  | 73274   | 1/2         | 13    | 17.13      | 10         | 4.9       |
|                         | <b>3/4"</b><br>3/8 Hex | 1/2     | 73277       | 5/8   | 11         | 11.32      | 10        |
| 5/8                     |                        | 73280   | 5/8         | 11    | 11.62      | 10         | 2.5       |
| 3/4                     |                        | 73283   | 5/8         | 11    | 12.08      | 10         | 2.6       |
| 1                       |                        | 73286   | 5/8         | 11    | 12.88      | 10         | 2.9       |
| 1-1/4                   |                        | 73289   | 5/8         | 11    | 14.15      | 10         | 3.3       |
| 1-1/2                   |                        | 73292   | 5/8         | 11    | 14.49      | 10         | 3.6       |
| 1-3/4                   |                        | 73295   | 5/8         | 11    | 15.76      | 10         | 3.9       |
| 2                       |                        | 73298   | 5/8         | 11    | 16.79      | 10         | 4.2       |
| 2-1/4                   |                        | 73301   | 5/8         | 11    | 17.94      | 10         | 4.5       |
| 2-1/2                   |                        | 73304   | 5/8         | 11    | 19.09      | 10         | 4.8       |
| 2-3/4                   |                        | 73307   | 5/8         | 11    | 20.82      | 10         | 5.2       |
| 3                       |                        | 73310   | 5/8         | 11    | 21.62      | 10         | 5.5       |
| 3-1/4                   |                        | 73313   | 5/8         | 11    | 22.54      | 10         | 5.8       |
| 3-1/2                   |                        | 73316   | 5/8         | 11    | 23.81      | 10         | 6.1       |
| 3-3/4                   |                        | 73319   | 5/8         | 11    | 25.07      | 10         | 6.4       |
| 4                       |                        | 73322   | 5/8         | 11    | 26.45      | 10         | 6.7       |
| 4-1/4                   |                        | 73325   | 5/8         | 11    | 35.65      | 10         | 6.9       |
| 4-1/2                   |                        | 73328   | 5/8         | 11    | 37.03      | 10         | 7.2       |
| 4-3/4                   | 73331                  | 5/8     | 11          | 38.30 | 10         | 7.5        |           |
| 5                       | 73334                  | 5/8     | 11          | 39.68 | 10         | 7.8        |           |
| 5-1/2                   | 73337                  | 5/8     | 11          | 42.55 | 10         | 8.5        |           |
| 6                       | 73340                  | 5/8     | 11          | 45.31 | 10         | 9.1        |           |

| Shldr. Dia. Recess   | Shoulder Length | EDP No. | Thread Dia. | TPI | Price Each | Count /Box | Wt. / Box |
|----------------------|-----------------|---------|-------------|-----|------------|------------|-----------|
| <b>1"</b><br>1/2 Hex | 1               | 73343   | 3/4         | 10  | 21.05      | 10         | 5.5       |
|                      | 1-1/2           | 73346   | 3/4         | 10  | 24.73      | 10         | 6.6       |
|                      | 1-3/4           | 73349   | 3/4         | 10  | 26.22      | 10         | 7.2       |
|                      | 2               | 73352   | 3/4         | 10  | 28.18      | 10         | 7.8       |
|                      | 2-1/2           | 73355   | 3/4         | 10  | 32.09      | 10         | 8.9       |
|                      | 3               | 73358   | 3/4         | 10  | 35.31      | 10         | 10.0      |
|                      | 3-1/2           | 73361   | 3/4         | 10  | 39.22      | 10         | 11.2      |
|                      | 4               | 73364   | 3/4         | 10  | 49.91      | 10         | 12.3      |
|                      | 5               | 73367   | 3/4         | 10  | 57.85      | 10         | 14.6      |

# Pricing and Product Information – Inch Sizes



Made in  
the U.S.A.

## Camcar® Button Head Screws

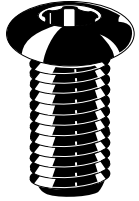

### Product Description:

- Heat-treated alloy steel
- Class 3A thread fit standard
- TORX PLUS® Drive recess available
- DFAR compliant

### Pricing Notes:

- Net price per 100 available in listed thread series only
- Bulk pricing upon request

| Dia.<br>Recess<br>Size<br>TPI   | Length<br>Under<br>Head | UNRC              |                            |                     | UNRF              |                            |                     | Ct./<br>Box | Wt./<br>Box |
|---|-------------------------|-------------------|----------------------------|---------------------|-------------------|----------------------------|---------------------|-------------|-------------|
|   |                         | Hex<br>EDP<br>No. | TORX<br>PLUS<br>EDP<br>No. | Price<br>Per<br>100 | Hex<br>EDP<br>No. | TORX<br>PLUS<br>EDP<br>No. | Price<br>Per<br>100 |             |             |
| #2<br>.050 Hex<br>UNRC<br>56 TPI  | 3/16                    | 14070             |                            | 34.66               |                   |                            |                     | 100         | .1          |
|   | 1/4                     | 14072             |                            | 36.89               |                   |                            |                     | 100         | .1          |
|   | 3/8                     | 14074             |                            | 39.64               |                   |                            |                     | 100         | .1          |
| #4<br>1/16 Hex<br>8IP<br>TORX PLUS<br>UNRC<br>40 TPI                    | 3/16                    | 14078             |                            | 20.67               |                   |                            |                     | 100         | .1          |
|   | 1/4                     | 14080             | 34080                      | 14.42               |                   |                            |                     | 100         | .1          |
|   | 3/8                     | 14083             | 34083                      | 15.37               |                   |                            |                     | 100         | .2          |
|   | 1/2                     | 14089             | 34089                      | 16.43               |                   |                            |                     | 100         | .2          |
| #6<br>5/64 Hex<br>10IP<br>TORX PLUS<br>UNRC<br>32 TPI                   | 3/16                    | 14095             |                            | 21.73               |                   |                            |                     | 100         | .2          |
|   | 1/4                     | 14101             | 34101                      | 14.84               |                   |                            |                     | 100         | .2          |
|   | 3/8                     | 14107             | 34107                      | 15.16               |                   |                            |                     | 100         | .2          |
|   | 1/2                     | 14110             | 34110                      | 16.11               |                   |                            |                     | 100         | .3          |
| #8<br>3/32 Hex<br>15IP<br>TORX PLUS<br>UNRC<br>32 TPI                   | 3/16                    | 71066             |                            | 43.78               |                   |                            |                     | 100         | .2          |
|   | 1/4                     | 14125             | 34125                      | 16.11               |                   |                            |                     | 100         | .2          |
|   | 3/8                     | 14131             | 34131                      | 16.75               |                   |                            |                     | 100         | .2          |
|   | 1/2                     | 14134             | 34134                      | 16.96               |                   |                            |                     | 100         | .3          |
|   | 5/8                     | 14137             | 34137                      | 19.29               |                   |                            |                     | 100         | .3          |
| #10<br>1/8 Hex<br>25IP<br>TORX PLUS<br>UNRC<br>24 TPI<br>UNRF<br>32 TPI | 3/4                     | 14140             | 34140                      | 20.14               |                   |                            |                     | 100         | .4          |
|   | 1                       | 14143             |                            | 21.52               |                   |                            |                     | 100         | .6          |
|   | 1/4                     | 14152             | 34152                      | 16.01               | 14302             | 34302                      | 16.01               | 100         | .3          |
|   | 3/8                     | 14155             | 34155                      | 16.32               | 14305             | 34305                      | 16.32               | 100         | .4          |
|   | 1/2                     | 14158             | 34158                      | 16.96               | 14311             | 34311                      | 16.96               | 100         | .4          |
|   | 5/8                     | 14161             | 34161                      | 19.19               | 14314             | 34314                      | 19.19               | 100         | .5          |
|   | 3/4                     | 14164             | 34164                      | 20.56               | 14317             | 34317                      | 20.56               | 100         | .6          |
| 7/8   | 14167                   |                   | 23.32                      | 14320               | 34320             | 23.32                      | 100                 | .7          |             |
| 1   | 14170                   | 34170             | 24.17                      | 14323               | 34323             | 24.17                      | 100                 | .7          |             |

| Dia.<br>Recess<br>Size<br>TPI    | Length<br>Under<br>Head | UNRC              |                            |                     | UNRF              |                            |                     | Ct./<br>Box | Wt./<br>Box |
|----------------------------------|-------------------------|-------------------|----------------------------|---------------------|-------------------|----------------------------|---------------------|-------------|-------------|
|                                  |                         | Hex<br>EDP<br>No. | TORX<br>PLUS<br>EDP<br>No. | Price<br>Per<br>100 | Hex<br>EDP<br>No. | TORX<br>PLUS<br>EDP<br>No. | Price<br>Per<br>100 |             |             |
| 1/4"                             | 1/4                     | 71093             |                            | 53.00               |                   |                            |                     | 100         | .6          |
|                                  | 3/8                     | 14176             | 34176                      | 18.23               | 14329             | 34329                      | 18.23               | 100         | .6          |
|                                  | 1/2                     | 14179             | 34179                      | 18.55               | 14332             | 34332                      | 18.55               | 100         | .8          |
|                                  | 5/8                     | 14182             | 34182                      | 19.08               | 14335             | 34335                      | 19.08               | 100         | .9          |
|                                  | 3/4                     | 14185             | 34185                      | 19.82               | 14338             | 34338                      | 19.82               | 100         | 1.1         |
|                                  | 7/8                     | 14188             |                            | 22.79               |                   |                            |                     | 100         | 1.2         |
|                                  | 1                       | 14191             | 34191                      | 23.11               | 14344             | 34344                      | 23.11               | 100         | 1.3         |
|                                  | 1-1/4                   | 14194             |                            | 28.30               |                   |                            |                     | 100         | 1.5         |
| 5/32 Hex<br>27IP<br>TORX PLUS    | 1-1/2                   | 14197             |                            | 30.74               |                   |                            |                     | 100         | 1.8         |
|                                  | 1-3/4                   | 71096             |                            | 70.60               |                   |                            |                     | 100         | 2.2         |
|                                  | 2                       | 71099             |                            | 82.15               |                   |                            |                     | 100         | 2.6         |
|                                  | 3/8                     | 14203             | 34203                      | 23.85               | 14350             |                            | 23.85               | 100         | 1.0         |
| 5/16"                            | 1/2                     | 14206             | 34206                      | 24.06               | 14353             | 34353                      | 24.06               | 100         | 1.3         |
|                                  | 5/8                     | 14209             | 34209                      | 28.51               | 14356             |                            | 28.51               | 100         | 1.5         |
|                                  | 3/4                     | 14212             | 34212                      | 28.94               | 14359             | 34359                      | 28.94               | 100         | 1.7         |
|                                  | 7/8                     | 14215             | 34215                      | 31.80               |                   |                            |                     | 100         | 2.1         |
|                                  | 1                       | 14218             | 34218                      | 32.33               | 14365             | 34365                      | 32.33               | 100         | 2.1         |
|                                  | 1-1/4                   | 14221             |                            | 51.41               |                   |                            |                     | 100         | 2.3         |
|                                  | 1-1/2                   | 14224             |                            | 54.27               |                   |                            |                     | 100         | 2.5         |
|                                  | 2                       | 71108             |                            | 70.07               |                   |                            |                     | 100         | 2.8         |
| 3/16 Hex<br>40IP<br>TORX PLUS    | 1/2                     | 14230             | 34230                      | 35.51               | 14371             | 34371                      | 35.51               | 100         | 1.8         |
|                                  | 5/8                     | 14233             | 34233                      | 39.22               |                   |                            |                     | 100         | 2.2         |
|                                  | 3/4                     | 14236             | 34236                      | 41.76               |                   |                            |                     | 100         | 2.5         |
|                                  | 7/8                     | 14239             | 34239                      | 45.90               |                   |                            |                     | 100         | 2.9         |
|                                  | 1                       | 14242             | 34242                      | 43.46               | 14380             | 34380                      | 43.46               | 100         | 3.2         |
|                                  | 1-1/4                   | 14245             | 34245                      | 46.43               |                   |                            |                     | 100         | 3.9         |
|                                  | 1-1/2                   | 14248             |                            | 57.98               |                   |                            |                     | 100         | 4.2         |
| UNRC<br>16 TPI<br>UNRF<br>24 TPI | 2                       | 71120             |                            | 89.36               |                   |                            |                     | 100         | 4.6         |
|                                  | 3/4                     | 14257             |                            | 71.34               |                   |                            |                     | 100         | 6.0         |
|                                  | 1                       | 14260             | 34260                      | 73.56               |                   |                            |                     | 50          | 3.3         |
|                                  | 1-1/4                   | 14263             |                            | 87.03               |                   |                            |                     | 50          | 3.6         |
| 5/16 Hex<br>55IP<br>TORX PLUS    | 1-1/2                   | 14266             |                            | 97.10               |                   |                            |                     | 50          | 3.9         |
|                                  | 2                       | 14272             |                            | 124.44              |                   |                            |                     | 50          | 5.6         |

# Pricing and Product Information – Inch Sizes



Made in  
the U.S.A.

## Camcar® Flanged Button Head Cap Screws



### Product Description:

- Heat-treated alloy steel
- Fully threaded
- Large bearing surface
- DFAR compliant

### Pricing Notes:

- Net price per 100 available in listed thread series only
- Bulk pricing upon request

| Diameter, TPI and Drive Size    | Length Under Head | Hex EDP Number | Price Per 100 | Count /Box | Wt. / 100 Pcs. |
|---------------------------------|-------------------|----------------|---------------|------------|----------------|
| <b>#8</b><br>32 TPI<br>3/32 Hex | 1/4               | 16453          | 14.20         | 100        | 0.2            |
|                                 | 3/8               | 16456          | 14.73         | 100        | 0.2            |
|                                 | 1/2               | 16459          | 15.48         | 100        | 0.3            |
| <b>#10</b><br>24 TPI<br>1/8 Hex | 3/8               | 16462          | 15.26         | 100        | 0.4            |
|                                 | 1/2               | 16465          | 15.58         | 100        | 0.4            |
|                                 | 5/8               | 16468          | 16.85         | 100        | 0.5            |
| <b>#10</b><br>32 TPI<br>1/8 Hex | 3/4               | 16471          | 17.91         | 100        | 0.6            |
|                                 | 3/8               | 16513          | 15.26         | 100        | 0.4            |
| <b>#10</b><br>32 TPI<br>1/8 Hex | 1/2               | 16517          | 15.58         | 100        | 0.4            |
|                                 | 5/8               | 16520          | 16.96         | 100        | 0.5            |
|                                 | 3/4               | 16523          | 18.02         | 100        | 0.6            |

| Diameter, TPI and Drive Size       | Length Under Head | Hex EDP Number | Price Per 100 | Count /Box | Wt. / 100 Pcs. |
|------------------------------------|-------------------|----------------|---------------|------------|----------------|
| <b>1/4"</b><br>20 TPI<br>5/32 Hex  | 3/8               | 16474          | 16.96         | 100        | 0.6            |
|                                    | 1/2               | 16477          | 17.28         | 100        | 0.8            |
|                                    | 3/4               | 16480          | 18.44         | 100        | 1.1            |
|                                    | 1                 | 16483          | 21.20         | 100        | 1.3            |
| <b>5/16"</b><br>18 TPI<br>3/16 Hex | 3/8               | 16486          | 20.67         | 100        | 1.0            |
|                                    | 1/2               | 16489          | 20.99         | 100        | 1.3            |
|                                    | 5/8               | 16491          | 23.32         | 100        | 1.5            |
|                                    | 3/4               | 16495          | 24.49         | 100        | 1.7            |
| <b>3/8"</b><br>16 TPI<br>7/32 Hex  | 1                 | 16498          | 27.77         | 100        | 1.9            |
|                                    | 1/2               | 16501          | 29.15         | 100        | 1.8            |
|                                    | 3/4               | 16504          | 36.46         | 100        | 2.5            |
|                                    | 1                 | 16507          | 38.69         | 100        | 3.2            |
|                                    | 1-1/4             | 16510          | 41.87         | 100        | 3.9            |

# Pricing and Product Information – Inch Sizes



Made in  
the U.S.A.

## Camcar® Low Head Cap Screws



### Product Description:

- Heat-treated alloy steel
- Class 3A thread fit standard
- DFAR compliant

### Pricing Notes:

- Net price per 100 available in listed thread series only
- Bulk pricing upon request

| Dia.,<br>Recess<br>Size,<br>TPI                     | Length<br>Under<br>Head | UNRC           |                  | UNRF           |                  | Ct./<br>Box | Wt./Box<br>(Lbs) |
|---|-------------------------|----------------|------------------|----------------|------------------|-------------|------------------|
|   |                         | Hex<br>EDP No. | Price<br>Per 100 | Hex<br>EDP No. | Price<br>Per 100 |             |                  |
| #6<br>5/64 Hex<br>UNRC<br>32 TPI                    | 1/4                     | 20091          | 24.61            |                |                  | 100         | .2               |
|   | 3/8                     | 20094          | 25.25            |                |                  | 100         | .2               |
|   | 1/2                     | 20097          | 26.54            |                |                  | 100         | .2               |
|   | 5/8                     | 20098          | 27.61            |                |                  | 100         | .2               |
| #8<br>5/64 Hex<br>UNRC<br>32 TPI                    | 1/4                     | 20103          | 28.99            |                |                  | 100         | .2               |
|   | 3/8                     | 20003          | 26.75            |                |                  | 100         | .3               |
|   | 1/2                     | 20006          | 28.14            |                |                  | 100         | .3               |
|   | 5/8                     | 20009          | 28.99            |                |                  | 100         | .3               |
| #10<br>3/32 Hex<br>UNRC<br>24 TPI                   | 3/4                     | 20012          | 31.46            |                |                  | 100         | .5               |
|   | 1                       | 20015          | 34.35            |                |                  | 100         | .7               |
|   | 1-1/4                   | 20105          | 37.02            |                |                  | 100         | .7               |
|   | 1-1/2                   | 20108          | 39.38            |                |                  | 100         | .9               |
| #10<br>3/32 Hex<br>UNRC<br>24 TPI<br>UNRF<br>32 TPI | 1/4                     | 20111          | 26.75            | 20141          | 27.71            | 100         | .4               |
|   | 3/8                     | 20018          | 27.18            | 21003          | 28.14            | 100         | .4               |
|   | 1/2                     | 20021          | 27.50            | 21006          | 28.89            | 100         | .5               |
|   | 5/8                     | 20024          | 29.96            | 21009          | 30.01            | 100         | .6               |
|   | 3/4                     | 20027          | 30.71            | 21012          | 31.14            | 100         | .7               |
|   | 1                       | 20030          | 32.74            | 21015          | 33.01            | 100         | .8               |
| UNRF<br>32 TPI                                      | 1-1/4                   |                |                  | 20144          | 36.49            | 100         | .8               |
|   | 1-1/2                   |                |                  | 20147          | 39.38            | 100         | .9               |

| Dia.,<br>Recess<br>Size,<br>TPI              | Length<br>Under<br>Head | UNRC           |                  | UNRF           |                  | Ct./<br>Box | Wt./Box<br>(Lbs) |
|--|-------------------------|----------------|------------------|----------------|------------------|-------------|------------------|
|  |                         | Hex<br>EDP No. | Price<br>Per 100 | Hex<br>EDP No. | Price<br>Per 100 |             |                  |
| 1/4"   | 1/4                     | 20114          | 25.79            |                |                  | 100         | .7               |
|  | 3/8                     | 20033          | 27.29            |                |                  | 100         | .7               |
| 1/8 Hex<br>UNRC<br>20 TPI<br>UNRF<br>28 TPI  | 1/2                     | 20036          | 27.93            | 20150          | 31.46            | 100         | .8               |
|  | 5/8                     | 20039          | 29.96            |                |                  | 100         | 1.1              |
| 5/16"  | 3/4                     | 20042          | 31.46            | 20153          | 35.42            | 100         | 1.2              |
|  | 1                       | 20045          | 34.35            |                |                  | 100         | 1.3              |
|  | 1-1/2                   | 20117          | 36.49            |                |                  | 100         | 1.8              |
|  | 1-1/4                   | 20050          | 36.00            |                |                  | 100         | 1.5              |
| 5/32 Hex<br>UNRC<br>18 TPI<br>UNRF<br>24 TPI | 1/2                     | 20048          | 32.10            | 20159          | 35.95            | 100         | 1.4              |
|  | 3/4                     | 20051          | 35.10            | 20161          | 38.20            | 100         | 1.8              |
|  | 1                       | 20054          | 38.95            |                |                  | 100         | 2.2              |
|  | 1-1/4                   | 20057          | 44.19            |                |                  | 100         | 2.8              |
| 3/8"<br>3/16 Hex<br>UNRC<br>16 TPI           | 1-1/2                   | 20060          | 52.75            |                |                  | 100         | 3.3              |
|  | 2                       | 20129          | 60.77            |                |                  | 100         | 4.0              |
|  | 1/2                     | 20063          | 43.98            |                |                  | 100         | 2.2              |
|  | 5/8                     | 20064          | 48.10            |                |                  | 100         | 2.6              |
|  | 3/4                     | 20066          | 46.01            |                |                  | 100         | 2.8              |
|  | 1                       | 20069          | 49.01            |                |                  | 100         | 3.5              |
| 1/2"<br>1/4 Hex<br>UNRC<br>13 TPI            | 1-1/4                   | 20072          | 57.03            |                |                  | 100         | 4.2              |
|  | 1-1/2                   | 20075          | 62.49            |                |                  | 100         | 5.0              |
|  | 2                       | 20132          | 67.73            |                |                  | 100         | 5.8              |
|  | 1                       | 20078          | 106.36           |                |                  | 50          | 3.7              |
|  | 3/4                     | 20076          | 118.10           |                |                  | 50          | 3.3              |
|  | 1-1/4                   | 20081          | 119.95           |                |                  | 50          | 4.1              |
|  | 1-1/2                   | 20084          | 134.18           |                |                  | 50          | 4.7              |
|  | 2                       | 20138          | 140.81           |                |                  | 50          | 5.4              |

# Pricing and Product Information – Inch Sizes



Made in the U.S.A.

## Camcar® Flat Countersunk Head Cap Screws

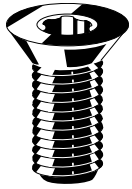

### Product Description:

- Heat-treated alloy steel
- Class 3A thread fit standard except as noted
- TORX PLUS® Drive recess available
- DFAR compliant

### Pricing Notes:

- Net price per 100 available in listed thread series only
- Bulk pricing upon request

| Dia., Recess Size, TPI  | Len. Under Head | UNRC        |                   |               | UNRF        |                   |               | Ct./Box | Wt./Box (Lbs) |
|---|-----------------|-------------|-------------------|---------------|-------------|-------------------|---------------|---------|---------------|
|   |                 | Hex EDP No. | TORX PLUS EDP No. | Price Per 100 | Hex EDP No. | TORX PLUS EDP No. | Price Per 100 |         |               |
| #2<br>.050 Hex<br>UNRC 56 TPI   | 3/16            | 14382       |                   | 39.33         |             |                   | 100           | .1      |               |
|   | 1/4             | 14385       |                   | 42.29         |             |                   | 100           | .1      |               |
|   | 3/8             | 14387       |                   | 46.00         |             |                   | 100           | .1      |               |
|   | 1/2             | 14390       |                   | 49.40         |             |                   | 100           | .1      |               |
| #4<br>1/16 Hex<br>10IP<br>TORX PLUS<br>UNRC 40 TPI                        | 1/4             | 14392       | 34392             | 19.08         |             |                   | 100           | .1      |               |
|   | 3/8             | 14395       | 34395             | 19.72         |             |                   | 100           | .1      |               |
|   | 1/2             | 14398       | 34398             | 20.88         |             |                   | 100           | .1      |               |
|   | 5/8             | 14401       | 34401             | 21.84         |             |                   | 100           | .2      |               |
|   | 3/4             | 14404       | 34404             | 24.91         |             |                   | 100           | .2      |               |
| #5<br>5/64 Hex<br>10IP<br>TORX PLUS<br>UNRC 40 TPI                        | 1/4             | 14413       | 34413             | 20.67         |             |                   | 100           | .1      |               |
|   | 3/8             | 14416       | 34416             | 20.56         |             |                   | 100           | .1      |               |
|   | 1/2             | 14419       | 34419             | 21.84         |             |                   | 100           | .2      |               |
|   | 5/8             | 14422       |                   | 24.17         |             |                   | 100           | .2      |               |
| #6<br>5/64 Hex<br>15IP<br>TORX PLUS<br>UNRC 32 TPI                        | 3/4             | 14425       |                   | 27.35         |             |                   | 100           | .2      |               |
|   | 1/4             | 14434       | 34434             | 21.41         |             |                   | 100           | .1      |               |
|   | 3/8             | 14440       | 34440             | 21.94         |             |                   | 100           | .2      |               |
|   | 1/2             | 14443       | 34443             | 22.58         |             |                   | 100           | .2      |               |
| #8<br>3/32 Hex<br>20IP<br>TORX PLUS<br>UNRC 32 TPI                        | 5/8             | 14446       | 34446             | 24.49         |             |                   | 100           | .3      |               |
|   | 3/4             | 14449       | 34449             | 25.02         |             |                   | 100           | .3      |               |
|   | 1               | 14451       |                   | 29.57         |             |                   | 100           | .3      |               |
|   | 3/8             | 14458       | 34458             | 21.52         |             |                   | 100           | .3      |               |
|   | 1/2             | 14461       | 34461             | 21.84         |             |                   | 100           | .3      |               |
| #10<br>1/8 Hex<br>25IP<br>TORX PLUS<br>UNRC 24 TPI<br>UNRF 32 TPI         | 5/8             | 14464       | 34464             | 23.85         |             |                   | 100           | .4      |               |
|   | 3/4             | 14467       | 34467             | 26.08         |             |                   | 100           | .4      |               |
|   | 1               | 14473       | 34473             | 29.04         |             |                   | 100           | .5      |               |
|   | 3/8             | 14482       | 34482             | 21.62         | 14773       | 34773             | 21.62         | 100     | .3            |
|   | 1/2             | 14485       | 34485             | 21.84         | 14779       | 34779             | 21.84         | 100     | .4            |
| 1/4"<br>5/32 Hex<br>30IP<br>TORX PLUS<br>UNRC<br>20 TPI<br>UNRF<br>28 TPI | 5/8             | 14488       | 34488             | 24.80         | 14782       | 34782             | 24.80         | 100     | .5            |
|   | 3/4             | 14491       | 34491             | 25.02         | 14785       | 34785             | 25.02         | 100     | .5            |
|   | 1               | 14497       | 34497             | 30.00         | 14791       | 34791             | 30.00         | 100     | .7            |
|   | 1-1/4           | 14500       |                   | 38.58         | 14794       | 34794             | 38.58         | 100     | .9            |
|   | 1-1/2           | 14503       |                   | 44.31         | 14797       | 34797             | 44.31         | 100     | 1.1           |
| 1/4"<br>5/32 Hex<br>30IP<br>TORX PLUS<br>UNRC<br>20 TPI<br>UNRF<br>28 TPI | 3/8             | 14506       | 34506             | 24.38         | 14809       |                   | 24.38         | 100     | .6            |
|   | 1/2             | 14509       | 34509             | 23.53         | 14815       | 34815             | 23.53         | 100     | .8            |
|   | 5/8             | 14515       | 34515             | 25.02         | 14818       | 34818             | 25.02         | 100     | .9            |
|   | 3/4             | 14518       | 34518             | 25.12         | 14821       | 34821             | 25.12         | 100     | 1.1           |
|   | 7/8             | 72051       |                   | 31.27         |             |                   |               | 100     | 1.2           |
|   | 1               | 14524       | 34524             | 27.98         | 14824       | 34824             | 27.98         | 100     | 1.3           |
|   | 1-1/4           | 14527       | 34527             | 37.10         | 14827       | 34827             | 37.10         | 100     | 1.6           |
|   | 1-1/2           | 14530       | 34530             | 43.46         | 14830       |                   | 43.46         | 100     | 2.0           |
|   | 1-3/4           | 14533       | 34533             | 52.68         |             |                   |               | 100     | 2.3           |
|   | 2               | 14536       | 34536             | 57.24         |             |                   |               | 100     | 2.7           |
|   | 2-1/2           | 14542       |                   | 62.65         |             |                   |               | 100     | 3.0           |
| 3   | 72057           |             | 100.59            |               |             |                   | 100           | 3.5     |               |

| Dia., Recess Size, TPI           | Len. Under Head               | UNRC        |                   |               | UNRF        |                   |               | Ct./Box | Wt./Box (Lbs) |     |
|----------------------------------|-------------------------------|-------------|-------------------|---------------|-------------|-------------------|---------------|---------|---------------|-----|
|                                  |                               | Hex EDP No. | TORX PLUS EDP No. | Price Per 100 | Hex EDP No. | TORX PLUS EDP No. | Price Per 100 |         |               |     |
| 5/16"                            | 1/2                           | 14548       | 34548             | 27.88         | 14839       | 34839             | 27.88         | 100     | 1.4           |     |
|                                  | 5/8                           | 14554       | 34554             | 29.26         | 14842       | 34842             | 29.26         | 100     | 1.6           |     |
|                                  | 3/4                           | 14557       | 34557             | 29.68         | 14845       | 34845             | 29.68         | 100     | 1.8           |     |
|                                  | 7/8                           | 14560       |                   | 30.74         | 14846       |                   | 30.74         | 100     | 2.1           |     |
| 3/16" Hex<br>40IP<br>TORX PLUS   | 1                             | 14563       | 34563             | 31.80         | 14848       | 34848             | 31.80         | 100     | 2.3           |     |
|                                  | 1-1/4                         | 14566       | 34566             | 40.60         | 14851       |                   | 40.60         | 100     | 2.7           |     |
|                                  | 1-1/2                         | 14572       | 34572             | 45.05         | 14854       |                   | 45.05         | 100     | 3.2           |     |
|                                  | 1-3/4                         | 14575       | 34575             | 64.66         |             |                   |               | 100     | 3.8           |     |
|                                  | 2                             | 14578       | 34578             | 71.23         |             |                   |               | 100     | 4.3           |     |
| UNRC<br>18 TPI<br>UNRF<br>24 TPI | 2-1/4                         | 14581       |                   | 82.26         |             |                   |               | 100     | 4.8           |     |
|                                  | 2-1/2                         | 14584       |                   | 92.33         |             |                   |               | 100     | 5.3           |     |
|                                  | 1/2                           | 14590       | 34590             | 43.04         |             |                   |               | 100     | 2.2           |     |
| 3/8"                             | 5/8                           | 14593       | 34593             | 41.34         | 14866       | 34866             | 41.34         | 100     | 2.5           |     |
|                                  | 3/4                           | 14596       | 34596             | 44.63         | 14869       | 34869             | 44.63         | 100     | 2.8           |     |
|                                  | 1                             | 14602       | 34602             | 45.05         | 14872       | 34872             | 45.05         | 100     | 3.6           |     |
|                                  | 7/32 Hex<br>45IP<br>TORX PLUS | 1-1/4       | 14605             | 34605         | 48.02       | 14875             | 34875         | 48.02   | 100           | 4.1 |
| UNRC 16 TPI<br>UNRF 24 TPI       | 1-1/2                         | 14608       | 34608             | 50.56         | 14878       |                   | 50.56         | 100     | 4.8           |     |
|                                  | 1-3/4                         | 14611       | 34611             | 73.25         |             |                   |               | 100     | 5.4           |     |
|                                  | 2                             | 14614       | 34614             | 80.56         |             |                   |               | 100     | 6.2           |     |
|                                  | 2-1/4                         | 14617       |                   | 95.82         |             |                   |               | 100     | 6.9           |     |
|                                  | 2-1/2                         | 14620       | 34620             | 103.46        |             |                   |               | 50      | 3.9           |     |
| 7/16"                            | 3                             | 14626       |                   | 122.32        |             |                   |               | 50      | 4.6           |     |
|                                  | 3/4                           | 14635       |                   | 88.09         |             |                   |               | 100     | 3.6           |     |
|                                  | 1                             | 14638       | 34638             | 96.78         |             |                   |               | 100     | 4.5           |     |
|                                  | 1/4 Hex<br>50IP<br>TORX PLUS  | 1-1/4       | 14641             |               | 106.00      |                   |               | 100     | 5.3           |     |
|                                  | 1-1/2                         | 14644       |                   | 113.21        |             |                   |               | 100     | 6.2           |     |
| UNRC 14 TPI                      | 1-3/4                         | 14647       |                   | 118.51        |             |                   |               | 100     | 7.1           |     |
|                                  | 2                             | 14650       |                   | 123.38        |             |                   |               | 100     | 8.8           |     |
|                                  | 3/4                           | 14653       | 34653             | 90.18         | 14884       |                   | 90.18         | 100     | 4.5           |     |
| 1/2"                             | 1                             | 14662       | 34662             | 94.28         | 14887       |                   | 94.28         | 100     | 5.7           |     |
|                                  | 5/16 Hex<br>50IP<br>TORX PLUS | 1-1/4       | 14665             | 34665         | 108.65      | 14890             |               | 108.65  | 100           | 6.7 |
|                                  | 1-1/2                         | 14668       | 34668             | 114.80        | 14893       |                   | 114.80        | 100     | 7.7           |     |
|                                  | 1-3/4                         | 14671       | 34671             | 129.60        | 14896       |                   | 129.60        | 50      | 4.5           |     |
|                                  | 2                             | 14674       | 34674             | 135.00        | 14902       |                   | 135.00        | 50      | 5.1           |     |
| UNRC 13 TPI<br>UNRF 20 TPI       | 2-1/4                         | 14677       |                   | 161.78        |             |                   |               | 25      | 2.9           |     |
|                                  | 2-1/2                         | 14680       |                   | 173.99        |             |                   |               | 25      | 3.3           |     |
|                                  | 3                             | 14686       |                   | 198.61        |             |                   |               | 25      | 4.0           |     |
| 5/8"                             | 1-1/4                         | 14698       |                   | 204.88        |             |                   |               | 25      | 5.7           |     |
|                                  | 3/8 Hex<br>55IP<br>TORX PLUS  | 1-1/2       | 14701             |               | 223.56      |                   |               | 25      | 6.5           |     |
|                                  | 1-3/4                         | 14704       |                   | 258.66        |             |                   |               | 25      | 7.4           |     |
|                                  | 2                             | 14707       |                   | 269.57        |             |                   |               | 25      | 8.3           |     |

# Pricing and Product Information – Inch Sizes



Made in the U.S.A.

## Camcar® Socket Set Screws – Cup Point



### Product Description:

- Heat-treated alloy steel
- Class 3A thread fit standard
- TORX PLUS® Drive recess available
- DFAR compliant

### Pricing Notes:

- Net price per 100 available in listed thread series only
- Bulk pricing available upon request

| Dia.,<br>Recess<br>Size,<br>TPI  | Len.<br>Under<br>Head | UNRC              |                            |                     | UNRF              |                            |                     | Ct./<br>Box | Wt./<br>Box<br>(Lbs) |
|--|-----------------------|-------------------|----------------------------|---------------------|-------------------|----------------------------|---------------------|-------------|----------------------|
|  |                       | Hex<br>EDP<br>No. | TORX<br>PLUS<br>EDP<br>No. | Price<br>Per<br>100 | Hex<br>EDP<br>No. | TORX<br>PLUS<br>EDP<br>No. | Price<br>Per<br>100 |             |                      |
| #2<br>.035 Hex<br>UNC 56 TPI   | 1/16                  | 11449             |                            | 51.30               |                   |                            | 100                 | .03         |                      |
|  | 3/32                  | 11450             |                            | 53.42               |                   |                            | 100                 | .03         |                      |
|  | 1/8                   | 11452             |                            | 54.06               |                   |                            | 100                 | .03         |                      |
|  | 3/16                  | 11455             |                            | 56.50               |                   |                            | 100                 | .03         |                      |
|  | 1/4                   | 11458             |                            | 57.24               |                   |                            | 100                 | .03         |                      |
| #3<br>.050 Hex<br>UNC 48 TPI   | 3/32                  | 11463             |                            | 41.98               |                   |                            | 100                 | .04         |                      |
|  | 1/8                   | 11464             |                            | 42.40               |                   |                            | 100                 | .04         |                      |
|  | 3/16                  | 11467             |                            | 43.04               |                   |                            | 100                 | .04         |                      |
|  | 1/4                   | 11470             |                            | 43.46               |                   |                            | 100                 | .04         |                      |
| #4<br>.050 Hex<br>UNC 40 TPI<br>UNF 48 TPI   | 1/8                   | 11473             |                            | 14.42               | 11962             |                            | 14.42               | 100         | .1                   |
|  | 3/16                  | 11476             |                            | 14.63               | 11965             |                            | 14.63               | 100         | .1                   |
|  | 1/4                   | 11479             |                            | 14.73               | 11968             |                            | 14.73               | 100         | .1                   |
|  | 5/16                  | 11482             |                            | 14.95               |                   |                            | 100                 | .1          |                      |
|  | 3/8                   | 11485             |                            | 15.90               |                   |                            | 100                 | .1          |                      |
|  | 1/2                   | 11491             |                            | 18.66               |                   |                            | 100                 | .2          |                      |
| #5<br>1/16 Hex<br>UNC 40 TPI<br>UNF 44 TPI   | 5/8                   | 11494             |                            | 22.58               |                   |                            | 100                 | .2          |                      |
|  | 1/8                   | 11497             |                            | 15.48               | 11977             |                            | 15.48               | 100         | .1                   |
|  | 3/16                  | 11500             |                            | 15.79               |                   |                            | 100                 | .1          |                      |
|  | 1/4                   | 11503             |                            | 16.11               |                   |                            | 100                 | .1          |                      |
|  | 5/16                  | 11506             |                            | 16.32               |                   |                            | 100                 | .1          |                      |
|  | 3/8                   | 11509             |                            | 17.99               |                   |                            | 100                 | .2          |                      |
|  | 1/2                   | 11515             |                            | 19.08               |                   |                            | 100                 | .2          |                      |
| #6<br>1/16 Hex<br>6IP TORX<br>PLUS (UNC)<br>7IP TORX<br>PLUS (UNF)<br>UNC 32 TPI<br>UNF 40 TPI | 5/8                   | 11518             |                            | 19.82               |                   |                            | 100                 | .3          |                      |
|  | 3/4                   | 11521             |                            | 20.78               |                   |                            | 100                 | .3          |                      |
|  | 1/8                   | 11524             |                            | 16.96               | 11986             |                            | 16.96               | 100         | .1                   |
|  | 3/16                  | 11527             | 31527                      | 15.16               | 11989             |                            | 15.16               | 100         | .1                   |
|  | 1/4                   | 11530             | 31530                      | 15.37               | 11992             |                            | 15.37               | 100         | .1                   |
|  | 5/16                  | 11533             |                            | 15.58               |                   |                            | 100                 | .1          |                      |
|  | 3/8                   | 11536             | 31536                      | 15.79               | 11998             |                            | 15.79               | 100         | .2                   |
|  | 1/2                   | 11542             |                            | 16.75               |                   |                            | 100                 | .3          |                      |
|  | 5/8                   | 11545             |                            | 22.58               |                   |                            | 100                 | .3          |                      |
|  | 3/4                   | 11548             |                            | 25.23               |                   |                            | 100                 | .4          |                      |
| #8<br>5/64 Hex<br>8IP<br>TORX PLUS<br>UNC 32 TPI<br>UNF 36 TPI                                 | 7/8                   | 11551             |                            | 34.98               |                   |                            | 100                 | .4          |                      |
|  | 1                     | 11554             |                            | 37.52               |                   |                            | 100                 | .4          |                      |
|  | 1/8                   | 11557             |                            | 14.10               |                   |                            | 100                 | .1          |                      |
|  | 3/16                  | 11560             | 31560                      | 14.31               |                   |                            | 100                 | .1          |                      |
|  | 1/4                   | 11563             | 31563                      | 14.52               | 12007             |                            | 14.52               | 100         | .1                   |
|  | 5/16                  | 11566             |                            | 14.84               |                   |                            | 100                 | .2          |                      |
|  | 3/8                   | 11569             | 31569                      | 15.26               | 12013             | 32013                      | 15.26               | 100         | .2                   |
|  | 1/2                   | 11575             |                            | 17.28               |                   |                            | 100                 | .3          |                      |
|  | 5/8                   | 11578             |                            | 23.64               |                   |                            | 100                 | .3          |                      |
|  | 3/4                   | 11581             |                            | 25.02               |                   |                            | 100                 | .4          |                      |
|  | 7/8                   | 11584             |                            | 33.28               |                   |                            | 100                 | .4          |                      |
| 1  | 11587                 |                   | 36.89                      |                     |                   | 100                        | .5                  |             |                      |

| Dia.,<br>Recess<br>Size,<br>TPI   | Len.<br>Under<br>Head | UNRC              |                            |                     | UNRF              |                            |                     | Ct./<br>Box | Wt./<br>Box<br>(Lbs) |
|---|-----------------------|-------------------|----------------------------|---------------------|-------------------|----------------------------|---------------------|-------------|----------------------|
|   |                       | Hex<br>EDP<br>No. | TORX<br>PLUS<br>EDP<br>No. | Price<br>Per<br>100 | Hex<br>EDP<br>No. | TORX<br>PLUS<br>EDP<br>No. | Price<br>Per<br>100 |             |                      |
| #10<br>3/32 Hex<br>10IP<br>TORX PLUS<br>UNC 24 TPI<br>UNF 32 TPI  | 3/16                  | 11590             |                            | 14.52               | 12022             |                            | 14.52               | 100         | .2                   |
|   | 1/4                   | 11593             | 31593                      | 14.84               | 12025             | 32025                      | 14.84               | 100         | .2                   |
|   | 5/16                  | 11596             | 31596                      | 15.26               | 12028             |                            | 15.26               | 100         | .2                   |
|   | 3/8                   | 11599             | 31599                      | 16.43               | 12031             | 32031                      | 16.43               | 100         | .3                   |
|   | 1/2                   | 11602             |                            | 17.70               | 12037             | 32037                      | 17.70               | 100         | .3                   |
|   | 5/8                   | 11605             |                            | 18.44               | 12040             | 32040                      | 18.44               | 100         | .4                   |
|   | 3/4                   | 11608             |                            | 20.88               | 12043             | 32043                      | 20.88               | 100         | .5                   |
|   | 7/8                   | 11611             |                            | 34.98               |                   |                            |                     | 100         | .6                   |
|   | 1                     | 11617             |                            | 38.58               | 12049             |                            | 38.58               | 100         | .7                   |
|   | 1-1/4                 | 11620             |                            | 40.39               | 12052             |                            | 40.39               | 100         | .8                   |
| 1/4"<br>1/8 Hex<br>15IP<br>TORX PLUS<br>(UNC)<br>20IP<br>TORX PLUS<br>(UNF)<br>UNC 20 TPI<br>UNF 28 TPI   | 3/16                  | 11626             |                            | 15.90               | 12061             | 32061                      | 15.90               | 100         | .2                   |
|   | 1/4                   | 11629             | 31629                      | 14.52               | 12064             | 32064                      | 14.52               | 100         | .3                   |
|   | 5/16                  | 11632             | 31632                      | 14.84               | 12067             | 32067                      | 14.84               | 100         | .3                   |
|   | 3/8                   | 11635             | 31635                      | 16.22               | 12070             | 32070                      | 16.22               | 100         | .4                   |
|   | 1/2                   | 11641             | 31641                      | 17.17               | 12076             | 32076                      | 17.17               | 100         | .5                   |
|   | 5/8                   | 11644             |                            | 20.56               | 12079             | 32079                      | 20.56               | 100         | .6                   |
|   | 3/4                   | 11647             | 31647                      | 23.32               | 12082             | 32082                      | 23.32               | 100         | .7                   |
|   | 7/8                   | 11650             |                            | 29.47               |                   |                            |                     | 100         | .8                   |
|   | 1                     | 11653             |                            | 33.50               | 12085             | 32085                      | 33.50               | 100         | .9                   |
|   | 1-1/4                 | 11656             |                            | 42.40               | 12088             | 32088                      | 42.40               | 100         | 1.2                  |
| 5/16"<br>5/32 Hex<br>25IP<br>TORX PLUS<br>(UNC)<br>27IP<br>TORX PLUS<br>(UNF)<br>UNC 18 TPI<br>UNF 24 TPI | 1-1/2                 | 11659             |                            | 53.32               |                   |                            |                     | 100         | 1.5                  |
|   | 1-3/4                 | 11662             |                            | 68.16               |                   |                            |                     | 100         | 1.9                  |
|   | 2                     | 11665             |                            | 77.70               |                   |                            |                     | 100         | 2.2                  |
|   | 1/4                   | 11671             |                            | 17.38               | 12094             |                            | 17.38               | 100         | .4                   |
|   | 5/16                  | 11674             | 31674                      | 16.43               | 12097             |                            | 16.43               | 100         | .5                   |
|   | 3/8                   | 11677             | 31677                      | 16.64               | 12100             |                            | 16.64               | 100         | .6                   |
|   | 7/16                  | 11680             |                            | 17.07               |                   |                            |                     | 100         | .7                   |
|   | 1/2                   | 11683             | 31683                      | 17.38               | 12106             |                            | 17.38               | 100         | .8                   |
|   | 5/8                   | 11686             |                            | 22.05               | 12109             |                            | 22.05               | 100         | 1.0                  |
|   | 3/4                   | 11689             |                            | 25.44               | 11687             |                            | 25.44               | 100         | 1.2                  |
| 7IP<br>TORX PLUS<br>(UNF)<br>UNC 18 TPI<br>UNF 24 TPI   | 7/8                   | 11692             |                            | 35.62               |                   |                            |                     | 100         | 1.4                  |
|   | 1                     | 11695             |                            | 37.95               | 12118             |                            | 37.95               | 100         | 1.6                  |
|   | 1-1/4                 | 11698             |                            | 43.46               |                   |                            |                     | 100         | 1.9                  |
|   | 1-1/2                 | 11701             |                            | 57.56               |                   |                            |                     | 100         | 2.4                  |
|   | 1-3/4                 | 11704             |                            | 71.13               |                   |                            |                     | 100         | 3.0                  |
|   | 2                     | 11707             |                            | 75.58               |                   |                            |                     | 100         | 3.4                  |

# Pricing and Product Information – Inch Sizes



Made in the U.S.A.

## Camcar® Socket Set Screws – Cup Point, *continued*

| Dia., Recess Size, TPI | Len. Under Head | UNRC        |                   |               | UNRF        |                   |               | Ct./Box | Wt./Box (Lbs) |
|------------------------|-----------------|-------------|-------------------|---------------|-------------|-------------------|---------------|---------|---------------|
|                        |                 | Hex EDP No. | TORX PLUS EDP No. | Price Per 100 | Hex EDP No. | TORX PLUS EDP No. | Price Per 100 |         |               |
| 3/8"                   | 1/4             | 11713       |                   | 21.41         | 12124       |                   | 21.41         | 100     | .6            |
|                        | 5/16            | 11716       |                   | 22.79         |             |                   |               | 100     | .6            |
|                        | 3/8             | 11719       |                   | 19.08         | 12130       |                   | 19.08         | 100     | .8            |
|                        | 1/2             | 11725       |                   | 22.26         | 12136       |                   | 22.26         | 100     | 1.1           |
|                        | 5/8             | 11728       |                   | 25.76         | 12139       |                   | 25.76         | 100     | 1.3           |
| 3/16 Hex               | 3/4             | 11731       |                   | 27.56         | 12142       |                   | 27.56         | 100     | 1.8           |
| UNC 16 TPI             | 1               | 11737       |                   | 37.95         | 12148       |                   | 37.95         | 100     | 2.3           |
|                        | 1-1/4           | 11740       |                   | 48.12         | 12151       |                   | 48.12         | 100     | 2.7           |
| UNF 24 TPI             | 1-1/2           | 11743       |                   | 62.65         | 12134       |                   | 62.65         | 100     | 3.6           |
|                        | 1-3/4           | 11746       |                   | 76.11         |             |                   |               | 100     | 3.6           |
|                        | 2               | 11749       |                   | 88.09         |             |                   |               | 100     | 5.0           |
|                        | 2-1/2           | 11752       |                   | 96.46         |             |                   |               | 100     | 6.3           |

| Dia., Recess Size, TPI | Len. Under Head | UNRC        |                   |               | UNRF        |                   |               | Ct./Box | Wt./Box (Lbs) |
|------------------------|-----------------|-------------|-------------------|---------------|-------------|-------------------|---------------|---------|---------------|
|                        |                 | Hex EDP No. | TORX PLUS EDP No. | Price Per 100 | Hex EDP No. | TORX PLUS EDP No. | Price Per 100 |         |               |
| 7/16"                  | 3/8             |             |                   |               | 12163       |                   | 53.00         | 100     | 1.1           |
|                        | 1/2             | 11761       |                   | 46.22         | 12169       |                   | 46.22         | 100     | 1.4           |
|                        | 5/8             | 11764       |                   | 50.46         |             |                   |               | 100     | 1.7           |
|                        | 7/32 Hex        | 3/4         | 11767             |               | 54.48       |                   |               | 100     | 2.2           |
| UNC 14 TPI             | 1               | 11773       |                   | 70.28         |             |                   |               | 100     | 3.0           |
|                        | 1-1/4           | 11776       |                   | 75.47         |             |                   |               | 100     | 4.1           |
| UNF 20 TPI             | 1-1/2           | 11779       |                   | 88.09         |             |                   |               | 100     | 4.5           |
|                        | 2               | 11782       |                   | 110.98        |             |                   |               | 50      | 3.4           |
| 1/2"                   | 3/8             | 11794       |                   | 56.16         |             |                   |               | 100     | 1.3           |
|                        | 1/2             | 11800       |                   | 55.40         | 12187       |                   | 55.40         | 100     | 1.7           |
|                        | 5/8             | 11803       |                   | 60.91         |             |                   |               | 100     | 2.2           |
|                        | 3/4             | 11806       |                   | 63.07         | 12193       |                   | 63.07         | 100     | 2.9           |
|                        | 7/8             | 11809       |                   | 70.52         |             |                   |               | 100     | 3.3           |
| 1/4 Hex                | 1               | 11812       |                   | 79.70         | 12196       |                   | 79.70         | 100     | 3.9           |
| UNC 13 TPI             | 1-1/4           | 11815       |                   | 100.22        |             |                   |               | 100     | 5.0           |
|                        | 1-1/2           | 11818       |                   | 111.56        |             |                   |               | 100     | 6.2           |
| UNF 20 TPI             | 1-3/4           | 11821       |                   | 129.17        |             |                   |               | 50      | 3.7           |
|                        | 2               | 11824       |                   | 146.23        |             |                   |               | 50      | 4.3           |
|                        | 2-1/2           | 11830       |                   | 188.24        |             |                   |               | 50      | 5.4           |
|                        | 3               | 11833       |                   | 195.91        |             |                   |               | 50      | 6.5           |

## Camcar® Socket Set Screws – Knurled Cup Point



### Product Description:

- Heat-treated alloy steel
- Class 3A thread fit standard
- DFAR compliant

### Pricing Notes:

- Net price per 100 available in listed thread series only
- Bulk pricing available upon request

| Dia., Recess Size, TPI | Length Under Head | UNRC        |               | UNRF        |               | Ct./Box | Wt./Box (Lbs) |    |
|------------------------|-------------------|-------------|---------------|-------------|---------------|---------|---------------|----|
|                        |                   | Hex EDP No. | Price Per 100 | Hex EDP No. | Price Per 100 |         |               |    |
| #6                     | 1/8               | 13180       | 14.98         |             |               | 100     | .1            |    |
|                        | 3/16              | 13183       | 15.19         |             |               | 100     | .1            |    |
| UNC 32 TPI             | 1/4               | 13186       | 15.52         |             |               | 100     | .1            |    |
| #8                     | 1/8               | 13210       | 14.66         |             |               | 100     | .1            |    |
|                        | 5/64 Hex          | 1/4         | 13216         | 15.52       |               | 100     | .2            |    |
| UNC 32 TPI             | 3/8               | 13222       | 15.41         |             |               | 100     | .2            |    |
| #10                    | 3/16              | 13240       | 15.09         | 13627       | 15.09         | 100     | .2            |    |
|                        | 3/32 Hex          | 1/4         | 13243         | 15.41       | 13630         | 15.41   | 100           | .2 |
|                        | UNC 24 TPI        | 3/8         | 13246         | 16.37       | 13636         | 16.37   | 100           | .3 |

| Dia., Recess Size, TPI | Length Under Head | UNRC        |               | UNRF        |               | Ct./Box | Wt./Box (Lbs) |     |
|------------------------|-------------------|-------------|---------------|-------------|---------------|---------|---------------|-----|
|                        |                   | Hex EDP No. | Price Per 100 | Hex EDP No. | Price Per 100 |         |               |     |
| 1/4"                   | 3/16              | 13270       | 15.62         |             |               | 100     | .2            |     |
|                        | 1/4               | 13273       | 15.52         | 13657       | 15.52         | 100     | .3            |     |
|                        | 1/8 Hex           | 5/16        | 13276         | 15.52       |               |         | 100           | .3  |
|                        |                   | 3/8         | 13279         | 16.26       |               |         | 100           | .4  |
| UNC 20 TPI             | 1/2               | 13282       | 17.23         |             |               | 100     | .5            |     |
| UNF 28 TPI             | 5/8               | 13285       | 20.65         |             |               | 100     | .6            |     |
|                        | 3/4               | 13288       | 24.08         |             |               | 100     | .7            |     |
| 5/16"                  | 1/4               | 13309       | 18.30         | 13681       | 18.30         | 100     | .4            |     |
|                        | 5/32 Hex          | 5/16        | 13312         | 16.37       |               | 100     | .5            |     |
|                        | UNC 18 TPI        | 3/8         | 13315         | 16.59       |               | 100     | .6            |     |
|                        | UNF 24 TPI        | 1/2         | 13321         | 17.76       |               |         | 100           | .8  |
| 3/8"                   | 3/8               | 13354       | 19.26         | 13711       | 19.26         | 100     | .8            |     |
|                        | 3/16 Hex          | 1/2         | 13360         | 20.65       | 13714         | 20.65   | 100           | 1.1 |
|                        | UNC 16 TPI        | 5/8         | 13363         | 23.33       |               | 100     | 1.2           |     |
|                        | UNF 24 TPI        | 3/4         | 13366         | 24.93       |               |         | 100           | 1.3 |

# Pricing and Product Information – Inch Sizes



Made in the U.S.A.

## Camcar® Precision Hardened Ground Machine Dowel Pins

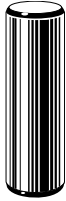

### Product Description:

- Heat-treated alloy steel
- Standard size (.0002 over nominal diameter)
- DFAR compliant

### Pricing Notes:

- Net price per 100
- Bulk pricing available upon request

| Dia. Overall | Length | EDP No. | Price Per 100 | Count Per Box | Wt. Lb./Box |
|--------------|--------|---------|---------------|---------------|-------------|
| 1/16"        | 3/16   | 15766   | 23.98         | 100           | .05         |
|              | 1/4    | 15769   | 24.31         | 100           | .05         |
|              | 3/8    | 15775   | 24.64         | 100           | .1          |
|              | 1/2    | 15781   | 25.74         | 100           | .1          |
|              | 5/8    | 15784   | 25.96         | 100           | .1          |
|              | 3/4    | 15787   | 26.29         | 100           | .1          |
| 3/32"        | 3/16   | 15736   | 22.77         | 100           | .06         |
|              | 1/4    | 15739   | 22.88         | 100           | .06         |
|              | 5/16   | 15742   | 22.99         | 100           | .06         |
|              | 3/8    | 15745   | 23.21         | 100           | .06         |
|              | 7/16   | 15748   | 23.98         | 100           | .1          |
|              | 1/2    | 15751   | 24.42         | 100           | .1          |
|              | 5/8    | 15754   | 24.86         | 100           | .1          |
|              | 3/4    | 15757   | 25.08         | 100           | .1          |
| 1            | 15763  | 25.30   | 100           | .2            |             |
| 1/8"         | 3/8    | 15802   | 23.65         | 100           | .5          |
|              | 1/2    | 15808   | 23.98         | 100           | .5          |
|              | 5/8    | 15811   | 24.19         | 100           | .5          |
|              | 3/4    | 15814   | 25.38         | 100           | .5          |
|              | 7/8    | 15817   | 27.43         | 100           | .5          |
|              | 1      | 15820   | 29.81         | 100           | .5          |
|              | 1-1/4  | 15826   | 30.56         | 100           | .5          |
|              | 1-1/2  | 15832   | 35.32         | 100           | .5          |
|              | 1-3/4  | 15835   | 38.56         | 100           | .5          |
|              | 2      | 15838   | 42.34         | 100           | .5          |
| 3/16"        | 1/2    | 15841   | 25.49         | 100           | .5          |
|              | 5/8    | 15844   | 26.14         | 100           | .5          |
|              | 3/4    | 15847   | 28.08         | 100           | .5          |
|              | 7/8    | 15850   | 29.81         | 100           | .5          |
|              | 1      | 15853   | 31.10         | 100           | 1.0         |
|              | 1-1/4  | 15859   | 34.56         | 100           | 1.0         |
|              | 1-1/2  | 15865   | 38.23         | 100           | 1.0         |
|              | 1-3/4  | 15868   | 42.44         | 100           | 1.5         |
|              | 2      | 15871   | 47.20         | 100           | 1.5         |
| 1/4"         | 1/2    | 15874   | 28.62         | 100           | .5          |
|              | 5/8    | 15877   | 30.13         | 100           | 1.0         |
|              | 3/4    | 15880   | 30.67         | 100           | 1.0         |
|              | 7/8    | 15883   | 33.48         | 100           | 1.5         |
|              | 1      | 15886   | 34.34         | 100           | 1.5         |
|              | 1-1/4  | 15892   | 37.37         | 100           | 2.0         |
|              | 1-1/2  | 15898   | 41.90         | 100           | 2.0         |
|              | 1-3/4  | 15901   | 47.41         | 100           | 2.5         |
|              | 2      | 15904   | 52.49         | 100           | 3.0         |
|              | 2-1/4  | 15907   | 64.04         | 100           | 3.5         |
| 2-1/2        | 15910  | 65.23   | 100           | 3.5           |             |

| Dia. Overall | Length | EDP No. | Price Per 100 | Count Per Box | Wt. Lb./Box |
|--------------|--------|---------|---------------|---------------|-------------|
| 5/16"        | 1/2    | 15919   | 35.21         | 100           | 1.0         |
|              | 5/8    | 15922   | 36.94         | 100           | 1.5         |
|              | 3/4    | 15925   | 38.12         | 100           | 1.5         |
|              | 7/8    | 15928   | 39.07         | 100           | 2.0         |
|              | 1      | 15931   | 39.20         | 100           | 2.0         |
|              | 1-1/4  | 15937   | 43.42         | 100           | 3.0         |
|              | 1-1/2  | 15943   | 48.60         | 100           | 3.5         |
|              | 1-3/4  | 15946   | 58.97         | 100           | 4.0         |
|              | 2      | 15952   | 63.61         | 100           | 4.5         |
|              | 2-1/2  | 15958   | 79.16         | 100           | 5.5         |
|              | 3      | 15961   | 94.61         | 100           | 6.5         |
|              | 3/8"   | 1/2     | 15967         | 43.20         | 20          |
| 5/8          |        | 15970   | 44.82         | 20            | .4          |
| 3/4          |        | 15973   | 46.01         | 20            | .5          |
| 7/8          |        | 15976   | 47.20         | 20            | .6          |
| 1            |        | 15979   | 47.84         | 20            | .7          |
| 1-1/4        |        | 15985   | 51.30         | 20            | .8          |
| 1-1/2        |        | 15991   | 58.32         | 20            | 1.0         |
| 1-3/4        |        | 15994   | 66.96         | 20            | 1.1         |
| 2            |        | 15997   | 73.66         | 20            | 1.3         |
| 2-1/4        |        | 16000   | 80.57         | 20            | 1.4         |
| 2-1/2        | 16003  | 91.80   | 20            | 1.6           |             |
| 3            | 16009  | 113.29  | 20            | 1.9           |             |
| 7/16"        | 1      | 16021   | 88.88         | 20            | .9          |
|              | 1-1/4  | 16024   | 95.80         | 20            | 1.0         |
|              | 1-1/2  | 16027   | 102.71        | 20            | 1.3         |
|              | 2      | 16033   | 116.54        | 20            | 2.1         |
| 1/2"         | 3/4    | 16051   | 95.15         | 20            | .8          |
|              | 1      | 16057   | 100.76        | 20            | 1.1         |
|              | 1-1/4  | 16060   | 107.35        | 20            | 1.4         |
|              | 1-1/2  | 16063   | 114.05        | 20            | 1.7         |
|              | 1-3/4  | 16066   | 121.39        | 20            | 2.0         |
|              | 2      | 16069   | 135.00        | 20            | 2.2         |
|              | 2-1/4  | 16072   | 151.74        | 20            | 2.5         |
|              | 2-1/2  | 16075   | 162.65        | 20            | 2.8         |
|              | 3      | 16081   | 193.54        | 20            | 3.3         |
| 5/8"         | 1-1/4  | 16099   | 172.70        | 10            | 1.1         |
|              | 1-1/2  | 16102   | 179.63        | 10            | 1.3         |
|              | 1-3/4  | 16106   | 208.34        | 10            | 1.5         |
|              | 2      | 16108   | 225.50        | 10            | 1.8         |
|              | 2-1/2  | 16114   | 265.43        | 10            | 2.3         |
|              | 3      | 16120   | 314.93        | 10            | 2.6         |

# Pricing and Product Information – Metric Sizes



Made in the U.S.A.

## Camcar® Socket Head Cap Screws



### Product Description:

- Class 12.9
- Standard package
- DFAR compliant

### Pricing Notes:

- Net price per 100 available in listed thread series only
- Bulk pricing upon request

| Diameter, Thread Pitch, Key Size    | Length Under Head | Hex EDP No. | Price Per 100 | Ct./Box | Weight Lbs/Box |
|-------------------------------------|-------------------|-------------|---------------|---------|----------------|
| <b>M3</b><br>0.5 pitch<br>2.5mm Hex | 6                 | 60003       | 18.90         | 100     | 0.071          |
|                                     | 8                 | 60005       | 17.01         | 100     | 0.080          |
|                                     | 10                | 60007       | 17.22         | 100     | 0.088          |
|                                     | 12                | 60009       | 17.96         | 100     | 0.096          |
|                                     | 16                | 60011       | 18.27         | 100     | 0.116          |
|                                     | 20                | 60013       | 18.90         | 100     | 0.138          |
|                                     | 25                | 60015       | 22.58         | 100     | 0.161          |
| <b>M4</b><br>0.7 pitch<br>3mm Hex   | 8                 | 60025       | 17.22         | 100     | 0.165          |
|                                     | 10                | 60027       | 17.54         | 100     | 0.180          |
|                                     | 12                | 60029       | 18.27         | 100     | 0.195          |
|                                     | 16                | 60031       | 19.11         | 100     | 0.225          |
|                                     | 20                | 60033       | 20.48         | 100     | 0.265          |
|                                     | 25                | 60035       | 23.10         | 100     | 0.315          |
|                                     | 30                | 60037       | 23.26         | 100     | 0.365          |
|                                     | 35                | 60039       | 24.47         | 100     | 0.415          |
|                                     | 40                | 60041       | 29.04         | 100     | 0.465          |
|                                     | 45                | 60043       | 32.32         | 100     | 0.515          |
| 50                                  | 60045             | 37.13       | 100           | 0.565   |                |
| <b>M5</b><br>0.8 pitch<br>4mm Hex   | 8                 | 60047       | 21.53         | 100     | 0.245          |
|                                     | 10                | 60049       | 18.90         | 100     | 0.270          |
|                                     | 12                | 60051       | 20.48         | 100     | 0.295          |
|                                     | 16                | 60053       | 21.42         | 100     | 0.345          |
|                                     | 20                | 60055       | 22.05         | 100     | 0.401          |
|                                     | 25                | 60057       | 22.68         | 100     | 0.478          |
|                                     | 30                | 60059       | 23.84         | 100     | 0.555          |
| <b>M6</b><br>1.0 pitch<br>5mm Hex   | 10                | 60071       | 18.69         | 100     | 0.470          |
|                                     | 12                | 60073       | 19.32         | 100     | 0.507          |
|                                     | 16                | 60075       | 20.48         | 100     | 0.575          |
|                                     | 20                | 60077       | 21.42         | 100     | 0.653          |
|                                     | 25                | 60079       | 22.89         | 100     | 0.759          |
|                                     | 30                | 60081       | 24.57         | 100     | 0.870          |
|                                     | 35                | 60083       | 28.35         | 100     | 0.991          |
|                                     | 40                | 60085       | 29.93         | 100     | 1.10           |
| 50                                  | 60089             | 33.63       | 100           | 1.32    |                |

| Diameter, Thread Pitch, Key Size     | Length Under Head | Hex EDP No. | Price Per 100 | Ct./Box | Weight Lbs/Box |
|--------------------------------------|-------------------|-------------|---------------|---------|----------------|
| <b>M8</b><br>1.25 pitch<br>6mm Hex   | 12                | 60103       | 24.80         | 100     | 1.08           |
|                                      | 16                | 60105       | 25.33         | 100     | 1.21           |
|                                      | 20                | 60107       | 26.50         | 100     | 1.34           |
|                                      | 25                | 60109       | 29.26         | 100     | 1.50           |
|                                      | 30                | 60111       | 31.16         | 100     | 1.69           |
|                                      | 35                | 60113       | 33.92         | 100     | 1.89           |
|                                      | 40                | 60115       | 35.72         | 100     | 2.09           |
|                                      | 50                | 60119       | 43.13         | 100     | 2.49           |
| <b>M10</b><br>1.5 pitch<br>8mm Hex   | 16                | 60133       | 37.52         | 100     | 2.09           |
|                                      | 20                | 60135       | 37.95         | 100     | 2.29           |
|                                      | 25                | 60137       | 38.90         | 100     | 2.54           |
|                                      | 30                | 60139       | 40.70         | 100     | 2.79           |
|                                      | 35                | 60141       | 44.52         | 100     | 3.10           |
|                                      | 40                | 60143       | 48.02         | 100     | 3.41           |
|                                      | 45                | 60145       | 50.88         | 50      | 3.72           |
|                                      | 50                | 60147       | 54.38         | 50      | 4.03           |
|                                      | 60                | 60151       | 67.63         | 50      | 4.65           |
|                                      | 70                | 60155       | 87.45         | 50      | 5.27           |
| <b>M12</b><br>1.75 pitch<br>10mm Hex | 20                | 60165       | 76.32         | 50      | 3.21           |
|                                      | 25                | 60167       | 79.29         | 50      | 3.57           |
|                                      | 30                | 60169       | 81.62         | 50      | 3.93           |
|                                      | 35                | 60171       | 91.58         | 50      | 4.29           |
|                                      | 40                | 60173       | 105.68        | 50      | 4.73           |
|                                      | 45                | 60175       | 115.12        | 50      | 5.17           |
|                                      | 50                | 60177       | 122.01        | 50      | 5.61           |
|                                      | 55                | 60179       | 132.50        | 25      | 6.05           |
| 60                                   | 60181             | 141.09      | 25            | 6.49    |                |
| <b>M16</b><br>2.0 pitch<br>14mm Hex  | 30                | 60199       | 176.81        | 25      | 7.78           |
|                                      | 35                | 60201       | 194.40        | 25      | 8.44           |
|                                      | 40                | 60203       | 196.31        | 25      | 9.10           |
|                                      | 45                | 60205       | 216.03        | 25      | 9.76           |
|                                      | 50                | 60207       | 223.07        | 25      | 10.6           |
|                                      | 55                | 60209       | 240.94        | 25      | 11.4           |
|                                      | 60                | 60211       | 249.95        | 25      | 12.2           |

# Pricing and Product Information – Metric Sizes



Made in  
the U.S.A.

## Camcar® Socket Head Button Head Screws

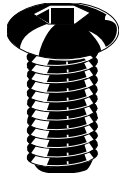

### Product Description:

- Heat-treated alloy steel
- DFAR compliant

### Pricing Notes:

- Net price per 100 available in listed thread series only
- Bulk pricing upon request

| Dia., Thread Pitch, Key Size         | Length Under Head | Hex EDP No. | Price Per 100 | Ct./Box | Weight Lb/Box |
|--------------------------------------|-------------------|-------------|---------------|---------|---------------|
| <b>M3</b><br>0.50 pitch<br>2mm Hex   | 6                 | 77109       | 14.10         | 100     | 0.048         |
|                                      | 8                 | 60405       | 14.84         | 100     | 0.050         |
|                                      | 10                | 60407       | 15.16         | 100     | 0.064         |
|                                      | 12                | 60409       | 15.90         | 100     | 0.073         |
|                                      | 16                | 77112       | 17.00         | 100     | 0.19          |
| <b>M4</b><br>0.70 pitch<br>2.5mm Hex | 8                 | 60411       | 16.75         | 100     | 0.118         |
|                                      | 10                | 60413       | 17.38         | 100     | 0.136         |
|                                      | 12                | 60415       | 17.91         | 100     | 0.154         |
|                                      | 16                | 60417       | 19.61         | 100     | 0.195         |
| <b>M5</b><br>0.80 pitch<br>3mm Hex   | 10                | 60419       | 17.38         | 100     | 0.218         |
|                                      | 12                | 60421       | 17.81         | 100     | 0.245         |
|                                      | 16                | 60423       | 19.61         | 100     | 0.290         |
|                                      | 20                | 77115       | 22.10         | 100     | 0.44          |
|                                      | 25                | 77118       | 24.60         | 100     | 0.55          |
|                                      | 30                | 77121       | 26.40         | 100     | 0.61          |
| <b>M6</b><br>1.00 pitch<br>4mm Hex   | 10                | 60431       | 18.02         | 100     | 0.295         |
|                                      | 12                | 60433       | 18.66         | 100     | 0.334         |
|                                      | 16                | 60435       | 20.46         | 100     | 0.408         |
|                                      | 20                | 60437       | 21.73         | 100     | 0.476         |
|                                      | 25                | 60439       | 24.80         | 100     | 0.562         |
|                                      | 30                | 77124       | 27.10         | 100     | 0.648         |

| Dia., Thread Pitch, Key Size        | Length Under Head | Hex EDP No. | Price Per 100 | Ct./Box | Weight Lb/Box |
|-------------------------------------|-------------------|-------------|---------------|---------|---------------|
| <b>M8</b><br>1.25 pitch<br>5mm Hex  | 10                | 77127       | 24.50         | 100     | 0.512         |
|                                     | 12                | 60445       | 25.02         | 100     | 0.535         |
|                                     | 16                | 60447       | 25.33         | 100     | 0.699         |
|                                     | 20                | 60449       | 25.55         | 100     | 0.848         |
|                                     | 25                | 60451       | 29.47         | 100     | 1.04          |
|                                     | 30                | 60453       | 32.86         | 100     | 1.26          |
|                                     | 35                | 77130       | 33.90         | 100     | 1.49          |
|                                     | 40                | 77133       | 36.10         | 100     | 1.71          |
| <b>M10</b><br>1.50 pitch<br>6mm Hex | 16                | 77136       | 37.20         | 100     | 1.41          |
|                                     | 20                | 60459       | 38.58         | 100     | 1.66          |
|                                     | 25                | 60461       | 44.94         | 100     | 1.91          |
|                                     | 30                | 60463       | 51.30         | 100     | 2.15          |
|                                     | 35                | 77139       | 53.60         | 100     | 2.39          |
|                                     | 40                | 77142       | 55.20         | 100     | 2.63          |
| <b>M12</b><br>1.75 pitch<br>8mm Hex | 16                | 77145       | 79.30         | 50      | 1.8           |
|                                     | 20                | 77148       | 83.10         | 50      | 2.2           |
|                                     | 25                | 77151       | 86.00         | 50      | 2.56          |
|                                     | 30                | 77154       | 89.30         | 50      | 2.8           |
|                                     | 35                | 77157       | 93.60         | 50      | 3.12          |
|                                     | 40                | 77160       | 96.60         | 50      | 3.45          |
|                                     | 50                | 77163       | 102.00        | 50      | 3.69          |

# Pricing and Product Information – Metric Sizes



Made in the U.S.A.

## Camcar® Socket Countersunk Flat Head Screws

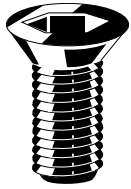

### Product Description:

- Heat-treated alloy steel
- DFAR compliant

### Pricing Notes:

- Net price per 100
- Bulk pricing upon request

| Dia., Thread Pitch, Key Size         | Length Under Head | Hex EDP No. | Price Per 100 | Ct./Box | Weight Lb/Box |
|--------------------------------------|-------------------|-------------|---------------|---------|---------------|
| <b>M3</b><br>0.50 pitch<br>2mm Hex   | 6                 | 77000       | 19.50         | 100     | 0.06          |
|                                      | 8                 | 60277       | 20.14         | 100     | 0.062         |
|                                      | 10                | 60279       | 21.62         | 100     | 0.071         |
|                                      | 12                | 60281       | 22.26         | 100     | 0.080         |
|                                      | 16                | 60283       | 23.74         | 100     | 0.098         |
|                                      | 20                | 77003       | 25.10         | 100     | 0.12          |
|                                      | 25                | 77006       | 26.70         | 100     | 0.15          |
| <b>M4</b><br>0.70 pitch<br>2.5mm Hex | 8                 | 60287       | 21.62         | 100     | 0.105         |
|                                      | 10                | 60289       | 22.15         | 100     | 0.120         |
|                                      | 12                | 60291       | 23.11         | 100     | 0.135         |
|                                      | 16                | 60293       | 23.74         | 100     | 0.165         |
|                                      | 20                | 77009       | 24.80         | 100     | 0.20          |
|                                      | 25                | 77012       | 25.70         | 100     | 0.23          |
|                                      | 30                | 77015       | 27.10         | 100     | 0.26          |
| <b>M5</b><br>0.80 pitch<br>3mm Hex   | 35                | 77018       | 29.30         | 100     | 0.29          |
|                                      | 40                | 77021       | 31.10         | 100     | 0.32          |
|                                      | 8                 | 77024       | 24.00         | 100     | 0.19          |
|                                      | 10                | 60303       | 24.80         | 100     | 0.207         |
|                                      | 12                | 60305       | 25.02         | 100     | 0.231         |
|                                      | 16                | 60307       | 25.55         | 100     | 0.277         |
|                                      | 20                | 60309       | 26.08         | 100     | 0.335         |
| <b>M6</b><br>1.00 pitch<br>4mm Hex   | 25                | 60311       | 29.79         | 100     | 0.404         |
|                                      | 30                | 77027       | 31.60         | 100     | 0.47          |
|                                      | 35                | 77030       | 33.40         | 100     | 0.54          |
|                                      | 40                | 77033       | 36.90         | 100     | 0.61          |
|                                      | 50                | 77036       | 41.10         | 100     | 0.68          |
|                                      | 8                 | 77039       | 22.90         | 100     | 0.30          |
|                                      | 10                | 77042       | 23.60         | 100     | 0.31          |
| <b>M8</b><br>1.25 pitch<br>5mm Hex   | 12                | 60319       | 24.38         | 100     | 0.344         |
|                                      | 16                | 60321       | 25.02         | 100     | 0.414         |
|                                      | 20                | 60323       | 27.03         | 100     | 0.484         |
|                                      | 25                | 60325       | 31.16         | 100     | 0.571         |
|                                      | 30                | 60327       | 36.15         | 100     | 0.682         |
|                                      | 35                | 60329       | 41.45         | 100     | 0.793         |
|                                      | 40                | 77045       | 43.80         | 100     | 0.90          |
|                                      | 45                | 77048       | 45.60         | 100     | 1.02          |
|                                      | 50                | 77051       | 48.10         | 100     | 1.13          |

| Dia., Thread Pitch, Key Size        | Length Under Head                   | Hex EDP No. | Price Per 100 | Ct./Box | Weight Lb/Box |
|-------------------------------------|-------------------------------------|-------------|---------------|---------|---------------|
| <b>M8</b><br>1.25 pitch<br>5mm Hex  | 10                                  | 77054       | 35.00         | 100     | 0.69          |
|                                     | 12                                  | 77057       | 36.10         | 100     | 0.80          |
|                                     | 16                                  | 60337       | 36.89         | 100     | 0.92          |
|                                     | 20                                  | 60339       | 37.74         | 100     | 1.04          |
|                                     | 25                                  | 60341       | 39.22         | 100     | 1.19          |
|                                     | 30                                  | 60343       | 41.45         | 100     | 1.34          |
|                                     | 35                                  | 60345       | 45.37         | 100     | 1.54          |
|                                     | 40                                  | 60347       | 45.65         | 100     | 1.83          |
|                                     | 45                                  | 77060       | 46.10         | 100     | 1.94          |
|                                     | 50                                  | 77063       | 49.30         | 100     | 2.14          |
|                                     | 60                                  | 77066       | 57.10         | 100     | 2.34          |
|                                     | 70                                  | 77069       | 66.00         | 100     | 2.54          |
|                                     | <b>M10</b><br>1.50 pitch<br>6mm Hex | 16          | 77072         | 45.10   | 100           |
| 20                                  |                                     | 60351       | 47.28         | 100     | 1.63          |
| 25                                  |                                     | 60353       | 47.70         | 100     | 1.88          |
| 30                                  |                                     | 60355       | 51.73         | 100     | 2.13          |
| 35                                  |                                     | 77075       | 54.60         | 100     | 2.38          |
| 40                                  |                                     | 77078       | 57.10         | 100     | 2.69          |
| 45                                  |                                     | 77082       | 60.90         | 100     | 3.00          |
| <b>M12</b><br>1.75 pitch<br>8mm Hex | 50                                  | 77085       | 64.10         | 100     | 3.31          |
|                                     | 60                                  | 77088       | 72.00         | 100     | 3.62          |
|                                     | 70                                  | 77091       | 81.00         | 100     | 3.93          |
|                                     | 20                                  | 77094       | 96.40         | 50      | 2.42          |
|                                     | 25                                  | 77097       | 99.30         | 50      | 2.78          |
|                                     | 30                                  | 77100       | 106.10        | 50      | 3.14          |
|                                     | 35                                  | 77103       | 109.80        | 50      | 3.50          |
| 40                                  | 77106                               | 116.40      | 50            | 3.86    |               |

# Pricing and Product Information – Drive Tools



Made in the U.S.A.

## TORX PLUS® Drive Tools

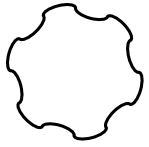

### Pricing Notes:

- All prices are net each



## TORX PLUS Insert Bits

| Hex Shank | Size  | Overall Length | EDP No.      | Quantity Break Price Per Each |         |          |           |
|-----------|-------|----------------|--------------|-------------------------------|---------|----------|-----------|
|           |       |                |              | <100                          | 101-500 | 501-1000 | Over 1000 |
| 1/4"      | 1IP   | 1              | 357-P0101-61 | 20.62                         | 18.32   | 17.19    | 15.77     |
|           | 2IP   | 1              | 357-P0201-61 | 19.64                         | 17.45   | 16.37    | 15.02     |
|           | 3IP   | 1              | 357-P0301-61 | 18.70                         | 16.62   | 15.59    | 14.30     |
|           | 4IP   | 1              | 357-P0401-61 | 12.28                         | 11.22   | 10.69    | 9.88      |
|           | 5IP   | 1              | 357-P0501-61 | 10.52                         | 9.70    | 9.10     | 8.73      |
|           | 6IP   | 1              | 357-P0601-61 | 9.24                          | 8.03    | 7.48     | 7.36      |
|           | 7IP   | 1              | 357-P0701-61 | 7.48                          | 6.69    | 6.16     | 6.02      |
|           | 8IP   | 1              | 357-P0801-61 | 7.48                          | 6.69    | 6.16     | 6.02      |
|           | 10IP  | 1              | 357-P1001-61 | 4.15                          | 3.74    | 3.47     | 3.36      |
|           | 15IP  | 1              | 357-P1501-61 | 4.15                          | 3.74    | 3.47     | 3.36      |
|           | 20IP  | 1              | 357-P2001-61 | 4.15                          | 3.74    | 3.47     | 3.36      |
|           | 25IP  | 1              | 357-P2501-61 | 4.15                          | 3.74    | 3.47     | 3.36      |
|           | 27IP  | 1              | 357-P2701-61 | 4.15                          | 3.74    | 3.47     | 3.36      |
|           | 30IP  | 1              | 357-P3001-61 | 4.15                          | 3.74    | 3.47     | 3.36      |
|           | 40IP  | 1              | 357-P4001-61 | 4.15                          | 3.74    | 3.47     | 3.36      |
|           | 5/16" | 30IP           | 1-1/4        | 357-P3002-01                  | 4.15    | 3.74     | 3.47      |
| 40IP      |       | 1-1/4          | 357-P4002-01 | 4.15                          | 3.74    | 3.47     | 3.36      |
| 45IP      |       | 1-1/4          | 357-P4502-01 | 4.80                          | 4.29    | 4.02     | 3.74      |
| 5/8"      | 50IP  | 1-1/2          | 357-P5002-41 | 74.36                         | 71.94   | 61.38    | 58.30     |
|           | 55IP  | 1-1/2          | 357-P5502-41 | 74.36                         | 71.94   | 61.38    | 58.30     |
|           | 60IP  | 1-1/2          | 357-P6002-41 | 74.36                         | 71.94   | 61.38    | 58.30     |
|           | 70IP  | 1-1/2          | 357-P7002-41 | 74.36                         | 71.94   | 61.38    | 58.30     |
| 7/8"      | 80IP  | 2              | 357-P8003-21 | 96.25                         | 93.50   | 90.97    | 79.20     |

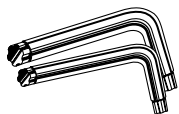

## TORX PLUS Short Arm Keys\*

| Size | Part Number | Price Each |
|------|-------------|------------|
| 10IP | 356-P010-01 | 4.40       |
| 15IP | 356-P015-01 | 4.40       |
| 20IP | 356-P020-01 | 4.68       |
| 25IP | 356-P025-01 | 4.80       |
| 27IP | 356-P027-01 | 5.23       |
| 30IP | 356-P030-01 | 5.36       |
| 40IP | 356-P040-01 | 5.75       |
| 45IP | 356-P045-01 | 6.16       |
| 50IP | 356-P050-01 | 6.71       |

\*25 pieces per box

## TORX PLUS Power Bits (1/4" Shank)



| Size | Overall Length | EDP Number   | Quantity Break Price Per Each |         |          |           |
|------|----------------|--------------|-------------------------------|---------|----------|-----------|
|      |                |              | <100                          | 101-500 | 501-1000 | Over 1000 |
| 6IP  | 2              | 357-P0603-21 | 11.77                         | 10.45   | 10.03    | 9.49      |
| 7IP  | 2              | 357-P0703-21 | 11.77                         | 10.45   | 10.03    | 9.49      |
| 8IP  | 2              | 357-P0803-21 | 11.77                         | 10.45   | 10.03    | 9.49      |
| 10IP | 2              | 357-P1003-21 | 8.80                          | 8.03    | 7.65     | 7.37      |
| 15IP | 2              | 357-P1503-21 | 8.80                          | 8.03    | 7.65     | 7.37      |
| 20IP | 2              | 357-P2003-21 | 8.80                          | 8.03    | 7.65     | 7.37      |
| 25IP | 2              | 357-P2503-21 | 8.80                          | 8.03    | 7.65     | 7.37      |
| 27IP | 2              | 357-P2703-21 | 8.80                          | 8.03    | 7.65     | 7.37      |
| 30IP | 2              | 357-P3003-21 | 8.80                          | 8.03    | 7.65     | 7.37      |
| 40IP | 2              | 357-P4003-21 | 8.80                          | 8.03    | 7.65     | 7.37      |
| 6IP  | 2-3/4          | 357-P0604-41 | 12.16                         | 10.69   | 9.94     | 9.76      |
| 7IP  | 2-3/4          | 357-P0704-41 | 12.16                         | 10.69   | 9.94     | 9.76      |
| 8IP  | 2-3/4          | 357-P0804-41 | 12.16                         | 10.69   | 9.94     | 9.76      |
| 10IP | 2-3/4          | 357-P1004-41 | 9.35                          | 8.31    | 7.76     | 7.48      |
| 15IP | 2-3/4          | 357-P1504-41 | 9.35                          | 8.31    | 7.76     | 7.48      |
| 20IP | 2-3/4          | 357-P2004-41 | 9.35                          | 8.31    | 7.76     | 7.48      |
| 25IP | 2-3/4          | 357-P2504-41 | 9.35                          | 8.31    | 7.76     | 7.48      |
| 27IP | 2-3/4          | 357-P2704-41 | 9.35                          | 8.31    | 7.76     | 7.48      |
| 30IP | 2-3/4          | 357-P3004-41 | 9.35                          | 8.31    | 7.76     | 7.48      |
| 40IP | 2-3/4          | 357-P4004-41 | 9.35                          | 8.31    | 7.76     | 7.48      |
| 6IP  | 3-1/2          | 357-P0605-61 | 14.03                         | 12.43   | 12.05    | 11.66     |
| 7IP  | 3-1/2          | 357-P0705-61 | 14.03                         | 12.43   | 12.05    | 11.66     |
| 8IP  | 3-1/2          | 357-P0805-61 | 14.03                         | 12.43   | 12.05    | 11.66     |
| 10IP | 3-1/2          | 357-P1005-61 | 11.09                         | 9.77    | 9.35     | 9.08      |
| 15IP | 3-1/2          | 357-P1505-61 | 11.09                         | 9.77    | 9.35     | 9.08      |
| 20IP | 3-1/2          | 357-P2005-61 | 11.09                         | 9.77    | 9.35     | 9.08      |
| 25IP | 3-1/2          | 357-P2505-61 | 11.09                         | 9.77    | 9.35     | 9.08      |
| 27IP | 3-1/2          | 357-P2705-61 | 11.09                         | 9.77    | 9.35     | 9.08      |
| 30IP | 3-1/2          | 357-P3005-61 | 11.09                         | 9.77    | 9.35     | 9.08      |
| 8IP  | 6              | 357-P0809-61 | 14.19                         | 12.65   | 12.21    | 11.77     |
| 10IP | 6              | 357-P1009-61 | 14.19                         | 12.65   | 12.21    | 11.77     |
| 15IP | 6              | 357-P1509-61 | 14.19                         | 12.65   | 12.21    | 11.77     |
| 20IP | 6              | 357-P2009-61 | 14.19                         | 12.65   | 12.21    | 11.77     |
| 25IP | 6              | 357-P2509-61 | 14.19                         | 12.65   | 12.21    | 11.77     |
| 27IP | 6              | 357-P2709-61 | 14.19                         | 12.65   | 12.21    | 11.77     |
| 30IP | 6              | 357-P3009-61 | 14.19                         | 12.65   | 12.21    | 11.77     |



## TORX PLUS Tamper-Resistant Insert Bits

| Hex Shank | Size  | Overall Length | EDP Number   | Price Per Each                          |
|-----------|-------|----------------|--------------|---|
| 1/4"      | 10IPR | 1              | 357-P1091-61 | Call For Current Pricing & Availability |
|           | 15IPR | 1              | 357-P1591-61 | Call For Current Pricing & Availability |
|           | 20IPR | 1              | 357-P2091-61 | Call For Current Pricing & Availability |
|           | 25IPR | 1              | 357-P2591-61 | Call For Current Pricing & Availability |
|           | 27IPR | 1              | 357-P2791-61 | Call For Current Pricing & Availability |
|           | 30IPR | 1              | 357-P3091-61 | Call For Current Pricing & Availability |
|           | 40IPR | 1              | 357-P4091-61 | Call For Current Pricing & Availability |

# Pricing and Product Information – Tools



Made in the U.S.A.

## TORX® Drive Tools

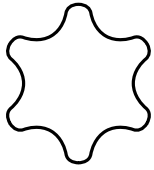

### Pricing Notes:

- All prices are net each



### TORX Insert Bits

| Hex Shank | TORX Size | Overall Length | EDP Number   | Price Each |
|-----------|-----------|----------------|--------------|------------|
| 1/4"      | T-1       | 1              | 357-00101-61 | 17.66      |
|           | T-2       | 1              | 357-00201-61 | 17.66      |
|           | T-3       | 1              | 357-00301-61 | 15.13      |
|           | T-4       | 1              | 357-00401-61 | 11.77      |
|           | T-5       | 1              | 357-00501-61 | 11.13      |
|           | T-6       | 1              | 357-00601-61 | 8.58       |
|           | T-7       | 1              | 357-00701-61 | 3.61       |
|           | T-8       | 1              | 357-00801-61 | 3.61       |
|           | T-9       | 1              | 357-00901-61 | 3.61       |
|           | T-10      | 1              | 357-01001-61 | 2.00       |
|           | T-15      | 1              | 357-01501-61 | 2.00       |
|           | T-20      | 1              | 357-02001-61 | 2.00       |
|           | T-25      | 1              | 357-02501-61 | 2.00       |
|           | T-27      | 1              | 357-02701-61 | 2.00       |
| T-30      | 1         | 357-03001-61   | 2.00         |            |
| T-40      | 1         | 357-04001-61   | 2.13         |            |
| 5/16"     | T-30      | 1-1/4          | 357-03002-01 | 3.36       |
|           | T-40      | 1-1/4          | 357-04002-01 | 3.88       |
|           | T-45      | 1-1/4          | 357-04502-01 | 4.55       |
|           | T-55      | 1-1/2          | 357-05502-41 | 55.88      |
|           | T-60      | 1-1/2          | 357-06002-41 | 55.88      |
| 5/8"      | T-70      | 1-1/2          | 357-07002-41 | 55.88      |
| 7/8"      | T-90      | 2              | 357-09003-21 | 69.41      |
|           | T-100     | 2              | 357-10003-21 | 71.94      |

### TORX Drive System Interchangability Table

| TORX Size | Socket Head Cap Screw | Button Head Cap Screw | Flat Head Cap Screw | Pressure Plug | Socket Set Screw |
|-----------|-----------------------|-----------------------|---------------------|---------------|------------------|
| T-7       |                       |                       |                     |               | 6                |
| T-8       |                       | 4                     |                     |               | 8                |
| T-9       |                       |                       |                     |               |                  |
| T-10      | 4,5                   | 6                     | 4,5                 |               | 10               |
| T-15      | 6                     | 8                     | 6                   |               | 1/4              |
| T-20      |                       |                       | 8                   |               |                  |
| T-25      | 8                     | 10                    | 10                  |               |                  |
| T-27      | 10                    | 1/4                   |                     | 1/16          | 5/16             |
| T-30      | 1/4                   |                       | 1/4                 | 1/8           | 3/8              |
| T-40      |                       | 5/16                  | 5/16                |               |                  |
| T-45      | 5/16                  | 3/8                   | 3/8                 | 1/4           | 1/2              |
| T-50      | 3/8                   |                       | 7/16, 1/2           |               |                  |
| T-55      | 7/16, 1/2             | 1/2                   | 5/8                 | 3/8           |                  |
| T-60      | 5/8                   | 3/4                   |                     |               |                  |
| T-70      | 5/8                   |                       |                     |               |                  |
| T-90      | 3/4                   |                       |                     |               |                  |
| T-100     |                       |                       |                     |               |                  |

### TORX Sockets

| TORX Size | Drive Size | EDP Number   | Price Each |
|-----------|------------|--------------|------------|
| E-5       | 1/4        | 359-00500-41 | 16.83      |
| E-8       | 1/4        | 359-00800-41 | 17.38      |
| E-18      | 1/2        | 359-01800-81 | 30.25      |
| E-20      | 1/2        | 359-02000-81 | 30.58      |
| E-20      | 3/4        | 359-02001-21 | 44.33      |
| E-22      | 1          | 359-02201-61 | 207.21     |
| E-32      | 3/4        | 359-03201-21 | 65.67      |
| E-36      | 1          | 359-03601-61 | 223.41     |



### TORX Short Arm Keys

| TORX Size | EDP Number  | Price Each |
|-----------|-------------|------------|
| T-7       | 356-0007-01 | 4.18       |
| T-8       | 356-0008-01 | 4.18       |
| T-9       | 356-0009-01 | 4.18       |
| T-10      | 356-0010-01 | 1.49       |
| T-15      | 356-0015-01 | 1.49       |
| T-20      | 356-0020-01 | 1.62       |
| T-25      | 356-0025-01 | 1.76       |
| T-27      | 356-0027-01 | 1.87       |
| T-30      | 356-0030-01 | 2.31       |

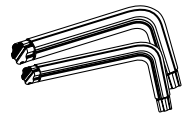

### TORXalign® Bits (1/4" Hex Shank, Insert Bit)

| TORX Size | Overall Length | EDP Number   | Price Each |
|-----------|----------------|--------------|------------|
| T-6       | 1              | 357-00611-61 | 8.69       |
| T-7       | 1              | 357-00711-61 | 8.69       |
| T-8       | 1              | 357-00811-61 | 8.69       |
| T-9       | 1              | 357-00911-61 | 7.92       |
| T-10      | 1              | 357-01011-61 | 6.93       |
| T-15      | 1              | 357-01511-61 | 6.93       |
| T-20      | 1              | 357-02011-61 | 6.93       |
| T-25      | 1              | 357-02511-61 | 6.93       |
| T-27      | 1              | 357-02711-61 | 6.93       |
| T-30      | 1              | 357-03011-61 | 6.93       |

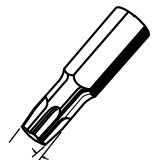

### Tamper-Resistant TORX Insert Bits

| TORX Size | Overall Length | EDP Number   | Price Each |
|-----------|----------------|--------------|------------|
| T-8       | 1              | 357-00891-61 | 10.82      |
| T-10      | 1              | 357-01091-61 | 8.42       |
| T-15      | 1              | 357-01591-61 | 8.42       |
| T-20      | 1              | 357-02091-61 | 8.42       |
| T-25      | 1              | 357-02591-61 | 8.42       |
| T-27      | 1              | 357-02791-61 | 8.42       |
| T-30      | 1              | 357-03091-61 | 8.42       |
| T-40      | 1              | 357-04091-61 | 8.42       |

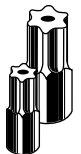

### Adaptors

| TORX Size | Drive Size | EDP Number   | Price Each |
|-----------|------------|--------------|------------|
| 3/4       | 5/8 Hex    | 359-07201-21 | 34.43      |
| 3/4       | 7/8 Hex    | 359-07281-21 | 47.94      |
| 1         | 5/8 Hex    | 359-0820L-61 | 108.45     |
| 1         | 7/8 Hex    | 359-08281-61 | 61.67      |

# Technical and Torque Data – Inch Sizes

## Camcar® Socket Head Cap Screws

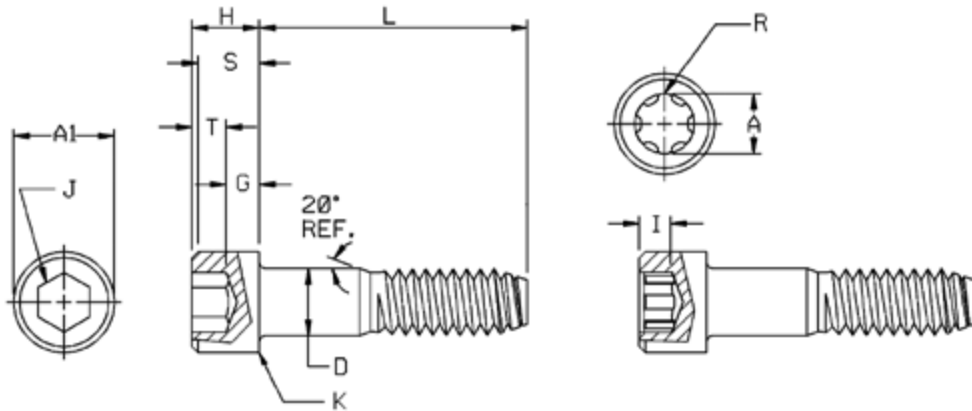

### Dimensions of Hex and TORX PLUS® Drive Socket Head Cap Screws

| Nominal Size<br>or Basic Screw<br>Diameter | D<br>Body Diameter |        | A1<br>Head<br>Diameter |       | H<br>Head Height |       | S                              | R             | A                   | I                | J                  |      | T                         | G                      | K                               |       |
|--|--------------------|--------|------------------------|-------|------------------|-------|--------------------------------|---------------|---------------------|------------------|--------------------|------|---------------------------|------------------------|---------------------------------|-------|
|  | Max.               | Min.   | Max.                   | Min.  | Max.             | Min.  | Head<br>Side<br>Height<br>Min. | TORX PLUS     |                     |                  | Hex<br>Socket Size |      | Hex Key<br>Engag.<br>Min. | Wall<br>Thick.<br>Min. | Chamfer<br>or<br>Radius<br>Max. |       |
|  |                    |        |                        |       |                  |       |                                | Drive<br>Size | Recess<br>Dim. Ref. | Key Eng.<br>Min. | Nom.               | In.  |                           |                        |                                 |       |
| 0  | 0.0600             | 0.0600 | 0.0568                 | 0.096 | 0.091            | 0.060 | 0.057                          | 0.054         | 6IP                 | 0.069            | 0.027              |      | 0.050                     | 0.025                  | 0.020                           | 0.003 |
| 1  | 0.0730             | 0.0730 | 0.0695                 | 0.118 | 0.112            | 0.073 | 0.070                          | 0.066         | 7IP                 | 0.081            | 0.036              | 1/16 | 0.062                     | 0.031                  | 0.025                           | 0.003 |
| 2  | 0.0860             | 0.0860 | 0.0822                 | 0.140 | 0.134            | 0.086 | 0.083                          | 0.077         | 8IP                 | 0.094            | 0.037              | 5/64 | 0.078                     | 0.038                  | 0.029                           | 0.003 |
| 3  | 0.0990             | 0.0990 | 0.0949                 | 0.161 | 0.154            | 0.099 | 0.095                          | 0.089         | 8IP                 | 0.094            | 0.041              | 5/64 | 0.078                     | 0.044                  | 0.034                           | 0.003 |
| 4  | 0.1120             | 0.1120 | 0.1075                 | 0.183 | 0.176            | 0.112 | 0.108                          | 0.101         | 10IP                | 0.111            | 0.049              | 3/32 | 0.094                     | 0.051                  | 0.038                           | 0.005 |
| 5  | 0.1250             | 0.1250 | 0.1202                 | 0.205 | 0.198            | 0.125 | 0.121                          | 0.112         | 10IP                | 0.111            | 0.049              | 3/32 | 0.094                     | 0.057                  | 0.043                           | 0.005 |
| 6  | 0.1380             | 0.1380 | 0.1329                 | 0.226 | 0.218            | 0.138 | 0.134                          | 0.124         | 15IP                | 0.132            | 0.058              | 7/64 | 0.109                     | 0.064                  | 0.047                           | 0.005 |
| 8  | 0.1640             | 0.1640 | 0.1585                 | 0.270 | 0.262            | 0.164 | 0.159                          | 0.148         | 25IP                | 0.178            | 0.078              | 9/64 | 0.141                     | 0.077                  | 0.056                           | 0.005 |
| 10   | 0.1900             | 0.1900 | 0.1840                 | 0.312 | 0.303            | 0.190 | 0.185                          | 0.171         | 27IP                | 0.200            | 0.088              | 5/32 | 0.156                     | 0.090                  | 0.065                           | 0.005 |
| 1/4  | 0.2500             | 0.2500 | 0.2435                 | 0.375 | 0.365            | 0.250 | 0.244                          | 0.225         | 30IP                | 0.221            | 0.097              | 3/16 | 0.188                     | 0.120                  | 0.095                           | 0.008 |
| 5/16                                       | 0.3125             | 0.3125 | 0.3053                 | 0.469 | 0.457            | 0.312 | 0.306                          | 0.281         | 45IP                | 0.312            | 0.137              | 1/4  | 0.250                     | 0.151                  | 0.119                           | 0.008 |
| 3/8  | 0.3750             | 0.3750 | 0.3678                 | 0.562 | 0.550            | 0.375 | 0.368                          | 0.337         | 50IP                | 0.352            | 0.155              | 5/16 | 0.312                     | 0.182                  | 0.143                           | 0.008 |
| 7/16                                       | 0.4375             | 0.4375 | 0.4294                 | 0.656 | 0.642            | 0.438 | 0.430                          | 0.394         | 55IP                | 0.446            | 0.202              | 3/8  | 0.375                     | 0.213                  | 0.166                           | 0.010 |
| 1/2  | 0.5000             | 0.5000 | 0.4919                 | 0.750 | 0.735            | 0.500 | 0.492                          | 0.450         | 55IP                | 0.446            | 0.202              | 3/8  | 0.375                     | 0.245                  | 0.190                           | 0.010 |
| 5/8  | 0.6250             | 0.6250 | 0.6163                 | 0.938 | 0.921            | 0.625 | 0.616                          | 0.562         | 70IP                | 0.619            | 0.291              | 1/2  | 0.500                     | 0.307                  | 0.238                           | 0.010 |
| 3/4  | 0.7500             | 0.7500 | 0.7406                 | 1.125 | 1.107            | 0.750 | 0.740                          | 0.675         | 80IP                | 0.699            | 0.332              | 5/8  | 0.625                     | 0.370                  | 0.285                           | 0.010 |
| 7/8  | 0.8750             | 0.8750 | 0.8467                 | 1.312 | 1.293            | 0.875 | 0.864                          | 0.787         | 100IP               | 0.882            | 0.425              | 3/4  | 0.750                     | 0.432                  | 0.333                           | 0.015 |
| 1  | 1.0000             | 1.0000 | 0.9886                 | 1.500 | 1.479            | 1.000 | 0.988                          | 0.900         | 100IP               | 0.882            | 0.425              | 3/4  | 0.750                     | 0.495                  | 0.380                           | 0.015 |
| 1-1/4                                      | 1.2500             | 1.2500 | 1.2336                 | 1.875 | 1.852            | 1.250 | 1.236                          | 1.125         |                     |                  |                    | 7/8  | 0.875                     | 0.620                  | 0.475                           | 0.015 |
| 1-1/2                                      | 1.5000             | 1.5000 | 1.4818                 | 2.250 | 2.224            | 1.500 | 1.485                          | 1.350         |                     |                  |                    | 1    | 1.000                     | 0.745                  | 0.570                           | 0.015 |

# Technical and Torque Data – Inch Sizes

## Camcar® Socket Head Cap Screws

### Mechanical Properties

| Nominal Size | Tensile Strength | Yield Strength | Elongation* in 2" | Reduction of Area* | Hardness   |
|--------------|------------------|----------------|-------------------|--------------------|------------|
|              | PSI Min.         | PSI Min.       | % Min.            | % Min.             | Rockwell C |
| 0 to 1/2"    | 180,000          | 162,000        | 8%                | 35%                | 39 - 45    |
| Over 1/2"    | 170,000          | 153,000        | 8%                | 35%                | 37 - 45    |

| Nominal Size | Basic Screw Dia. | Tensile Stress Area |         | Tensile Strength (Lbs. Min.) |         | Yield Strength (Lbs. Min.) |         | Single Shear Strength* (Lbs Min.) |
|--------------|------------------|---------------------|---------|------------------------------|---------|----------------------------|---------|-----------------------------------|
|              |                  | UNRC                | UNRF    | UNRC                         | UNRF    | UNRC                       | UNRF    | Body Section                      |
| 0            | 0.0600           |                     | 0.00180 |                              | 324     |                            | 290     | 280                               |
| 1            | 0.0730           | 0.00263             | 0.00278 | 473                          | 500     | 425                        | 450     | 420                               |
| 2            | 0.0860           | 0.00370             | 0.00394 | 666                          | 709     | 600                        | 635     | 580                               |
| 3            | 0.0990           | 0.00487             | 0.00523 | 877                          | 941     | 790                        | 845     | 770                               |
| 4            | 0.1120           | 0.00604             | 0.00661 | 1,090                        | 1,190   | 975                        | 1,070   | 985                               |
| 5            | 0.1250           | 0.00796             | 0.00830 | 1,430                        | 1,490   | 1,290                      | 1,345   | 1,225                             |
| 6            | 0.1380           | 0.00909             | 0.01015 | 1,640                        | 1,830   | 1,470                      | 1,645   | 1,495                             |
| 8            | 0.1640           | 0.01400             | 0.01474 | 2,520                        | 2,650   | 2,270                      | 2,385   | 2,110                             |
| 10           | 0.1900           | 0.01750             | 0.02000 | 3,150                        | 3,600   | 2,835                      | 3,240   | 2,835                             |
| 1/4          | 0.2500           | 0.03180             | 0.03640 | 5,725                        | 6,500   | 5,150                      | 5,900   | 4,910                             |
| 5/16         | 0.3125           | 0.05240             | 0.05800 | 9,430                        | 10,400  | 8,490                      | 9,395   | 7,670                             |
| 3/8          | 0.3750           | 0.07750             | 0.08780 | 13,950                       | 15,800  | 12,555                     | 14,225  | 11,045                            |
| 7/16         | 0.4375           | 0.10630             | 0.11870 | 19,135                       | 21,400  | 17,220                     | 19,230  | 15,035                            |
| 1/2          | 0.5000           | 0.14190             | 0.15990 | 25,540                       | 28,800  | 22,990                     | 25,905  | 19,635                            |
| 5/8          | 0.6250           | 0.22600             | 0.25600 | 38,400                       | 43,500  | 34,550                     | 39,150  | 30,680                            |
| 3/4          | 0.7500           | 0.33400             | 0.37300 | 56,750                       | 63,400  | 51,100                     | 57,050  | 44,180                            |
| 7/8          | 0.8750           | 0.46200             | 0.50900 | 78,500                       | 86,500  | 70,700                     | 77,850  | 60,130                            |
| 1            | 1.0000           | 0.60600             | 0.66300 | 103,000                      | 113,000 | 92,700                     | 101,450 | 78,540                            |
| 1-1/4        | 1.2500           | 0.96900             | 1.07300 | 164,700                      | 182,000 | 148,250                    | 164,150 | 122,720                           |
| 1-1/2        | 1.5000           | 1.40500             | 1.48100 | 238,800                      | 269,000 | 214,950                    | 241,900 | 176,710                           |

\* Calculated at 100 ksi shear strength

# Technical and Torque Data – Inch Sizes

## Camcar® Socket Head Cap Screws

This product is a high tensile strength fastener designed for use in applications where the material being clamped is of sufficient hardness (generally Rockwell B90/614 MPa ultimate tensile strength for steel and cast iron is adequate for the preload induced by the above seating torques; softer materials may require a washer under the head to prevent indentation). The application can be recessed with a counterbore where clearance for open and socket wrenches is a problem. Typical applications include use in a machine assembly, punch press tooling, bearing caps, split collars, etc.

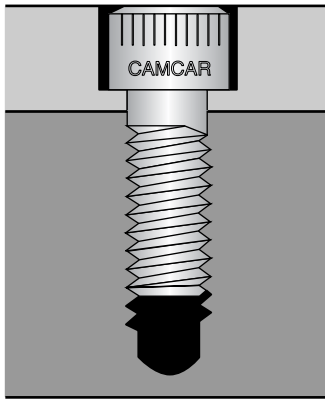

### Applications Data

| Nom. Size | Basic Screw Dia. | Tension Induced in Screws Torqued as Recommended (Lb.) |         | Suggested Seating Torque (In-Lb) |          |
|-----------|------------------|--|---------|----------------------------------|----------|
|           |                  | UNRC   | UNRF    | UNRC                             | UNRF     |
| #0        | 0.0600           |  | 220     |                                  | 2.7      |
| #1        | 0.0730           | 320  | 340     | 4.9                              | 5.2      |
| #2        | 0.0860           | 450  | 480     | 8.1                              | 8.6      |
| #3        | 0.0990           | 590  | 630     | 12.3                             | 13.2     |
| #4        | 0.1120           | 730  | 800     | 17.2                             | 18.9     |
| #5        | 0.1250           | 970  | 1,010   | 25.4                             | 26.5     |
| #6        | 0.1380           | 1,100  | 1,230   | 32.0                             | 35.7     |
| #8        | 0.1640           | 1,700  | 1,790   | 58.6                             | 61.6     |
| #10       | 0.1900           | 2,130  | 2,430   | 84.8                             | 97.0     |
| 1/4"      | 0.2500           | 3,860  | 4,420   | 202.8                            | 232.3    |
| 5/16"     | 0.3125           | 6,370  | 7,050   | 417.8                            | 462.4    |
| 3/8"      | 0.3750           | 9,416  | 10,670  | 741.5                            | 840.2    |
| 7/16"     | 0.4375           | 12,910   | 14,420  | 1,186.6                          | 1,325.1  |
| 1/2"      | 0.5000           | 17,240   | 19,430  | 1,810.5                          | 2,040.0  |
| 5/8"      | 0.6250           | 25,910   | 29,560  | 3,401.0                          | 3,854.0  |
| 3/4"      | 0.7500           | 38,320   | 42,790  | 6,036.0                          | 6,739.0  |
| 7/8"      | 0.8750           | 53,020   | 53,390  | 9,743.0                          | 10,728.0 |
| 1"        | 1.0000           | 69,525   | 76,087  | 14,600.0                         | 15,978.0 |
| 1-1/4"    | 1.2500           | 111,120  | 123,113 | 29,186.0                         | 32,317.0 |
| 1-1/2"    | 1.5000           | 161,212  | 181,425 | 50,782.0                         | 57,149.0 |

### Notes for Socket Head Cap Screws – Inch

- (1) Nominal Size: Where specifying nominal size in decimals, zeros preceding decimal and in the fourth decimal place shall be omitted.
- (2) Body: The term body refers to the unthreaded portion of the shank for screws not threaded to the head.
- (3) Head Diameter: Heads may be plain or knurled at the option of the manufacturer, unless specified by the customer. For knurled screws, the maximum head diameter shall be measured across the tops of the knurl and the minimum head diameter shall be the diameter of the unknurled portion, or the diameter across the tops of the knurls for those screws not having an unknurled portion, just above the radius or chamfer at the bottom edge of the head.
- (4) Head Chamfer: The head shall be chamfered at an angle with the plane of the top of the head. The edge between the top of the head and the chamfer may be slightly rounded.
- (5) Bearing Surface: The plane of the bearing surface shall be perpendicular to the axis of the screw within a maximum deviation of 1°.
- (6) Edge of Head: The edge between the bearing surface and the side of the head may be broken (rounded or chamfered) but the radius or chamfer measured along the bearing surface shall not exceed the values listed for "K".
- (7) Mechanical Properties: The mechanical properties included in the above charts are based on testing that was performed at normal room temperatures. When application environment temperatures fall dramatically below or are substantially higher than room temperature, certain variables need to be taken into consideration. If temperatures exceed 400 °F (204 °C), short time tensile, creep and relaxation need to be evaluated. When application temperatures drop below -20 °F (-29 °C), lower ductility, impact strength and fatigue life should be taken into account.
- (8) Material: Camcar Socket Head Cap Screws shall be fabricated from an alloy steel having one or more of the following alloying elements: chromium, nickel, molybdenum or vanadium, in sufficient quantity to assure that the specified hardness range of Rockwell C39-45 for sizes #0 to 1/2" and C37-45 for sizes over 1/2" is achieved. Decarburization and carburization limits shall be the same as those specified for Socket Head Cap Screws in ASTM Specification A574, Alloy Steel Socket Head Cap Screws.

# Technical and Torque Data – Inch Sizes

## Camcar® Socket Shoulder Screws

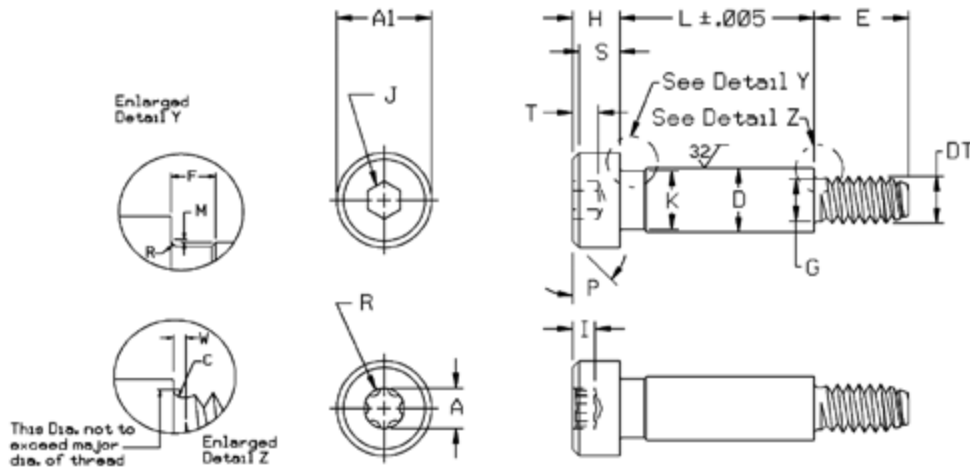

### Dimensions of Hex and TORX PLUS® Socket Shoulder Screws

| Nom. Shoulder Dia. | D Shoulder Dia. |        | A1 Head Dia. |       | H Head Height |       | S Head Side Height | R TORX PLUS |                  |               | J Hex Socket Size Nom. | T Hex Key Eng. Min. | M Head Fillet Extended Above D Max. | R Head Fillets Radius Min. |       |       |
|--------------------|-----------------|--------|--------------|-------|---------------|-------|--------------------|-------------|------------------|---------------|------------------------|---------------------|-------------------------------------|----------------------------|-------|-------|
|                    | Max.            | Min.   | Max.         | Min.  | Max.          | Min.  |                    | Drive Size  | Recess Dim. Ref. | Key Eng. Min. |                        |                     |                                     |                            |       |       |
|                    |                 |        |              |       |               |       |                    |             |                  |               |                        |                     |                                     |                            |       |       |
| 1/4                | 0.2500          | 0.2480 | 0.2460       | 0.375 | 0.357         | 0.188 | 0.177              | 0.157       | 20IP             | 0.155         | 0.068                  | 1/8                 | 0.125                               | 0.094                      | 0.014 | 0.009 |
| 5/16               | 0.3125          | 0.3105 | 0.3085       | 0.438 | 0.419         | 0.219 | 0.209              | 0.183       | 27IP             | 0.200         | 0.088                  | 5/32                | 0.156                               | 0.117                      | 0.017 | 0.012 |
| 3/8                | 0.3750          | 0.3730 | 0.3710       | 0.562 | 0.543         | 0.250 | 0.240              | 0.209       | 40IP             | 0.266         | 0.117                  | 3/16                | 0.188                               | 0.141                      | 0.020 | 0.015 |
| 1/2                | 0.5000          | 0.4980 | 0.4960       | 0.750 | 0.729         | 0.312 | 0.302              | 0.262       | 45IP             | 0.312         | 0.137                  | 1/4                 | 0.250                               | 0.188                      | 0.026 | 0.020 |
| 5/8                | 0.6250          | 0.6230 | 0.6210       | 0.875 | 0.853         | 0.375 | 0.365              | 0.315       | 55IP             | 0.446         | 0.196                  | 5/16                | 0.312                               | 0.234                      | 0.032 | 0.024 |
| 3/4                | 0.7500          | 0.7480 | 0.7460       | 1.000 | 0.977         | 0.500 | 0.490              | 0.421       | 60IP             | 0.529         | 0.245                  | 3/8                 | 0.375                               | 0.281                      | 0.039 | 0.030 |

| Nom. Shoulder Dia. | K Shoulder Neck Dia. Max. | F Neck Width Max. | DT Nominal Thread Size or Basic Dia. |      | TPI    | G Threaded Neck Dia. |       | W Thread Neck Width Max. | C Threaded Neck Fillet |       | E Threaded Length Basic |       |
|--------------------|---------------------------|-------------------|--------------------------------------|------|--------|----------------------|-------|--------------------------|------------------------|-------|-------------------------|-------|
|                    |                           |                   | Max.                                 | Min. |        | Max.                 | Min.  |                          | Max.                   | Min.  |                         |       |
|                    |                           |                   |                                      |      |        |                      |       |                          |                        |       |                         |       |
| 1/4                | 0.2500                    | 0.227             | 0.093                                | 10   | 0.1900 | 24                   | 0.142 | 0.133                    | 0.083                  | 0.023 | 0.017                   | 0.375 |
| 5/16               | 0.3125                    | 0.289             | 0.093                                | 1/4  | 0.2500 | 20                   | 0.193 | 0.182                    | 0.100                  | 0.028 | 0.022                   | 0.438 |
| 3/8                | 0.3750                    | 0.352             | 0.093                                | 5/16 | 0.3125 | 18                   | 0.249 | 0.237                    | 0.111                  | 0.031 | 0.025                   | 0.500 |
| 1/2                | 0.5000                    | 0.477             | 0.093                                | 3/8  | 0.3750 | 16                   | 0.304 | 0.291                    | 0.125                  | 0.035 | 0.029                   | 0.625 |
| 5/8                | 0.6250                    | 0.602             | 0.093                                | 1/2  | 0.5000 | 13                   | 0.414 | 0.397                    | 0.154                  | 0.042 | 0.036                   | 0.750 |
| 3/4                | 0.7500                    | 0.727             | 0.093                                | 5/8  | 0.6250 | 11                   | 0.521 | 0.502                    | 0.182                  | 0.051 | 0.045                   | 0.875 |

| Nominal or Basic Shoulder Diameter | Mechanical Properties |          |                |                  | Application Data          |
|------------------------------------|-----------------------|----------|----------------|------------------|---------------------------|
|                                    | Tensile Strength      |          | Shear Strength |                  | Suggested Seating Torque* |
|                                    | Thread Neck Area      |          | Shoulder Area  | Thread Neck Area |                           |
|                                    | Lb. Min.              | Lb. Min. | Lb. Min.       | Lb. Min.         |                           |
| 1/4                                | 0.2500                | 1,950    | 8,246          | 1,167            | 36                        |
| 5/16                               | 0.3125                | 3,640    | 12,885         | 2,185            | 89                        |
| 3/8                                | 0.3750                | 6,170    | 18,555         | 3,706            | 188                       |
| 1/2                                | 0.5000                | 9,310    | 32,986         | 5,587            | 340                       |
| 5/8                                | 0.6250                | 17,300   | 51,541         | 10,398           | 845                       |
| 3/4                                | 0.7500                | 27,700   | 74,220         | 16,625           | 1,688                     |

Socket head shoulder screws are designed and recommended for use with stripper springs and guides in punch press die sets. They can also be used for attaching cams, rollers, links and levers, as stationary guides and as pressure pads.

# Technical and Torque Data – Inch Sizes

## Camcar® Button Head Cap Screws

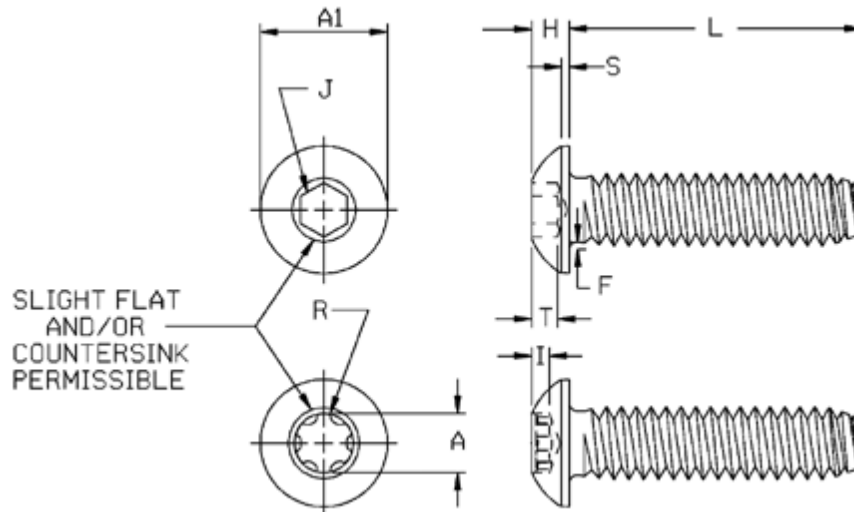

### Dimensions of Hex and TORX PLUS® Drive Socket Button Head Cap Screws

| Nominal Size or Basic Screw Diameter | A1 Head Dia. |       | H Head Height |       | S Head Side Height | TORX PLUS  |             |            | J Hexagon Socket Size |       | T Hex Head Key Engmt. | F Ext. Fillet Above D |       | L Max. Length |
|--------------------------------------|--------------|-------|---------------|-------|--------------------|------------|-------------|------------|-----------------------|-------|-----------------------|-----------------------|-------|---------------|
|                                      |              |       |               |       |                    | R          | A           | I          |                       |       |                       |                       |       |               |
|                                      |              |       |               |       |                    | Drive Size | Recess Dim. | Key Engmt. |                       |       |                       |                       |       |               |
| Max.                                 | Min.         | Max.  | Min.          | Ref.  | Ref.               | Min.       | Nom.        | In.        | Min.                  | Max.  | Min.                  | Nom.                  |       |               |
| 0                                    | 0.0600       | 0.114 | 0.104         | 0.032 | 0.026              | 0.010      |             |            |                       | 0.035 | 0.020                 | 0.010                 | 0.005 | 1/2           |
| 2                                    | 0.0860       | 0.164 | 0.154         | 0.046 | 0.038              | 0.010      | 6IP         | .069       | 0.023                 | 0.050 | 0.028                 | 0.010                 | 0.005 | 1/2           |
| 4                                    | 0.1120       | 0.213 | 0.201         | 0.059 | 0.051              | 0.015      | 8IP         | .094       | 0.032                 | 1/16  | 0.062                 | 0.035                 | 0.010 | 1/2           |
| 6                                    | 0.1380       | 0.262 | 0.250         | 0.073 | 0.063              | 0.015      | 10IP        | .111       | 0.038                 | 5/64  | 0.078                 | 0.044                 | 0.010 | 5/8           |
| 8                                    | 0.1640       | 0.312 | 0.298         | 0.087 | 0.077              | 0.015      | 15IP        | .132       | 0.045                 | 3/32  | 0.094                 | 0.052                 | 0.015 | 3/4           |
| 10                                   | 0.1900       | 0.361 | 0.347         | 0.101 | 0.091              | 0.020      | 25IP        | .178       | 0.052                 | 1/8   | 0.125                 | 0.070                 | 0.015 | 1             |
| 1/4                                  | 0.2500       | 0.437 | 0.419         | 0.132 | 0.122              | 0.031      | 27IP        | .200       | 0.068                 | 5/32  | 0.156                 | 0.087                 | 0.020 | 1             |
| 5/16                                 | 0.3125       | 0.547 | 0.527         | 0.166 | 0.152              | 0.031      | 40IP        | .266       | 0.090                 | 3/16  | 0.188                 | 0.105                 | 0.020 | 1             |
| 3/8                                  | 0.3750       | 0.656 | 0.636         | 0.199 | 0.185              | 0.031      | 45IP        | .312       | 0.106                 | 7/32  | 0.219                 | 0.122                 | 0.020 | 1-1/4         |
| 1/2                                  | 0.5000       | 0.875 | 0.851         | 0.265 | 0.245              | 0.046      | 55IP        | .446       | 0.158                 | 5/16  | 0.312                 | 0.175                 | 0.030 | 2             |
| 5/8                                  | 0.6250       | 1.000 | 0.970         | 0.331 | 0.311              | 0.062      | 60IP        | .529       | 0.192                 | 3/8   | 0.375                 | 0.210                 | 0.030 | 2             |

### Mechanical and Application Data

| Nominal Tensile Size or Basic Screw Diameter | Single Shear*                 |                             | Suggested Seating Torque** lb./in. |                   |       |
|--|-------------------------------|-----------------------------|------------------------------------|-------------------|-------|
|  | Strength (lb.) Min. UNRC/UNRF | Strength (lb.) Body Section | UNRC Plain Finish                  | UNRF Plain Finish |       |
|  |                               |                             |                                    |                   |       |
| 0  | 0.060                         | 260                         | 282                                | 1                 | 1     |
| 2  | 0.086                         | 540                         | 580                                | 3                 | 3     |
| 4  | 0.112                         | 840                         | 985                                | 7                 | 8     |
| 6  | 0.138                         | 1,260                       | 1,495                              | 13                | 14    |
| 8  | 0.164                         | 1,940                       | 2,110                              | 23                | 24    |
| 10   | 0.190                         | 2,440                       | 2,835                              | 34                | 38    |
| 1/4  | 0.250                         | 4,430                       | 4,910                              | 80                | 92    |
| 5/16   | 0.3125                        | 7,300                       | 7,670                              | 165               | 182   |
| 3/8  | 0.375                         | 10,880                      | 11,045                             | 293               | 332   |
| 1/2  | 0.500                         | 19,800                      | 19,633                             | 715               | 806   |
| 5/8  | 0.625                         | 31,500                      | 30,680                             | 1,425             | 1,610 |

\* Some shear values derived by calculation.

\*\* Seating torques calculated to induce 48,000 psi tensile stress with a "K" factor of .21.

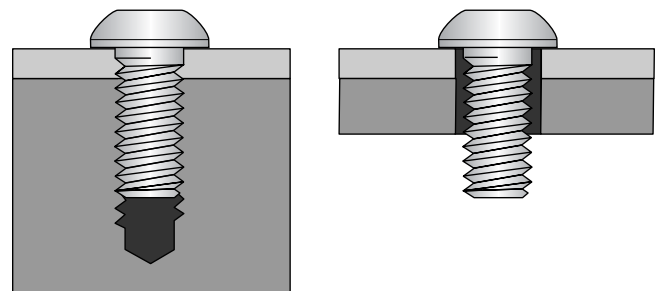

This product is designed and recommended for applications where a low profile socket head screw is desired. Wrenchability is limited by the socket size and key engagement. Because of the head configuration, this product is not recommended for use in high-strength applications or where maximum fatigue resistance is required.

# Technical and Torque Data – Inch Sizes

## Camcar® Low Head Cap Screws

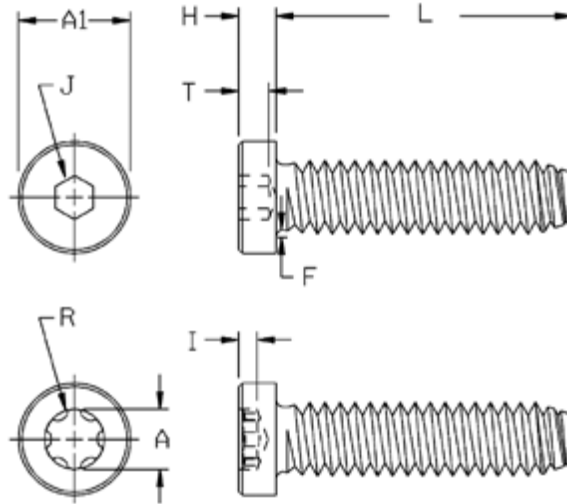

### Dimensions of Hex and TORX PLUS® Socket Low Head Cap Screws

| Nominal Size | A1 Head Diameter |       | H Head Height |      | R          | A                | I               | J Hex Socket Size |      | T Hex Key Engmt. | F Fillet Extension |      |      |
|--------------|------------------|-------|---------------|------|------------|------------------|-----------------|-------------------|------|------------------|--------------------|------|------|
|              | Max.             | Min.  | Max.          | Min. | TORX PLUS  |                  |                 | Nom.              | In.  | Min.             | Max.               | Min. |      |
|              |                  |       |               |      | Drive Size | Recess Dim. Ref. | Key Engmt. Min. |                   |      |                  |                    |      |      |
| 8            | 0.1640           | 0.270 | .265          | .082 | .079       | 15IP             | .132            | .045              | 5/64 | .0781            | .060               | .012 | .007 |
| 10           | 0.1900           | 0.312 | .307          | .095 | .092       | 20IP             | .155            | .053              | 3/32 | .0938            | .072               | .014 | .009 |
| 1/4          | 0.2500           | 0.375 | .369          | .125 | .121       | 27IP             | .200            | .068              | 1/8  | .1250            | .094               | .014 | .009 |
| 5/16         | 0.3125           | 0.437 | .431          | .156 | .152       | 30IP             | .221            | .075              | 5/32 | .1562            | .120               | .017 | .012 |
| 3/8          | 0.3750           | 0.562 | .556          | .187 | .182       | 40IP             | .266            | .090              | 3/16 | .1875            | .145               | .020 | .015 |
| 1/2          | 0.5000           | 0.750 | .743          | .250 | .244       | 50IP             | .352            | .120              | 1/4  | .2500            | .184               | .026 | .020 |

### Mechanical & Applications Data

| Nominal Size or Basic Screw Diameter | Tensile Strength lb. Min. |        | Single Shear* Strength (lb.) Thru Body Section | Suggested Seating Torque** (lb./in.) |      |     |
|--------------------------------------|---------------------------|--------|--|--------------------------------------|------|-----|
|                                      | UNRC                      | UNRF   |  | UNRC                                 | UNRF |     |
| 8                                    | 0.164                     | 2,380  | 2,510  | 2,110                                | 23   | 24  |
| 10                                   | 0.190                     | 2,980  | 3,400  | 2,835                                | 34   | 38  |
| 1/4                                  | 0.250                     | 5,400  | 6,100  | 4,910                                | 80   | 92  |
| 5/16                                 | 0.3125                    | 8,900  | 9,800  | 7,670                                | 165  | 182 |
| 3/8                                  | 0.375                     | 13,100 | 14,900   | 11,045                               | 293  | 332 |
| 1/2                                  | 0.500                     | 24,100 | 27,100   | 19,635                               | 715  | 806 |

\* Some shear values are derived by calculation.

\*\* Seating torques calculated to induce 48,000 psi tensile stress with a "K" factor of .26.

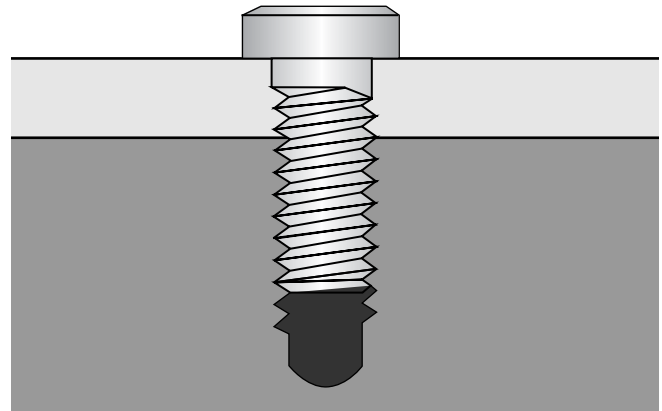

Socket low head cap screws are precision fasteners designed for applications where head height clearance is a problem. Because of their reduced head height and smaller socket size, they normally **can not be preloaded as high** as standard socket head cap screws and should not be subjected to high tensile loads.

# Technical and Torque Data – Inch Sizes

## Camcar® Countersunk Flat Head Cap Screws

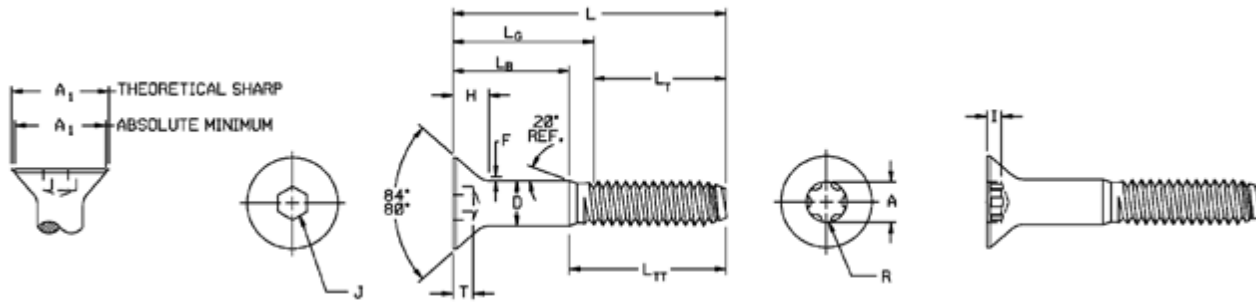

### Dimensions of Hex and TORX PLUS® Flat Countersunk Head Cap Screws

| Nominal Size<br>or<br>Basic Screw<br>Dia. | D      |        | A1<br>Head Dia. |       | H<br>Head Height |       | R                 | A                    | I         | J<br>Hex<br>Socket<br>Size |      | T<br>Hex Key<br>Engmt.<br>Min. | F<br>Ext.<br>Fillet<br>Above<br>D<br>Max. |           |
|---|--------|--------|-----------------|-------|------------------|-------|-------------------|----------------------|-----------|----------------------------|------|--------------------------------|---|-----------|
|   |        |        |                 |       |                  |       | TORX PLUS         |                      |           |                            |      |                                |   |           |
|   |        |        |                 |       |                  |       | Body Dia.<br>Max. | Theor. Sharp<br>Min. | Abs. Min. |                            |      |                                |   | Abs. Max. |
| 4   | 0.1120 | 0.1120 | 0.1075          | 0.255 | 0.218            | 0.083 | 0.011             | 10IP                 | .111      | .038                       | 1/16 | 0.062                          | 0.055                                     | 0.012     |
| 5   | 0.1250 | 0.1250 | 0.1202          | 0.281 | 0.240            | 0.090 | 0.012             | 10IP                 | .111      | .038                       | 5/64 | 0.078                          | 0.061                                     | 0.014     |
| 6   | 0.1380 | 0.1380 | 0.1329          | 0.307 | 0.263            | 0.097 | 0.013             | 15IP                 | .132      | .045                       | 5/64 | 0.078                          | 0.066                                     | 0.015     |
| 8   | 0.1640 | 0.1640 | 0.1585          | 0.359 | 0.311            | 0.112 | 0.014             | 20IP                 | .155      | .053                       | 3/32 | 0.094                          | 0.076                                     | 0.015     |
| 10  | 0.1900 | 0.1900 | 0.1840          | 0.411 | 0.359            | 0.127 | 0.015             | 25IP                 | .178      | .061                       | 1/8  | 0.125                          | 0.087                                     | 0.015     |
| 1/4                                       | 0.2500 | 0.2500 | 0.2435          | 0.531 | 0.480            | 0.161 | 0.016             | 30IP                 | .221      | .075                       | 5/32 | 0.156                          | 0.111                                     | 0.015     |
| 5/16                                      | 0.3125 | 0.3125 | 0.3053          | 0.656 | 0.600            | 0.198 | 0.017             | 40IP                 | .266      | .090                       | 3/16 | 0.188                          | 0.135                                     | 0.015     |
| 3/8                                       | 0.3750 | 0.3750 | 0.3678          | 0.781 | 0.720            | 0.234 | 0.018             | 45IP                 | .312      | .106                       | 7/32 | 0.219                          | 0.159                                     | 0.015     |
| 7/16                                      | 0.4375 | 0.4375 | 0.4294          | 0.844 | 0.781            | 0.234 | 0.018             | 50IP                 | .352      | .120                       | 1/4  | 0.250                          | 0.159                                     | 0.015     |
| 1/2                                       | 0.5000 | 0.5000 | 0.4919          | 0.938 | 0.872            | 0.251 | 0.018             | 50IP                 | .352      | .120                       | 5/16 | 0.312                          | 0.172                                     | 0.015     |
| 5/8                                       | 0.6250 | 0.6250 | 0.6163          | 1.188 | 1.112            | 0.324 | 0.022             | 55IP                 | .446      | .158                       | 3/8  | 0.375                          | 0.220                                     | 0.015     |
| 3/4                                       | 0.7500 | 0.7500 | 0.7406          | 1.438 | 1.355            | 0.396 | 0.024             | 60IP                 | .529      | .192                       | 1/2  | 0.500                          | 0.220                                     | 0.015     |

### Mechanical & Application Data

| Nom.<br>Size | Basic Screw<br>Diameter | Tensile<br>Strength<br>(lbs)<br>Min.<br>UNRC/UNRF | Single Shear Strength*<br>(lbs) |                |        | Suggested Seating Torque**<br>(lb./in.) |                      |
|--------------|-------------------------|---|---------------------------------|----------------|--------|---|----------------------|
|              |                         |   | Body<br>Section                 | Thread Section |        | UNRC<br>Plain Finish                    | UNRF<br>Plain Finish |
|              |                         |   |                                 | UNRC           | UNRF   |   |                      |
| 4            | 0.1120                  | 900   | 950                             | 630            | 690    | 8.4                                     | 9.2                  |
| 5            | 0.1250                  | 1,185   | 1,190                           | 830            | 870    | 12.0                                    | 13.0                 |
| 6            | 0.1380                  | 1,350   | 1,460                           | 950            | 1,060  | 16.0                                    | 18.0                 |
| 8            | 0.164                   | 2,085   | 2,070                           | 1,470          | 1,550  | 29.0                                    | 30.0                 |
| 10           | 0.1900                  | 2,610   | 2,790                           | 1,840          | 2,100  | 42.0                                    | 47.0                 |
| 1/4          | 0.2500                  | 4,750   | 4,900                           | 3,340          | 3,830  | 99.0                                    | 114.0                |
| 5/16         | 0.3125                  | 7,800   | 7,700                           | 5,500          | 6,100  | 204.0                                   | 226.0                |
| 3/8          | 0.3750                  | 11,600  | 11,100                          | 8,100          | 9,200  | 363.0                                   | 411.0                |
| 7/16         | 0.4375                  | 15,900  | 15,200                          | 11,100         | 12,400 | 580.0                                   | 648.0                |
| 1/2          | 0.5000                  | 21,200  | 20,000                          | 14,900         | 16,800 | 885.0                                   | 998.0                |
| 5/8          | 0.6250                  | 33,800  | 31,400                          | 23,700         | 26,900 | 1,763.0                                 | 1,997.0              |
| 3/4          | 0.7500                  | 50,000  | 45,300                          | 35,100         | 39,200 | 3,126.0                                 | 3,491.0              |

\* Some shear values are derived by calculation.

\*\* Seating torques calculated to induce 48,000 psi tensile stress with a "K" factor of .26.

# Technical and Torque Data – Inch Sizes

## Camcar® Socket Set Screws

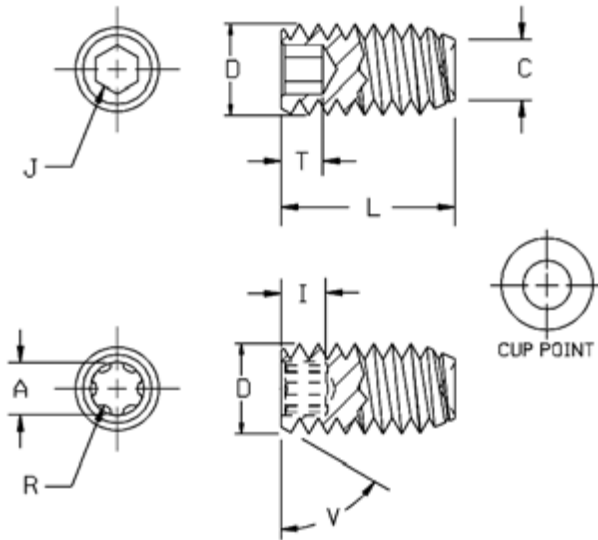

### Mechanical & Application Data

| Nominal Screw Size | Suggested Seating Torque* | Axial Holding Power lbs. |
|--------------------|---------------------------|--------------------------|
| 2                  | 0.0860                    | 85                       |
| 3                  | 0.0990                    | 120                      |
| 4                  | 0.1120                    | 160                      |
| 5                  | 0.1250                    | 200                      |
| 6                  | 0.203                     | 250                      |
| 8                  | 0.164                     | 385                      |
| 10                 | 0.1900                    | 540                      |
| 1/4                | 0.2500                    | 1,000                    |
| 5/16               | 0.3125                    | 1,500                    |
| 3/8                | 0.3750                    | 2,000                    |
| 7/16               | 0.4375                    | 2,500                    |
| 1/2                | 0.5000                    | 3,000                    |
| 5/8                | 0.6250                    | 4,000                    |
| 3/4                | 0.7500                    | 5,000                    |
| 7/8                | 0.8750                    | 5,600                    |
| 1                  | 1.0000                    | 6,500                    |

\* Calculated to reach 85% of minimum key strength.

NOTE: Set screws must have minimum recess depth shown above to generate full recess strength. The axial holding power data in the table above is for cup point set screws and is provided for reference only, as actual holding power may vary by +25%. It is recommended that laboratory testing of your set screw application be performed to verify results.

### Dimensions of Hex and TORX PLUS® Socket Set Screws

| D         |               |                  | R               | A              | I         | J               |      | T  | B  | C                 |      |
|-----------|---------------|------------------|-----------------|----------------|-----------|-----------------|------|--|--|-------------------|------|
| Nom. Size | Thread Series | Basic Screw Dia. | TORX PLUS Drive |                |           | Hex Socket Size |      | Min. Key Eng. To Develop Functional Capability of Key Hex Socket | Shortest Opt. Nom. Length To Which "T" Applies Cup and Flat Pts. | Cup and Flat Dia. |      |
|           |               |                  | Rec Size        | Rec. Dia. Ref. | Min. Eng. | Nom Size.       | In.  |  |  | Max.              | Min. |
| #2        | UNC           | .086             |                 |                |           |                 | .035 | .060   | .13  | .047              | .039 |
| #3        | UNC           | .099             |                 |                |           |                 | .050 | .070   | .19  |                   |      |
| #4        | UNC/UNF       | .112             | 6IP             | .069           | .027      |                 | .050 | .070   | .19  | .061              | .051 |
| #5        | UNC/UNF       | .125             | 7IP             | .081           | .036      | 1/16"           | .062 | .080   | .19  | .067              | .057 |
| #6        | UNC           | .138             | 6IP             | .069           | .027      | 1/16"           | .062 | .080   | .19  | .074              | .064 |
| #6        | UNF           | .138             | 7IP             | .081           | .036      | 1/16"           | .062 | .080   | .19  | .074              | .064 |
| #8        | UNC           | .164             | 8IP             | .094           | .041      | 5/64"           | .078 | .090   | .19  | .087              | .076 |
| #10       | UNC           | .190             | 10IP            | .111           | .049      | 3/32"           | .094 | .100   | .25  | .102              | .088 |
| 1/4"      | UNC           | .250             | 15IP            | .132           | .067      | 1/8"            | .125 | .125   | .31  | .132              | .118 |
| 1/4"      | UNF           | .250             | 20IP            | .155           | .079      | 1/8"            | .125 | .125   | .38  | .132              | .118 |
| 5/16"     | UNC           | .313             | 25IP            | .200           | .088      | 5/32"           | .156 | .156   | .31  | .172              | .156 |
| 5/16"     | UNF           | .313             | 27IP            | .200           | .088      | 5/32"           | .156 | .156   | .31  | .172              | .156 |
| 3/8"      | UNC           | .375             | 27IP            | .221           | .097      | 3/16"           | .188 | .188   | .38  | .212              | .194 |
| 3/8"      | UNF           | .375             | 30IP            | .221           | .097      | 3/16"           | .188 | .188   | .38  | .212              | .194 |
| 7/16"     | UNC/UNF       | .438             | 40IP            | .266           | .117      | 7/32"           | .219 | .219   | .44  | .291              | .270 |
| 1/2"      | UNC/UNF       | .500             | 45IP            | .312           | .137      | 1/4"            | .250 | .250   | .50  |                   |      |
| 5/8"      | UNC/UNF       | .625             | 55IP            | .446           | .202      | 5/16"           | .312 | .312   | .63  | .371              | .340 |
| 3/4"      | UNC           | .750             | 60IP            | .529           | 0.245     | 3/8"            | .375 | .375   | .75  |                   |      |
| 7/8"      | UNC           | .875             | 70IP            | .619           | 0.291     | 1/2"            | .500 | .500   | .88  |                   |      |
| 1"        | UNC           | 1.000            | 70IP            | .619           | 0.291     | 9/16"           | .562 | .562   | 1.00   |                   |      |

# Technical and Torque Data – Inch Sizes

## Camcar® Hardened Ground Machine Dowel Pins

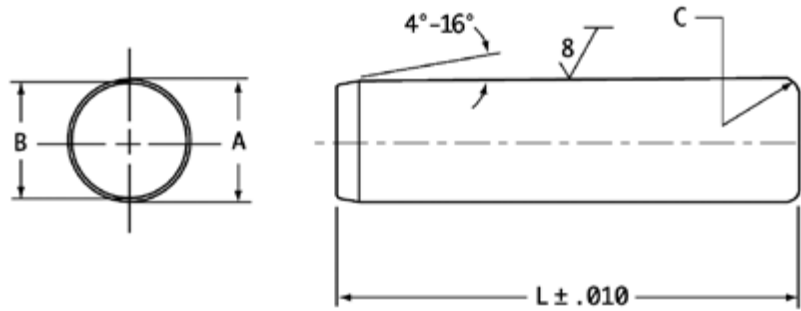

### Dimensions of Hardened Ground Machined Dowel Pins

| Nom Size<br>or Pin Dia. |        | A<br>Pin Diameter    |        |        |                      |        |        | B<br>Point Diameter |       | C<br>Crown Height<br>or Radius |       |
|-------------------------|--------|----------------------|--------|--------|----------------------|--------|--------|---------------------|-------|--------------------------------|-------|
|                         |        | Standard Series Pins |        |        | Oversize Series Pins |        |        |                     |       |                                |       |
| Nom.                    | In.    | Basic                | Max.   | Min.   | Basic                | Max.   | Min.   | Max.                | Min.  | Max.                           | Min.  |
| 1/16                    | 0.0625 | 0.0627               | 0.0628 | 0.0626 | 0.0635               | 0.0636 | 0.0634 | 0.058               | 0.048 | 0.020                          | 0.008 |
| 3/32                    | 0.0938 | 0.0940               | 0.0941 | 0.0939 | 0.0948               | 0.0949 | 0.0947 | 0.089               | 0.079 | 0.031                          | 0.012 |
| 1/8                     | 0.1250 | 0.1252               | 0.1253 | 0.1251 | 0.1260               | 0.1261 | 0.1259 | 0.120               | 0.110 | 0.041                          | 0.016 |
| 3/16                    | 0.1875 | 0.1877               | 0.1878 | 0.1876 | 0.1885               | 0.1886 | 0.1884 | 0.180               | 0.170 | 0.062                          | 0.023 |
| 1/4                     | 0.2500 | 0.2502               | 0.2503 | 0.2501 | 0.2510               | 0.2511 | 0.2509 | 0.240               | 0.230 | 0.083                          | 0.031 |
| 5/16                    | 0.3125 | 0.3127               | 0.3128 | 0.3126 | 0.3135               | 0.3136 | 0.3134 | 0.302               | 0.290 | 0.104                          | 0.039 |
| 3/8                     | 0.3750 | 0.3752               | 0.3753 | 0.3751 | 0.3760               | 0.3761 | 0.3759 | 0.365               | 0.350 | 0.125                          | 0.047 |
| 7/16                    | 0.4375 | 0.4377               | 0.4378 | 0.4376 | 0.4385               | 0.4386 | 0.4384 | 0.424               | 0.409 | 0.146                          | 0.055 |
| 1/2                     | 0.5000 | 0.5002               | 0.5003 | 0.5001 | 0.5010               | 0.5011 | 0.5009 | 0.486               | 0.471 | 0.167                          | 0.063 |
| 5/8                     | 0.6250 | 0.6252               | 0.6253 | 0.6251 | 0.6260               | 0.6261 | 0.6259 | 0.611               | 0.595 | 0.208                          | 0.078 |
| 3/4                     | 0.7500 | 0.7502               | 0.7503 | 0.7501 | 0.7510               | 0.7511 | 0.7509 | 0.735               | 0.715 | 0.250                          | 0.094 |
| 7/8                     | 0.8750 | 0.8752               | 0.8753 | 0.8751 | 0.8760               | 0.8761 | 0.8759 | 0.860               | 0.840 | 0.293                          | 0.109 |
| 1                       | 1.0000 | 1.0002               | 1.0003 | 1.0001 | 1.0010               | 1.0011 | 1.0009 | 0.980               | 0.960 | 0.333                          | 0.125 |

### Mechanical & Application Data

| Nominal<br>Pin<br>Size | Suggested Hole Dia.<br>for Standard Series Pins |        | Double Shear Load<br>Lb. |
|------------------------|---|--------|--------------------------|
|                        | Max.  | Min.   |                          |
| 1/16                   | 0.0625  | 0.0620 | 800                      |
| 5/64                   | 0.0781  | 0.0776 | 1,240                    |
| 3/32                   | 0.0937  | 0.0932 | 1,800                    |
| 1/8                    | 0.1250  | 0.1245 | 3,200                    |
| 5/32                   | 0.1562  | 0.1557 | 5,000                    |
| 3/16                   | 0.1875  | 0.1870 | 7,200                    |
| 1/4                    | 0.2500  | 0.2495 | 12,800                   |
| 5/16                   | 0.3125  | 0.3120 | 20,000                   |
| 3/8                    | 0.3750  | 0.3745 | 28,700                   |
| 7/16                   | 0.4375  | 0.4370 | 39,100                   |
| 1/2                    | 0.5000  | 0.4995 | 51,000                   |
| 5/8                    | 0.6250  | 0.6245 | 79,800                   |
| 3/4                    | 0.7500  | 0.7495 | 114,000                  |
| 7/8                    | 0.8750  | 0.8745 | 156,000                  |
| 1                      | 1.0000  | 0.9995 | 204,000                  |

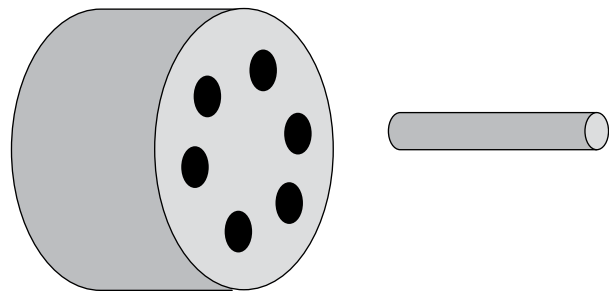

Hardened ground machine dowel pins are intended for applications where precise locating of mating parts is essential, such as, for doweling hardened tool and machine components or to serve as stops, guides and load bearing pins, etc., where strength shock or wear factors necessitate a hardened pin.

# Technical and Torque Data – Metric Sizes

## Camcar® Socket Head Cap Screws

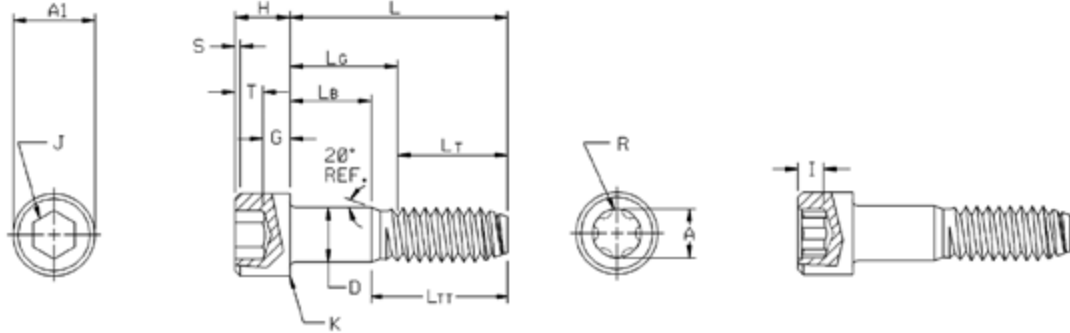

### Dimensions of Hex and TORX PLUS® Metric Socket Head Cap Screws

| Nominal Size<br>x Thread Pitch | D<br>Body Dia. |       | A1<br>Head Dia. |       | H<br>Head Height |       | S<br>Head<br>Side<br>Height<br>Min. | R             | A                      | I                     | J<br>Hex<br>Socket<br>Size<br>Nom. | T<br>Key<br>Engmt.<br>Min. | G<br>Wall<br>Thick.<br>Min. | Chamfer<br>or<br>Radius<br>Max. |
|--------------------------------|----------------|-------|-----------------|-------|------------------|-------|-------------------------------------|---------------|------------------------|-----------------------|------------------------------------|----------------------------|-----------------------------|---------------------------------|
|                                | Max.           | Min.  | Max.            | Min.  | Max.             | Min.  |                                     | TORX PLUS     |                        |                       |                                    |                            |                             |                                 |
|                                |                |       |                 |       |                  |       |                                     | Drive<br>Size | Recess<br>Dim.<br>Ref. | Key<br>Engmt.<br>Min. |                                    |                            |                             |                                 |
| M1.6 x 0.35                    | 1.60           | 1.46  | 3.00            | 2.87  | 1.60             | 1.52  | 0.16                                |               |                        |                       | 1.5                                | 0.80                       | 0.54                        | 0.08                            |
| M2 x 0.4                       | 2.00           | 1.86  | 3.80            | 3.65  | 2.00             | 1.91  | 0.20                                | 6IP           | 1.75                   | 0.77                  | 1.5                                | 1.00                       | 0.68                        | 0.08                            |
| M2.5 x 0.45                    | 2.50           | 2.36  | 4.50            | 4.33  | 2.50             | 2.40  | 0.25                                | 8IP           | 2.39                   | 1.05                  | 2.0                                | 1.25                       | 0.85                        | 0.08                            |
| M3 x 0.5                       | 3.00           | 2.86  | 5.50            | 5.32  | 3.00             | 2.89  | 0.30                                | 10IP          | 2.82                   | 1.24                  | 2.5                                | 1.50                       | 1.02                        | 0.13                            |
| M4 x 0.7                       | 4.00           | 3.82  | 7.00            | 6.80  | 4.00             | 3.88  | 0.40                                | 25IP          | 4.52                   | 1.76                  | 3.0                                | 2.00                       | 1.52                        | 0.13                            |
| M5 x 0.8                       | 5.00           | 4.82  | 8.50            | 8.27  | 5.00             | 4.86  | 0.50                                | 27IP          | 5.08                   | 2.24                  | 4.0                                | 2.50                       | 1.90                        | 0.13                            |
| M6 x 1                         | 6.00           | 5.82  | 10.00           | 9.74  | 6.00             | 5.85  | 0.60                                | 30IP          | 5.61                   | 2.47                  | 5.0                                | 3.00                       | 2.28                        | 0.20                            |
| M8 x 1.25                      | 8.00           | 7.78  | 13.00           | 12.70 | 8.00             | 7.83  | 0.80                                | 45IP          | 7.92                   | 3.48                  | 6.0                                | 4.00                       | 3.20                        | 0.20                            |
| M10 x 1.5                      | 10.00          | 9.78  | 16.00           | 15.67 | 10.00            | 9.81  | 1.00                                | 50IP          | 8.94                   | 3.93                  | 8.0                                | 5.00                       | 4.00                        | 0.20                            |
| M12 x 1.75                     | 12.00          | 11.73 | 18.00           | 17.63 | 12.00            | 11.79 | 1.20                                | 55IP          | 11.33                  | 5.15                  | 10.0                               | 6.00                       | 4.80                        | 0.25                            |
| M16 x 2                        | 16.00          | 15.73 | 24.00           | 23.58 | 16.00            | 15.76 | 1.60                                | 70IP          | 15.72                  | 7.39                  | 14.0                               | 8.00                       | 6.40                        | 0.25                            |
| M20 x 2.5                      | 20.00          | 19.67 | 30.00           | 29.53 | 20.00            | 19.73 | 2.00                                | 90IP          | 20.19                  | 9.67                  | 17.0                               | 10.00                      | 8.00                        | 0.40                            |
| M24 x 3                        | 24.00          | 23.67 | 36.00           | 35.48 | 24.00            | 23.70 | 2.40                                | 100IP         | 22.10                  | 10.79                 | 19.0                               | 12.00                      | 9.60                        | 0.40                            |

### Mechanical and Application Data

| Nominal Size x Thread Pitch | Tensile Strength Min. |        | Single Shear* Body Section |        | Suggested Seating Torque** Plain Finish |        |
|-----------------------------|-----------------------|--------|----------------------------|--------|---|--------|
|                             | Kn                    | Lb     | Kn                         | Lb     | Nm                                      | Lb-In  |
| M3 x 0.5                    | 6.14                  | 1,380  | 4.9                        | 1,095  | 2.6                                     | 23     |
| M4 x 0.7                    | 10.7                  | 2,410  | 8.7                        | 1,947  | 6.1                                     | 54     |
| M5 x 0.8                    | 17.3                  | 3,890  | 13.5                       | 3,043  | 12.39                                   | 109    |
| M6 x 1                      | 24.5                  | 5,510  | 19.5                       | 4,382  | 20.9                                    | 185    |
| M8 x 1.25                   | 44.6                  | 10,030 | 34.6                       | 7,791  | 50.8                                    | 450    |
| M10 x 1.5                   | 70.8                  | 15,920 | 54.1                       | 12,173 | 100.8                                   | 892    |
| M12 x 1.75                  | 103.0                 | 23,150 | 78.0                       | 17,530 | 175.9                                   | 1,554  |
| M16 x 2                     | 192.0                 | 43,160 | 138.6                      | 31,164 | 437.0                                   | 3,964  |
| M20 x 2.5                   | 299.0                 | 67,220 | 217.0                      | 48,695 | 851.0                                   | 7,536  |
| M24 x 3                     | 431.0                 | 96,890 | 312.0                      | 70,120 | 1,471.0                                 | 13,026 |

\* Based on 100 ksi shear strength

\*\* Seating torques calculated to induce 65,000 psi tensile stress with a "K" factor of 0.21.

# Technical and Torque Data – Metric Sizes

## Camcar® Button Head Cap Screws

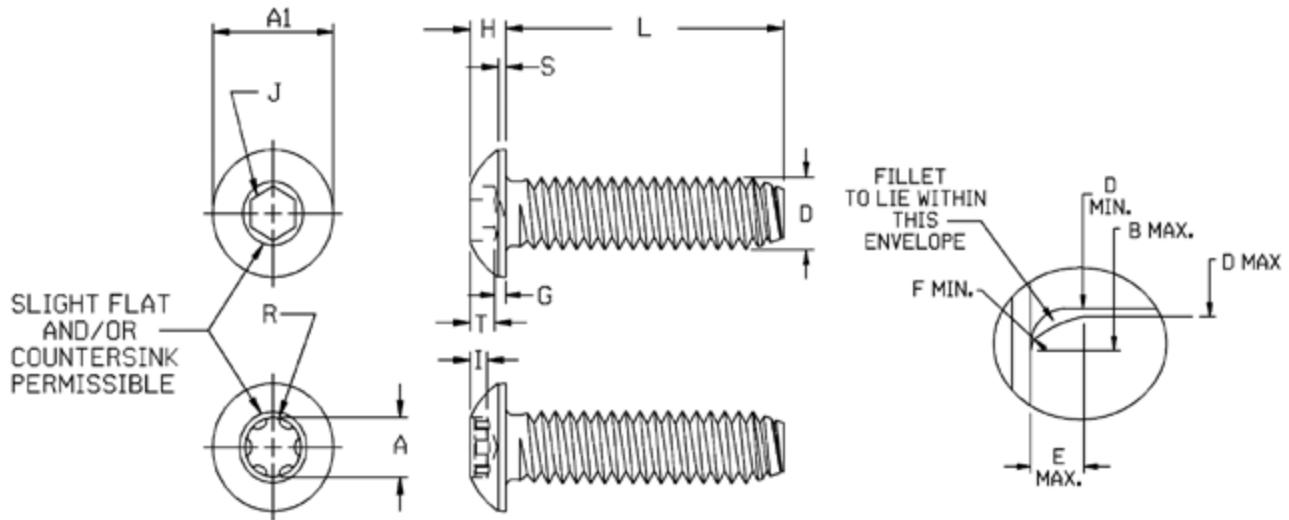

### Dimensions of Hex and TORX PLUS® Metric Button Head Cap Screws

| D<br>Nom. Size<br>x Thread<br>Pitch | A1<br>Head<br>Diameter |                        | H<br>Head<br>Diameter |      | S<br>Side<br>Height<br>Ref. | R         | A     | I    | J<br>Hex<br>Socket<br>Size<br>Nom. | T<br>Hex<br>Key<br>Eng.<br>Min. | G<br>Wall<br>Thick-<br>ness<br>Min. | B<br>Transition |                | E<br>Underhead<br>Juncture<br>Max. | F<br>Fillet<br>Std.<br>Radius<br>Min. | L<br>Max.<br>Length<br>Nom. |
|-------------------------------------|------------------------|------------------------|-----------------------|------|-----------------------------|-----------|-------|------|------------------------------------|---------------------------------|-------------------------------------|-----------------|----------------|------------------------------------|---------------------------------------|-----------------------------|
|                                     | Max.                   | Min.                   | Max.                  | Min. |                             | TORX PLUS |       |      |                                    |                                 |                                     | Dia.<br>Max.    | Length<br>Min. |                                    |                                       |                             |
|                                     | Drive<br>Size          | Recess<br>Dia.<br>Ref. | Key<br>Eng.<br>Min.   |      |                             |           |       |      |                                    |                                 |                                     |                 |                |                                    |                                       |                             |
| M3 x 0.5                            | 5.70                   | 5.40                   | 1.65                  | 1.43 | 0.38                        | 8IP       | 2.39  | 0.81 | 2                                  | 1.04                            | 0.20                                | 3.6             | 3.2            | 0.51                               | 0.10                                  | 12                          |
| M4 x 0.7                            | 7.60                   | 7.24                   | 2.20                  | 1.95 | 0.38                        | 15IP      | 3.35  | 1.14 | 2.5                                | 1.30                            | 0.30                                | 4.7             | 4.4            | 0.60                               | 0.20                                  | 20                          |
| M5 x 0.8                            | 9.50                   | 9.14                   | 2.75                  | 2.50 | 0.50                        | 25IP      | 4.52  | 1.54 | 3                                  | 1.56                            | 0.38                                | 5.7             | 5.4            | 0.60                               | 0.20                                  | 30                          |
| M6 x 1                              | 10.50                  | 10.07                  | 3.30                  | 3.00 | 0.80                        | 27IP      | 5.08  | 1.73 | 4                                  | 2.08                            | 0.74                                | 6.8             | 6.5            | 0.68                               | 0.25                                  | 30                          |
| M8 x 1.25                           | 14.00                  | 13.57                  | 4.40                  | 4.05 | 0.80                        | 40IP      | 6.76  | 2.30 | 5                                  | 2.60                            | 1.05                                | 9.2             | 8.8            | 1.02                               | 0.40                                  | 40                          |
| M10 x 1.5                           | 17.50                  | 17.07                  | 5.50                  | 5.20 | 0.80                        | 45IP      | 7.92  | 2.69 | 6                                  | 3.12                            | 1.45                                | 11.2            | 10.8           | 1.02                               | 0.40                                  | 40                          |
| M12 x 1.75                          | 21.00                  | 20.48                  | 6.60                  | 6.24 | 0.80                        | 55IP      | 11.33 | 4.02 | 8                                  | 4.16                            | 1.63                                | 14.2            | 13.2           | 1.87                               | 0.60                                  | 60                          |

### Mechanical and Application Data

| Nominal<br>Size x<br>Thread<br>Pitch | Tensile<br>Strength<br>Min. |          | Single Shear*<br>Body Section |        | Suggested<br>Seating Torque** |       |
|--------------------------------------|-----------------------------|----------|-------------------------------|--------|-------------------------------|-------|
|                                      | Kn                          | Lb       | Kn                            | Lb     | Nm                            | Lb-In |
| M3 x 0.5                             | 4.93                        | 1,108.3  | 4.9                           | 1,095  | 1.4                           | 12.5  |
| M4 x 0.7                             | 8.60                        | 1,933.4  | 8.7                           | 1,947  | 3.3                           | 29.0  |
| M5 x 0.8                             | 13.90                       | 3,124.8  | 13.5                          | 3,043  | 6.7                           | 59.0  |
| M6 x 1                               | 19.70                       | 4,428.7  | 19.5                          | 4,382  | 11.3                          | 100.0 |
| M8 x 1.25                            | 35.90                       | 8,070.6  | 34.6                          | 7,781  | 27.5                          | 244.0 |
| M10 x 1.5                            | 56.80                       | 12,769.0 | 54.1                          | 12,173 | 54.6                          | 483.0 |
| M12 x 1.75                           | 82.60                       | 18,569.0 | 78.0                          | 17,530 | 95.1                          | 842.0 |

\* Based on 100 ksi shear strength

\*\* Seating torques calculated to induce 65,000 psi tensile stress with a "K" factor of 0.21.

# Technical and Torque Data – Metric Sizes

## Camcar® Flat Countersunk Head Cap Screws

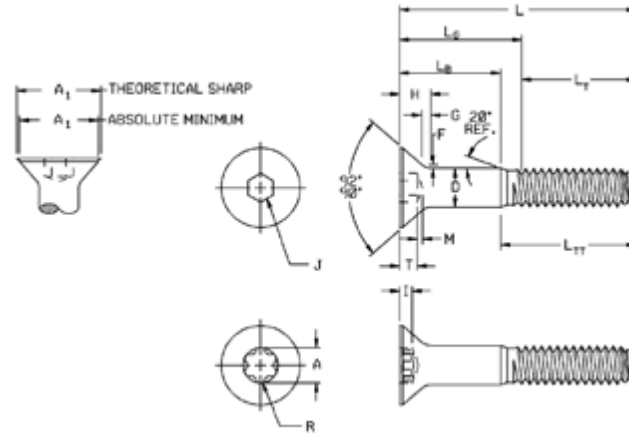

### Dimensions of Hex and TORX PLUS® Metric Flat Countersunk Head Cap Screws

| Nominal Size<br>x Thread<br>Pitch | D<br>Body Diameter |      | A1<br>Head Dia.           |                | H<br>Head Height |               | R                     | A                      | I                     | J<br>Hex<br>Socket<br>Size<br>Min. | T<br>Hex<br>Key<br>Engmt.<br>Min. | G<br>Wall<br>Thickness<br>Max. | F<br>Fillet<br>Extension<br>Above D<br>Max. | M<br>Drill<br>Allow. |
|-----------------------------------|--------------------|------|---------------------------|----------------|------------------|---------------|-----------------------|------------------------|-----------------------|------------------------------------|-----------------------------------|--------------------------------|---|----------------------|
|                                   | Max.               | Min. | Theo-<br>retical<br>Sharp | Absol.<br>Min. | Ref.             | Flush<br>Tol. | TORX PLUS             |                        |                       |                                    |                                   |                                |   |                      |
|                                   |                    |      |                           |                |                  |               | Drive<br>Size<br>Ref. | Recess<br>Dim.<br>Min. | Key<br>Engmt.<br>Nom. |                                    |                                   |                                |   |                      |
| M3 x 0.5                          | 3.00               | 2.86 | 6.72                      | 5.35           | 1.86             | 0.30          | 10IP                  | 2.82                   | 0.96                  | 2.0                                | 1.1                               | 0.25                           | 0.25  | 0.3                  |
| M3 x 0.5                          | 3.00               | 2.86 | 6.72                      | 5.35           | 1.86             | 0.30          | 10IP                  | 2.82                   | 0.96                  | 2.0                                | 1.1                               | 0.25                           | 0.25  | 0.3                  |
| M4 x 0.7                          | 4.00               | 3.82 | 8.96                      | 7.80           | 2.48             | 0.30          | 20IP                  | 3.94                   | 1.34                  | 2.5                                | 1.5                               | 0.45                           | 0.35  | 0.4                  |
| M5 x 0.8                          | 5.00               | 4.82 | 11.20                     | 9.75           | 3.10             | 0.35          | 25IP                  | 4.52                   | 1.54                  | 3.0                                | 1.9                               | 0.66                           | 0.40  | 0.5                  |
| M6 x 1                            | 6.00               | 5.82 | 13.44                     | 11.70          | 3.72             | 0.35          | 30IP                  | 5.61                   | 1.91                  | 4.0                                | 2.2                               | 0.70                           | 0.50  | 0.6                  |
| M8 x 1.25                         | 8.00               | 7.78 | 17.92                     | 15.60          | 4.96             | 0.40          | 40IP                  | 6.76                   | 2.30                  | 5.0                                | 3.0                               | 1.16                           | 0.60  | 0.8                  |
| M10 x 1.5                         | 10.00              | 9.78 | 22.40                     | 19.50          | 6.20             | 0.50          | 50IP                  | 8.94                   | 3.04                  | 6.0                                | 3.6                               | 1.62                           | 0.80  | 0.9                  |

### Mechanical and Application Data

| Nominal Size<br>x Thread<br>Pitch | Tensile Strength<br>Min. |          | Single Shear*<br>Body Section |        | Suggested Seating<br>Torque**<br>Plain Finish |         |
|-----------------------------------|--------------------------|----------|-------------------------------|--------|---|---------|
|                                   | Kn                       | Lb       | Kn                            | Lb     | Nm  | Lb-In   |
| M3 x 0.5                          | 4.93                     | 1,108.3  | 4.9                           | 1,095  | 1.7   | 15.5    |
| M4 x 0.7                          | 8.60                     | 1,933.4  | 8.7                           | 1,947  | 4.1   | 36.0    |
| M5 x 0.8                          | 13.90                    | 3,124.8  | 13.5                          | 3,043  | 8.2   | 73.0    |
| M6 x 1                            | 19.70                    | 4,428.7  | 19.5                          | 4,382  | 14.0  | 124.0   |
| M8 x 1.25                         | 35.90                    | 8,070.6  | 34.6                          | 7,791  | 34.1  | 302.0   |
| M10 x 1.5                         | 56.80                    | 12,769.0 | 54.1                          | 12,173 | 67.5  | 598.0   |
| M12 x 1.75                        | 82.60                    | 18,569.0 | 78.0                          | 17,530 | 117.0   | 1,042.0 |
| M16 x 2                           | 155.00                   | 34,845.0 | 138.0                         | 31,164 | 293.0   | 2,591.0 |
| M20 x 2.5                         | 240.00                   | 53,954.0 | 217.0                         | 48,695 | 571.0   | 5,054.0 |

\* Based on 100 ksi shear strength

\*\* Seating torques calculated to induce 65,000 psi tensile stress with a "K" factor of 0.21.

## **WARRANTY**

Infastech makes no warranty, express or implied, except that goods sold by description, sample or model shall substantially conform to the description, sample or model, and in such case, the responsibility of Infastech shall be limited to the replacement of nonconforming goods returned to Infastech within one month after delivery to Buyer (f.o.b. at point of delivery to carrier), provided that such goods have been solely used for the purpose for which manufactured. All replaced goods are to be returned to Infastech after receiving authorization from Infastech. This warranty does not apply when any physical or chemical change in the form of the product is made by the Buyer or any other party. There are no warranties which extend beyond the description stated herein. Infastech shall not otherwise be liable for any costs or expenses incurred in the replacement of any defective or nonconforming products and in no event shall Infastech be liable for incidental or consequential damages. The foregoing warranty and such other warranties made by Infastech, as are expressly stated herein, are specifically in lieu of any other warranties, express or implied, including the implied warranties of merchantability and fitness for a particular purpose.

The selection of this product for a particular application or use is the responsibility of the customer. The applications engineers at Decorah Operations are available to assist customers in selecting the appropriate product for a particular application or use. All warranties are void if the product is plated or modified in any manner by any person other than Infastech.

Infastech has strived for total accuracy throughout this catalog. However, Infastech shall not be liable or responsible for any typographical errors that may occur. If any questions arise as to the accuracy within this catalog, please contact the applications engineers at Decorah Operations.



### **Decorah Operations**

1304 Kerr Drive • Decorah, IA 52101-2494

**voice:** 563.382.4216

**fax:** 563.387.3326

[www.infastech.com](http://www.infastech.com)



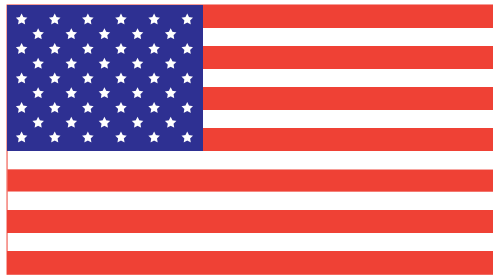

**Made in the U.S.A.**



**Decorah Operations**

1304 Kerr Drive • Decorah, IA 52101-2494

**1-800-544-6117**

[www.infastech.com](http://www.infastech.com)

